

2.4 INTERSECTION DIRECTION SIGNS AND FINGERBOARDS

2.4.1 Function and classification

Intersection direction signs or Fingerboards are required at intersections to indicate the road name or destination, or both, along intersecting legs and include the through direction if this is not clear to road users either approaching or within the intersection. At channelized intersections and roundabouts the signs are required to show the directions at the points of departure from the intersection.

Intersection direction signs of the appropriate type shall be provided as follows:

- a) At any intersection between arterial roads, sub-arterial roads or a combination of the two types - signs for all legs including confirmation of a through route where necessary.
- b) At an intersection of an arterial or sub-arterial road with a minor street or road-at least a sign naming the minor road or street, or directing traffic along it.

Intersection direction signs are classified as follows:

- a) Type 1, Major Intersection Direction signs, see Clause 2.4.2.
- b) Type 2, Minor Intersection Direction signs, see Clause 2.4.3.
- c) Type 3, Fingerboards, including rural Road Name boards, see Clause 2.4.4.
- d) Street Name and Community Facility Name signs, see Part 5 of the Manual.

2.4.2 Major Intersection Direction Signs (Type 1)-Description and use

Single end with point and chevron, G2-1

Single square end with arrow, G2-2

Double end with two points and chevrons, G2-4

Narrow format, G2-5

Examples of these signs are illustrated in Figure 2.7.



G2-1

G2-1



G2-1



(a) Sign No G2-1 (chevron ended)



G2-2



G2-5



(b) Sign No G2-2 (square end with arrow)



(c) Sign No G2-5 (narrow format)



(d) Sign No G2-4 (double chevron ended)

FIGURE 2.7 EXAMPLES OF MAJOR (TYPE 1) INTERSECTION DIRECTION SIGNS

Major Intersection Direction signs (Type 1) shall comprise a standard green background with white border, white chevron arrow, and either -

- (a) one or two (maximum) destination names in white lowercase letters; or
- (b) the above with a road name panel within the white border, comprising a white rectangular panel with the road name in black upper case; or
- (c) a black on white road name panel as above, alone on the green background.

NOTE: This may be a low-resolution file intended for on-screen viewing only. This file cannot be printed. This file may be one part of a complete technical publication, and should not be read in isolation of the other parts of the publication. A full-resolution version of all parts of the publication can be obtained from the Department of Transport and Main Roads. www.tmr.qld.gov.au The Department of Transport and Main Roads takes no responsibility for any loss or damage resulting from the use of this low-resolution file.

A route number if required shall be provided as specified in Clauses 2.4.7 and 4.4.

Distance numerals if required, see Clause 2.4.6, shall be provided as set out in Clause 2.4.7.

The signs shall be either wide or narrow format, see Clause 1.6.3. The following requirements and commendations also apply:

Wide format Where the destination indicated on the sign is approximately at right angles to the approaching traffic, the end of the sign should normally be shaped to a point with a chevron inside the point to indicate the direction, as in the G2-1 type sign. A single chevron may also be used for a sign having up to three lines of legend in a vertical stack.

Where the destination is at 45 degrees or straight ahead to approaching traffic, an arrow shall be used as in the G2-2 type sign and the end of the sign shall be square, see Figure 2.7. A square ended sign should also be used to indicate a horizontal direction when mounted with one or more signs indicating an angled or straight ahead direction.

The double-ended sign, G2-4, should be used typically at a T-junction to indicate destinations along the continuing road (i.e. the bar of the T).

Narrow format This format should be used where lateral space is restricted, e.g. at some urban intersections. It comprises a rectangular sign, (G2-5), which has an arrow (and route number) above the destination (straight ahead indications), or below the destination (horizontal and angled indications). This format should be used only when a wide format sign will not fit the available space (see Figure 3.4).

Major Intersection Direction (Type 1) signs should be used at intersections of two or more rural or urban arterial roads, or turnoffs from arterial roads to towns or other significant named traffic generators including community and tourist facilities. Signs in this category will normally be required where there are advance signs on the approach.

2.4.3 Minor Intersection Direction Signs (Type 2) - Description and use

Minor Intersection Direction sign, G3-3

Road Name Panel, G3-4

Road Name Sign, G3-5

Advance Street Name Sign, G3-8



G3-3



G3-4



G3-5



G3-8

Minor Intersection Direction signs (G3-3) shall comprise a standard single or double ended green background sign with pointed end (no border) and one or two white destination names and chevron for each direction shown, together with white distance numerals if required. If a road name is required in addition, the black and white Road Name panel, G3-4 shall be mounted on top of the G3-3 sign. A route number may be placed on the sign in accordance with Clauses 2.4.7 and 4.4. The route number should not be placed on the G3-4 sign.

If a road name only, is required, either a Street Name sign in the G5 Series on urban roads, see Part 5 of this Manual or a Road Name sign, G3-5, comprising a black legend and chevron on a white background for rural roads, shall be provided. The G3-8 sign may be used in rural areas at the beginning of a turn lane provided for the streets signed with a Road Name sign, G3-5.

Minor Intersection Direction (Type 2) signs should be used on rural arterial roads at all minor turnoffs to named destinations, i.e. wherever a Type 1 sign is not warranted, and on urban arterial roads at intersections with sub-arterial roads which lead to named destinations. Signs placed to face traffic entering the arterial road from the minor road to indicate directions along the arterial road should also be Type 2 signs.

NOTE: This may be a low-resolution file intended for on-screen viewing only. This file cannot be printed. This file may be one part of a complete technical publication, and should not be read in isolation of the other parts of the publication. A full-resolution version of all parts of the publication can be obtained from the Department of Transport and Main Roads. www.tmr.qld.gov.au The Department of Transport and Main Roads takes no responsibility for any loss or damage resulting from the use of this low-resolution file.

2.4.4 Fingerboards (Type 3 Intersection Direction signs)-Description and use

Fingerboard, G3-6

Route Number panel, G3-7



G3-6



G3-7

A Fingerboard (G3-6) shall comprise a single or double ended sign with point and chevron at one or both ends and one destination name only associated with each point. The destination name and distance numerals shall be white upper case on a standard green background. If a route number is required it shall either be placed on the sign as specified in Clauses 2.4.7 and 4.4 or placed on a Route Number panel (G3-7) mounted above or below the sign if the sign board would otherwise be too long.

If a road name is to be shown by itself or in conjunction with a Fingerboard, a Street Name sign in the G5 Series, see Part 5 of this Manual, shall be used. In rural areas black legend on white background should be used to distinguish the sign from the G3-6 Fingerboard signs.

Fingerboards are appropriate for use on low speed or low volume, generally non-arterial roads in rural areas and on sub-arterial or low speed arterial roads in urban areas where the need for prominence in a complex visual urban environment is not an issue.

2.4.5 Signs to tourist attractions

Intersection direction signs and Fingerboards directing to major tourist attractions as described in Part 6 of this Manual shall be designed as specified above except that the sign backgrounds shall be brown.

2.4.6 Legend selection

The number of names on an Intersection Direction sign or group of Fingerboards pointing in any one direction shall not exceed two destination names plus one road name.

Where Advance Direction signs are used, the names shown on Intersection Direction signs shall be the same as those used on the Advance Direction sign including directions to a distant route used to supplement or in place of a focal point. If there are no Advance Direction signs, the choice of names should follow the principles given in Clause 2.2.3.

Distance numerals shall be shown on all Intersection Direction signs in rural areas and on Fingerboards showing destinations except where Reassurance Direction signs (see Clause 2.5) are erected beyond the intersection. This exception will usually only apply in respect of Type 1 signs. Distances should be shown as set out in Clause 1.6.4. Distance numerals are placed on signs as specified in Clause 2.4.7.

Recommended minimum letter sizes are given in Table 1.1.

2.4.7 Display of route numbers and distances

Where either route numbers or distance numerals or a combination of the two are to be shown on Type 1 wide format, Type 2 or Type 3 Intersection Direction signs they shall be displayed as set out below.

NOTE: The following drawings show in outline, the relationship between the destination, distance numeral and route number elements on Intersection Direction signs. They are applicable to all three Categories. Internal road name panels on Type 1 signs are superimposed above these elements.

- (a) Distance numerals only on a single or double ended board - between the point/chevron/arrow and the destination name.



- (b) Route number only on a single ended board-between point/chevron/arrow and the destination name.



- (c) Route number only on a double ended board -
 - (i) same number each direction-between the destination name; or
 - (ii) different number each direction-as for Item (b).

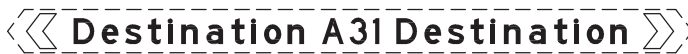

- (d) Route number and distance numerals on a single ended board - one number between point/chevron/arrow and destination name, and the other at the opposite end.



Route number and distance numerals on a double ended sign - distance numerals at point/chevron/arrow ends, route number between names.

NOTE: If the route number is different for each direction, the option of showing them on supplementary plates above or below the sign should be considered.

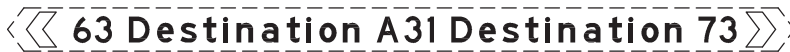

Route number and distance numerals both required on a double ended sign but route number different for each direction-the option of -

- (i) separate signs as shown in Item (d) for each direction; or
- (ii) for Type 3 Fingerboards only, a double ended sign as shown in Item (a) with Route Number panels, G3-7, as shown in Clause 2.4.4.

4.8 Location

In addition to the general principles set out in Appendix B, the following requirements and recommendations apply. Intersection Direction signs and Fingerboards should be located within or near the intersection at the site where they are readily visible to approaching drivers. Treatments will depend on roadside development, other signs in the area, visibility, the background, and the need to avoid restricting intersection sight distance. They shall be located to show the precise point at which a turn must be made and should highlight the point of conflict with intersecting or entering traffic, especially when the intersecting pavement is not visible.

At simple cross or T-intersections they may be erected in an assembly typically comprising double ended signs for the through legs and single ended signs for the terminating leg, see Figure 2.10. Signs pointing along a side road or street should always be placed above through road signs in such assemblies. At complex channelized intersections and roundabouts the signs shall be located so that the route to be taken through and out of the intersection is clearly defined. At roundabouts the signs are required at each exit point from the circulating roadway.

Consideration may also be given to providing Type 3 Road Name signs at the beginning of turning lanes to minor side streets from urban arterial roads.

NOTE: This may be a low-resolution file intended for on-screen viewing only. This file cannot be printed. This file may be one part of a complete technical publication, and should not be read in isolation of the other parts of the publication. A full-resolution version of all parts of the publication can be obtained from the Department of Transport and Main Roads. www.tmr.qld.gov.au The Department of Transport and Main Roads does not accept any liability for any loss or damage resulting from the use of this low-resolution file.

2.5 REASSURANCE DIRECTION SIGNS

Reassurance Direction sign, G4-1

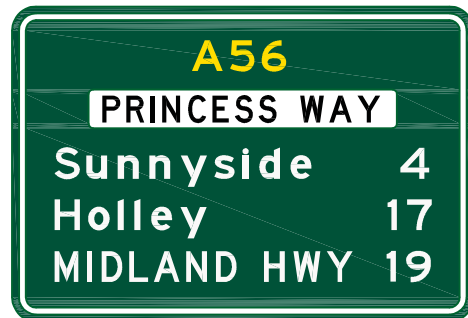

2.5.1 Function

Reassurance Direction signs may be used to reassure motorists that they are travelling towards their intended destination and to indicate the distances to the destinations nominated as follows:

- Beyond major intersections, i.e. intersections warranting use of Advance and Type 1 Intersection Direction signs.
- On the outskirts of major towns facing traffic leaving the town.
- At the start of named routes.

2.5.2 Legend

The legend should not exceed five destinations, or the route name and four destinations. Legends shall include the appropriate destinations shown on the advance direction and intersection direction signs.

If the route is numbered, the number shall head the legend.

If the route is named, the name shall be shown above the destination list. The route number may be placed beside the route name or centrally above it.

Town (or suburb) names included are selected in accordance with the following:

- The next principal name place for the route shall be given.
- Subsidiary towns shown on prior direction signs shall be listed.
- Other destinations which should be considered are small towns which have tourist, historic, or geographic interest, or lie at the junction of a subsidiary route.
- If the road joins another route, town names on both routes may be included provided that they comply with Items (a), (b) or (c).
- On roads leading to capital cities, the name of the capital and its distance may be included as the last destination. If this principle is adopted, it shall apply to every reassurance sign on that route beyond the first on which it has been introduced.

The names should appear in the order of their distance from the intersection, with the shortest distance on the top of the sign.

The distance shown should be the distance from the sign to the recognized centre of each destination. Distances shall be given to the nearest whole kilometre.

If a destination named on the sign is on a road branching from the through route some distance beyond the sign, brackets should be placed around the line of legend containing the destination name and its distance. Brackets should not be used for destinations on a route where the route name has changed but is effectively a continuing route.

Recommended minimum letter types and sizes are given in Table 1.1 for non-expressway signs and in Table 1.2 for signs on expressway type roads.

2.5.3 Location

Signs should be located on the left side of the road 150 to 200 m urban and approximately 400 m rural, beyond the intersection, or at the town limits or at any other suitable location where such signs are considered desirable. The requirements of Appendix B also apply.

2.5.4 Aus-Link logo

The use of the Aus-Link logo shall be confined to reassurance direction signs in the G4 and GE4 series. If used, the logo shall be no greater in height than the route number. It may be located near the route number but not so close as to visually corrupt it.

These requirements shall also apply to any subsequent replacement for the Aus-link logo associated with the Federal funding of roads identified as National highways.

2.6 TYPICAL ARRANGEMENT DIAGRAMS

Typical locations of direction signs at various intersection types are illustrated in Figures 2.8 to 2.14.

NOTE: This may be a low-resolution file intended for on-screen viewing only. This file cannot be printed.
 This file may be one part of a complete technical publication, and should not be read in isolation of the other parts of the publication.
 A full-resolution version of all parts of the publication can be obtained from the Department of Transport and Main Roads. www.tmr.qld.gov.au
 The Department of Transport and Main Roads takes no responsibility for any loss or damage resulting from the use of this low-resolution file.

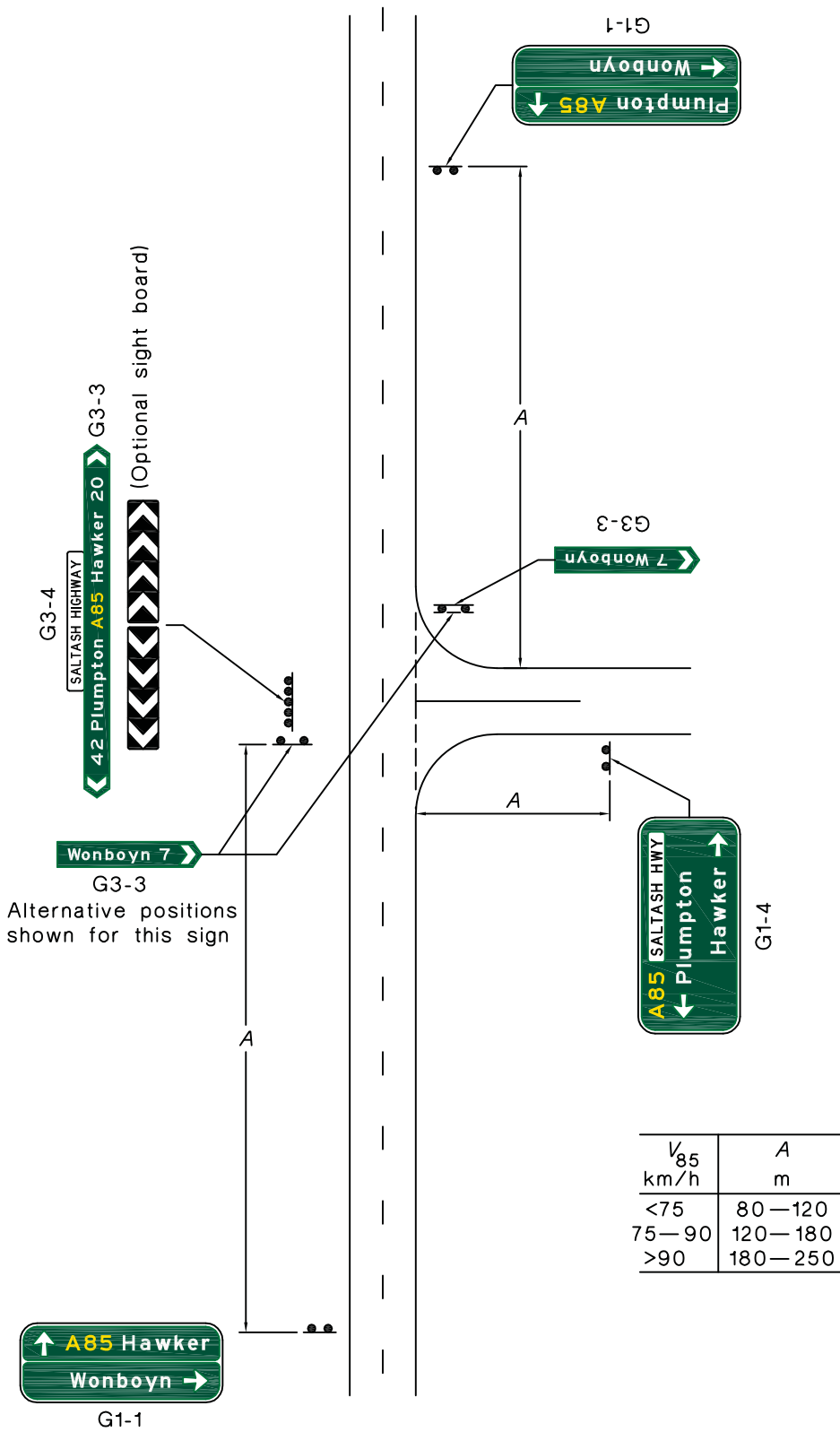

NOTES:

- 1 Guides for the use of Type 2 Intersection Direction signs are given in Clause 2.4.3.
- 2 Advance direction signs (i.e. G1-1 and G1-4) are optional in this case.

FIGURE 2.9 MINOR RURAL INTERSECTION - USING TYPE 2 INTERSECTION DIRECTION SIGNS

NOTE: This may be a low-resolution file intended for on-screen viewing only. This file cannot be printed. This file may be one part of a complete technical publication, and should not be read in isolation of the other parts of the publication. A full-resolution version of all parts of the publication can be obtained from the Department of Transport and Main Roads. www.tmr.qld.gov.au The Department of Transport and Main Roads takes no responsibility for any loss or damage resulting from the use of this low-resolution file.

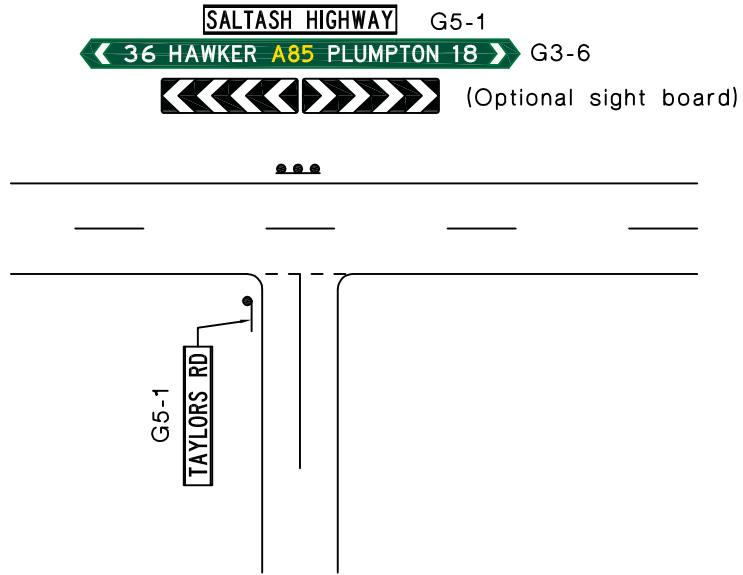

(a) Using T-junction sight board assembly

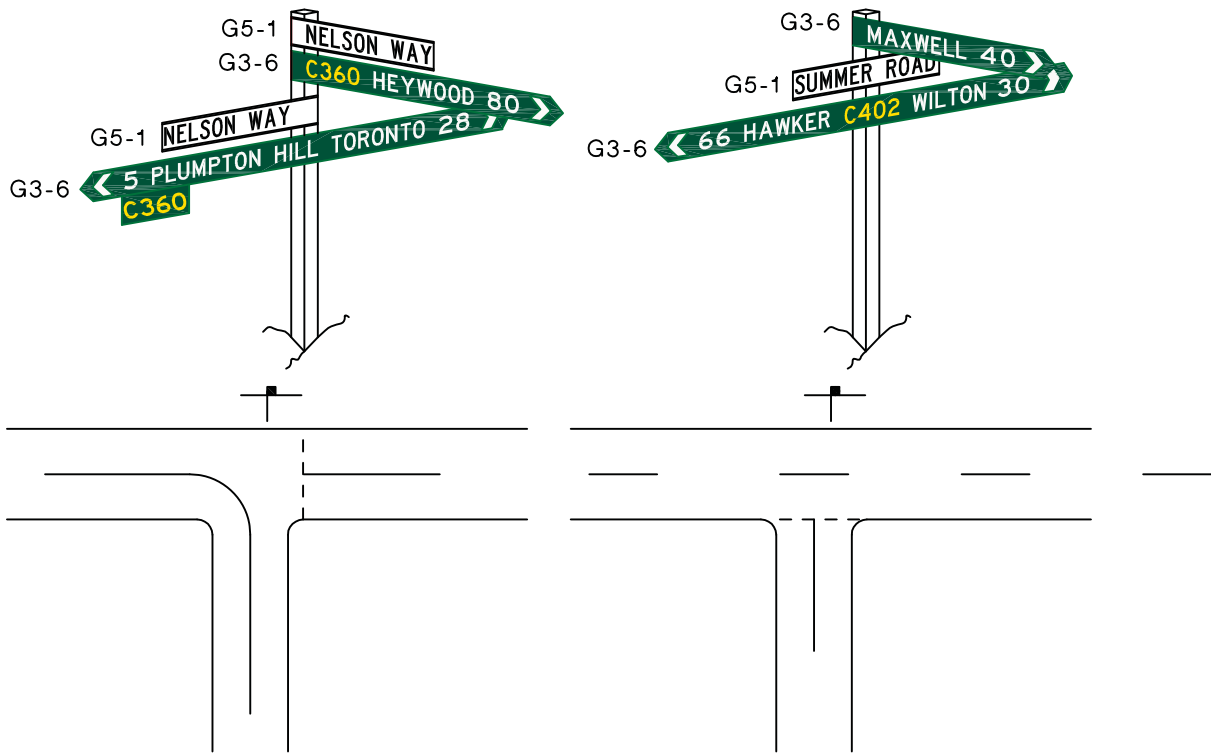

(b) Using fingerboard groups only

(a) Using T-junction sight board assembly

(b) Using fingerboard groups only

NOTE: Guides for the use of Type 3 Intersection Direction signs (Fingerboards) are given in Clause 2.4.4.

FIGURE 2.10 MINOR RURAL INTERSECTION - USING TYPE 3 FINGERBOARDS

NOTE: This may be a low-resolution file intended for on-screen viewing only. This file cannot be printed.
 This file may be one part of a complete technical publication, and should not be read in isolation of the other parts of the publication.
 A full-resolution version of all parts of the publication can be obtained from the Department of Transport and Main Roads. www.tmr.qld.gov.au
 The Department of Transport and Main Roads takes no responsibility for any loss or damage resulting from the use of this low-resolution file.

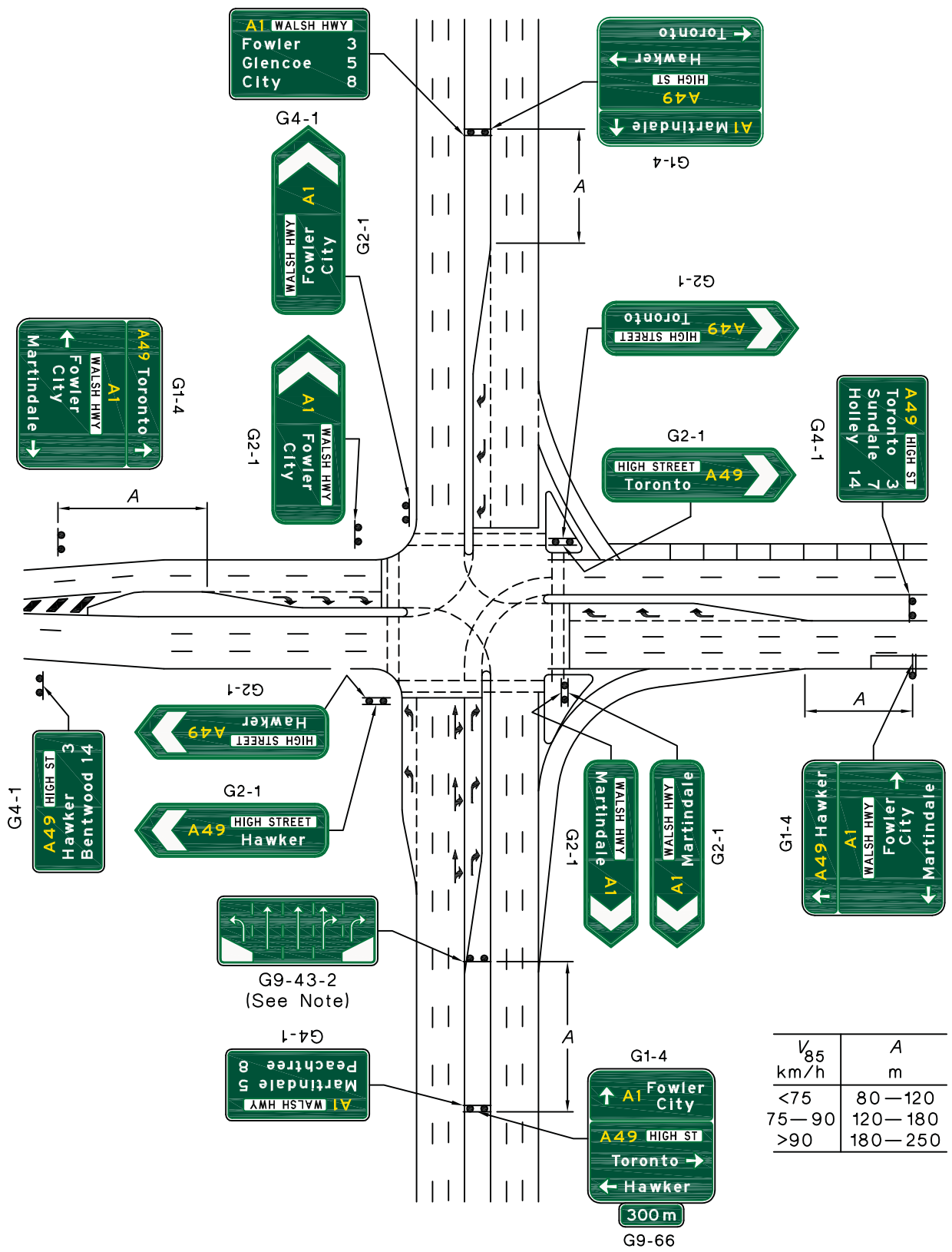

NOTE: The G9-43 sign will be required where there is an unusual lane allocation such as a trap lane or a layout of the type illustrated: The sign may need to be placed further in advance of the start of the turning lane depending on the degree of advance notice needed by drivers.

FIGURE 2.12 MAJOR URBAN INTERSECTION - DIVIDED ROAD

NOTE: This may be a low-resolution file intended for on-screen viewing only. This file cannot be printed. This file may be one part of a complete technical publication, and should not be read in isolation of the other parts of the publication. A full-resolution version of all parts of the publication can be obtained from the Department of Transport and Main Roads. www.tmr.qld.gov.au The Department of Transport and Main Roads takes no responsibility for any loss or damage resulting from the use of this low-resolution file.

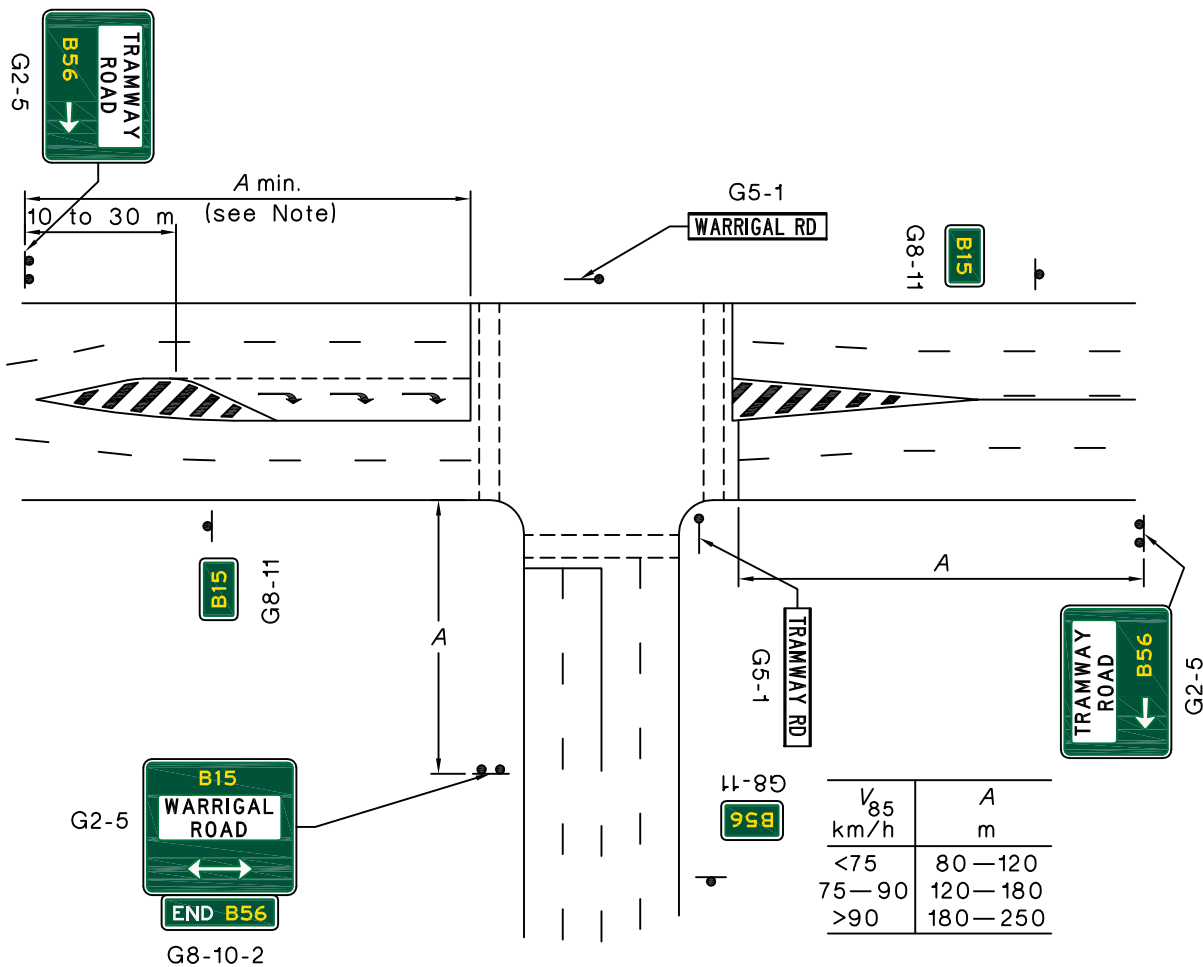

(a) Two sub-arterial roads

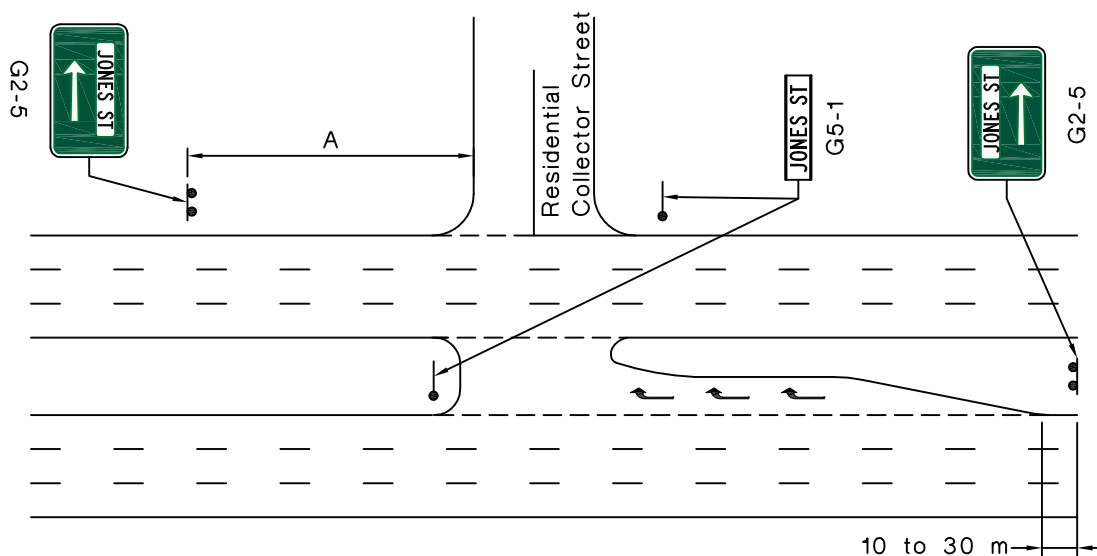

(b) Arterial road and collector street

(a) Two sub-arterial roads

(b) Arterial road and collector street

NOTE: Distance A will apply if it will place the sign more than 30 m from the start of the right turn taper.

FIGURE 2.13 MINOR URBAN INTERSECTIONS