

Gooding Drive Roundabout Upgrade (Nerang – Broadbeach Road) PROJECT UPDATE

October 2017

About the project

The Queensland Government is investing \$6.7 million to upgrade the Gooding Drive roundabout at Nerang – Broadbeach Road.

Contractor, CMC, is completing the upgrade to improve both the Gooding Drive roundabout and Palm Meadows Drive intersection.

Project Update

The contractor is in peak construction, progressing works at the Gooding Drive roundabout and Palm Meadows Drive.

- A 40km/h speed limit reduction is in place on the roundabout and approaches while construction activity is taking place. Please remember, speed limits and roadwork signage are in place for your safety and are enforceable.
- On-road cycle lanes on Nerang-Broadbeach Road located near the exit and approach to the Gooding Drive roundabout are closed during construction and will re-open in late 2017.
- The signalisation of the Palm Meadows Drive intersection will commence soon.

Night Works

The project team will continue intermittent night works in October from Sunday to Thursday nights between 7pm and 5am.

Works have been scheduled at night when traffic volumes are lower.

Night works activities during October will include:

- Piling works that will generate noise, required to construct new guardrail and gantry foundations (see map attached).
- Removal and installation of signage and barriers, roadside excavation, lane adjustments, realignment of traffic, line marking, surveying, pavement construction and electrical works at Palm Meadows Drive intersection.
- Concrete barrier and kerb works.
- Pavement profiling and asphalt paving works.

What to expect:

- The use of sizeable plant, machinery and vehicles that generate noise and vibration.
- Temporary lighting towers and reflective traffic control devices.
- Changes to pedestrian and cyclist paths may be required at times. Please follow directional signage and traffic control.
- Reduced speed limits and increased congestion through the work zones.
- Drive to conditions, allow extra travel time and choose alternative routes, if possible.
- The project team will endeavour to program the noisiest activity as early in the nightshifts as possible.

The project team is committed to keeping the local residential community and motorists informed about works.

We appreciate your patience during this time. If you have any queries or concerns, please do not hesitate to contact our team (see overleaf for contact details).

Refer map over page.

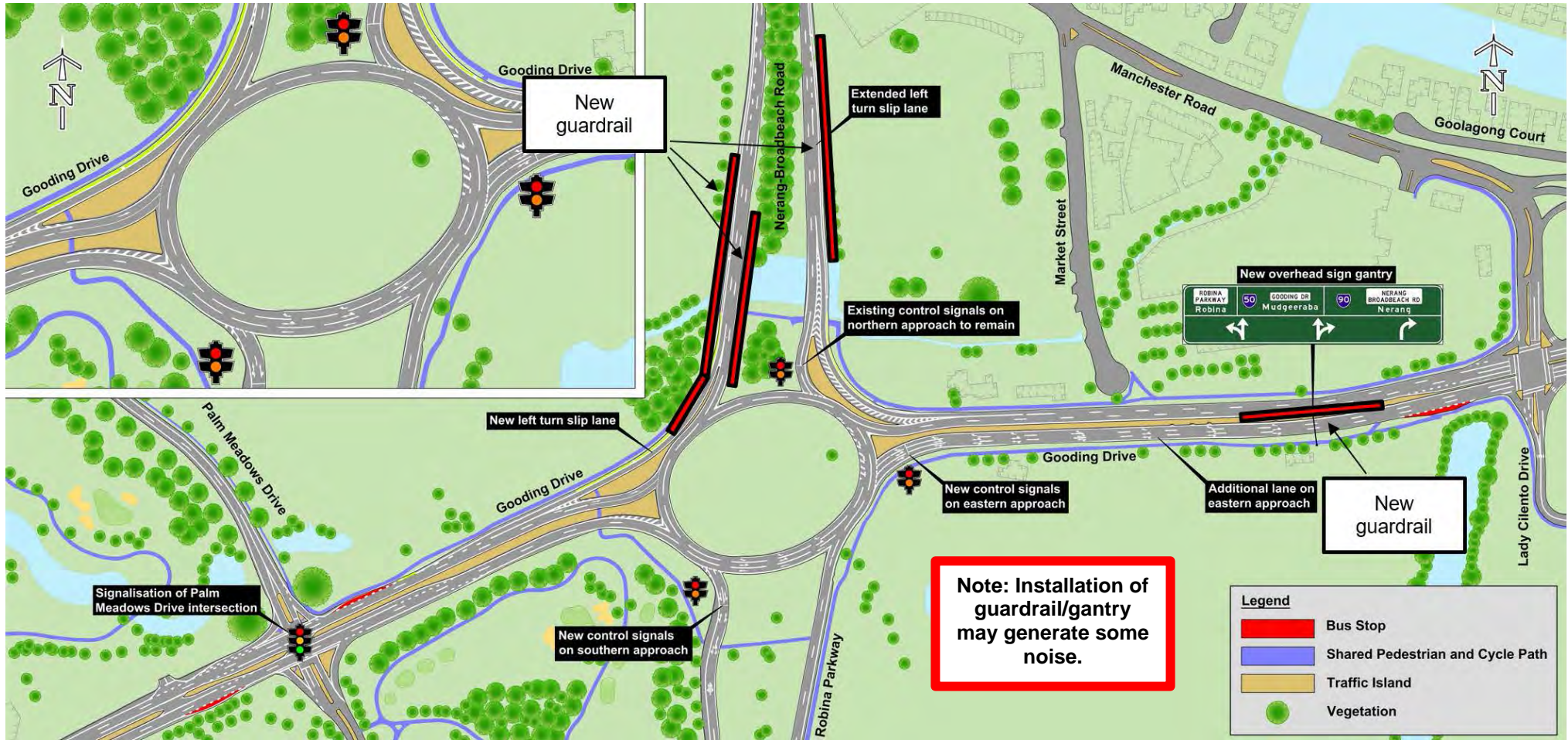

Keeping informed

To keep up-to-date and subscribe to the free SMS or email traffic alert services. For more information:

Phone: 1300 187 037*
 Email: GoodingDrive@tmr.qld.gov.au
 Web: www.tmr.qld.gov.au/projects

* Check with your service provider for call costs