

# Ipswich Motorway Upgrade: Rocklea to Darra – Stage 1 project

June 2019

## Temporary closure of Ipswich Motorway westbound entry ramp near Randolph Street, Rocklea.

The Department of Transport and Main Roads (TMR) advise the following changes for the Ipswich Motorway entry ramp near Randolph Street and for the southern Ipswich Road service road.

- Preparatory night works **Sunday 16 June to Saturday 22 June 8pm to 5am**
- Temporary closure of Randolph Street entry ramp **Saturday 22 June to Sunday 4 August**
- Reopening of Randolph Street entry ramp on temporary alignment **Monday 5 August 2019.**
- Temporary lane closure on the southern Ipswich Road service road from Randolph Street to Boundary Road – the service road will be **one-way only (westbound) Saturday 22 June to mid-2020.**

### Who do these works affect?

These changes will temporarily affect traffic entering the motorway from Randolph Street (towards Ipswich), as well as traffic and businesses along the southern Ipswich Road service road between Randolph Street and Boundary Road. Access to local businesses and roads will be maintained.

Traffic wanting to access the motorway to travel towards Ipswich can do so via the Boundary Road entry ramp (**see map attached**).

The section of the southern Ipswich Road service road will remain one-way ONLY until mid-2020.

### Why are these works required?

The closure of the entry ramp is necessary to enable the permanent upgrade road works to occur. The upgraded entry ramp will provide safer access and easier merging onto the motorway.

Construction work at the Randolph Street entry ramp will occur mostly during the day. The work will be noisy and dusty as excavators and jack hammers remove old concrete and asphalt from the roadway. Water trucks will be used to control dust. Increased truck movements in the area will also occur. The project team will try to complete the work as quickly as possible to minimise these impacts.

Traffic control and signage will be in place to direct and safeguard road users and workers. We apologise for the inconvenience and ask for your patience and safety through roadworks.

If you would like further information about the project, please visit [www.tmr.qld.gov.au/rocklea2darra1](http://www.tmr.qld.gov.au/rocklea2darra1), email [contactus@r2d1.com.au](mailto:contactus@r2d1.com.au) or call 1800 204 990.

Thank you for your cooperation,

The Project Team



Australian Government

**BUILDING OUR FUTURE**



Queensland Government

Map showing temporary closure of the existing Ipswich Motorway westbound entry ramp near Randolph Street, Rocklea + access.

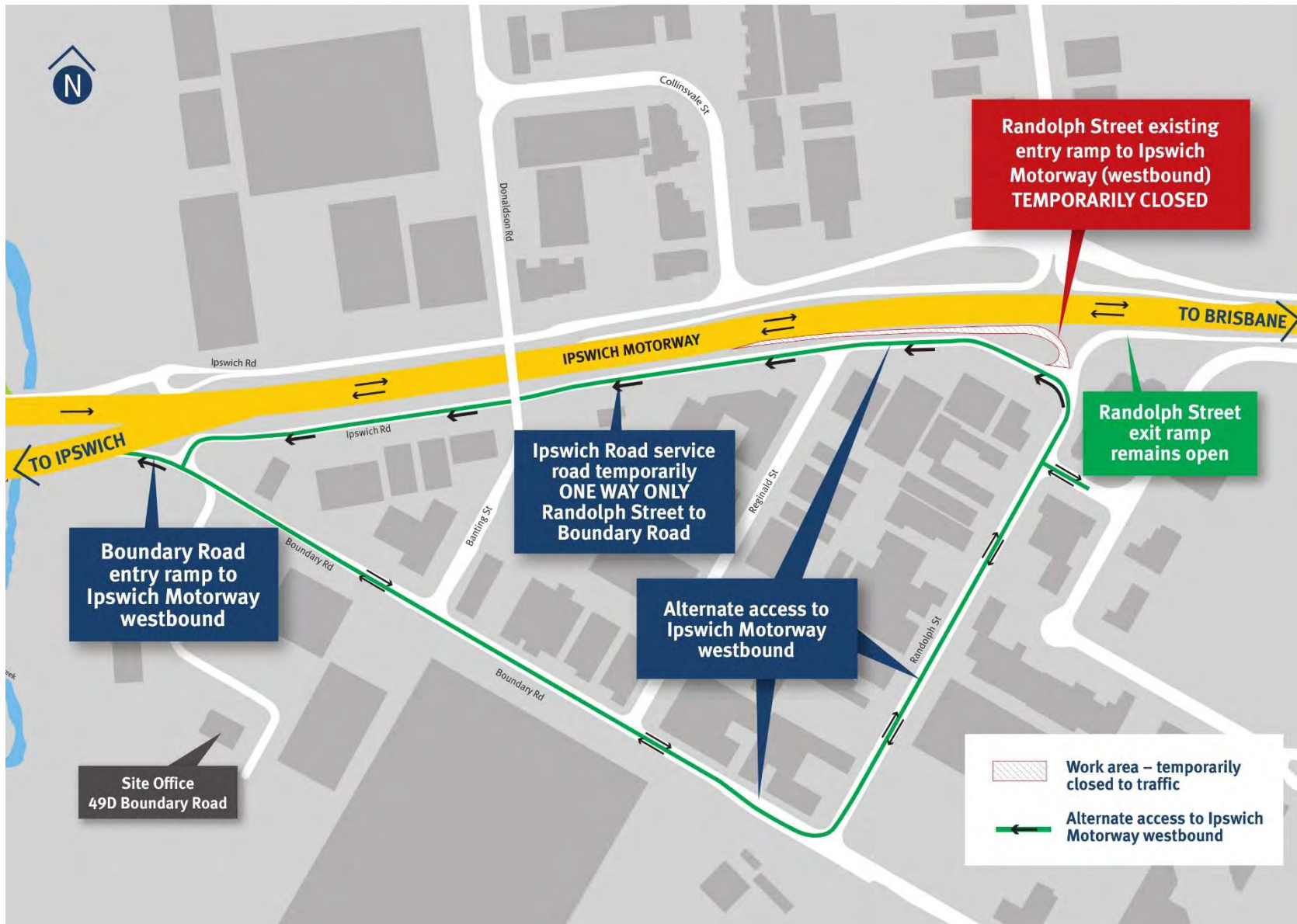

- Temporary closure of Randolph Street entry ramp to Ipswich Motorway (westbound) **Saturday 22 June to Sunday 4 August**

- Reopening of Randolph Street entry ramp on temporary alignment **Monday 5 August 2019**.

- Temporary lane closure on the southern Ipswich Road service road from Randolph Street to Boundary Road - **one-way only (westbound) Saturday 22 June to mid-2020**.

**NOTE: Works may be rescheduled to the next available opportunity if impacted by weather or construction conditions.**