

North Brisbane Bikeway, Stage 3A - Albion Road to Grove Street

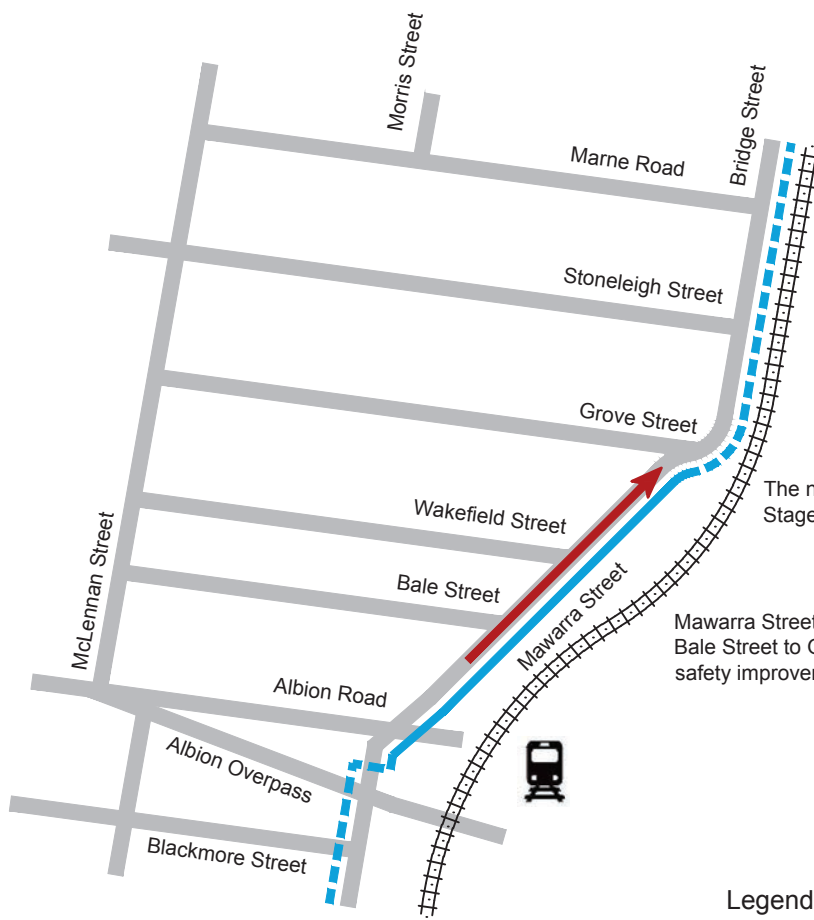

The northern end will connect to Stage 3B of the North Brisbane Bikeway.

Mawarra Street will be one-way from just south of Bale Street to Grove Street to complement the safety improvements on Bridge Street.

The southern end will connect to Stage 2 of the North Brisbane Bikeway.

Legend

- North Brisbane Bikeway - Stage 3A
- - - North Brisbane Bikeway - Stages 2 & 3B
- Proposed one-way section

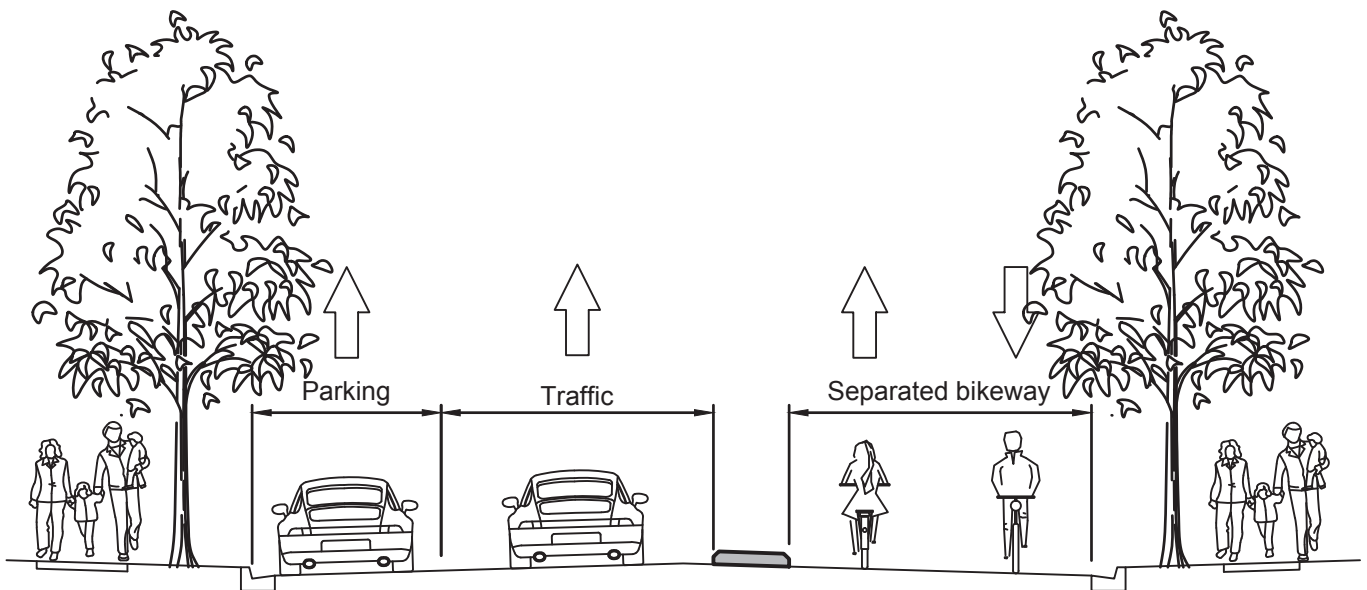

Mawarra Street Typical Cross Section