

# FRASER COAST REGIONAL COUNCIL

## BOORAL ROAD 1632

### CH. 4.640km - 4.950km

## WOODS ROAD INTERSECTION UPGRADE

The works shown on this drawing are a factual representation of the works constructed.

Signature: **NR** Date: **26/02/2020**  
 Name: **Gakul Gurung (RPEQ 18777)**  
 Title: **Engineer (Civil)**



### DRAWING INDEX

DRAWING NUMBER	REVISION	DESCRIPTION
824422	B	LOCALITY PLAN AND DRAWING INDEX
824423	B	CONTROL LINE SETOUT
824424	B	ROAD TYPICAL SECTIONS AND DETAILS
824425	B	PAVEMENT DETAILS
824426	B	TURNOUT GENERAL ARRANGEMENT AND SETOUT
824427	B	SIGNS AND PAVEMENT MARKING LAYOUT
824428	B	ANNOTATED ROAD CROSS SECTIONS MCOO SHEET 1 OF 6
824429	B	ANNOTATED ROAD CROSS SECTIONS MCOO SHEET 2 OF 6
824430	B	ANNOTATED ROAD CROSS SECTIONS MCOO SHEET 3 OF 6
824431	B	ANNOTATED ROAD CROSS SECTIONS MCOO SHEET 4 OF 6
824432	B	ANNOTATED ROAD CROSS SECTIONS MCOO SHEET 5 OF 6
824433	B	ANNOTATED ROAD CROSS SECTIONS MCOO SHEET 6 OF 6

TOTAL NUMBER OF DRAWINGS = 12

**JOB SITE**  
 228/1632/1075873  
 CHGE: 4.640-4.950km

**SCHEME SUBMITTED** (External Consultants or Internal Business Unit):  
 This design meets the requirements of all relevant Australian Standards, Austroads Guidelines and Transport and Main Roads – Policies, References, Standards, Planning and Design Instructions, Guidelines and the requirements of the project brief/functional specifications.

SIGNED: MARK MORRIS TITLE: PRINCIPAL DESIGNER  
 Organisation: TRANSPORT AND MAIN ROADS DATE: 05/11/2019

**SCHEME SCOPE AND FINANCIAL APPROVAL:** (Regional Director or Delegate):  
 I hereby certify that this scheme complies with the intent of the scope and financial limits of the relevant project on QTRIP and the scheme is approved for release in accordance with that program.

SIGNED: HENDRIK ROUX TITLE: DISTRICT DIRECTOR WEBB DATE: 06/11/2019

G F E D C B A Revisions/Descriptions Certification Date Microfiled	<b>NR</b> 25/2/2020	Associated Job Nos Survey Data Datum GDA 94 Auxiliary Drg Nos Horiz. Grid MGA 94, Z56 Height Origin AHD DERIVED Survey Books 228109	Scales NTS Dimensions shown in metres except where shown otherwise	<b>FRASER COAST REGIONAL COUNCIL</b> <b>BOORAL ROAD (1632)</b> <b>CTL CHGE 4640 - 4950</b> Reference Points <table border="1" style="width: 100%; border-collapse: collapse;"> <thead> <tr> <th>Preceding RP</th> <th>Dist. to start of job (km)</th> <th>From start to end of job</th> <th>From end to Following RP</th> </tr> </thead> <tbody> <tr> <td>1A</td> <td>4.64</td> <td>.31</td> <td>4.969</td> </tr> </tbody> </table> Through Changeage from INT 163/162/164, 4.64 - 4.95km	Preceding RP	Dist. to start of job (km)	From start to end of job	From end to Following RP	1A	4.64	.31	4.969	<b>LOCALITY PLAN AND DRAWING INDEX</b> Drawn D. Riemer Designed D. Riemer	ENGINEERING CERTIFICATION (RPEQ) <table border="1" style="width: 100%; border-collapse: collapse;"> <thead> <tr> <th>ENC. AREA</th> <th>NAME</th> <th>SIGNATURE</th> <th>NO.</th> <th>DATE</th> </tr> </thead> <tbody> <tr> <td>CIVIL</td> <td>Vince Green</td> <td>Vince Green</td> <td>10577</td> <td>05/11/19</td> </tr> </tbody> </table>	ENC. AREA	NAME	SIGNATURE	NO.	DATE	CIVIL	Vince Green	Vince Green	10577	05/11/19	 <b>Queensland Government</b> Job No. 228/1632/1075873 Contract No. CN-13066 Drawing No. 824422 B Series Number 01 of 12 MRR_Detail (02/14)
Preceding RP	Dist. to start of job (km)	From start to end of job	From end to Following RP																						
1A	4.64	.31	4.969																						
ENC. AREA	NAME	SIGNATURE	NO.	DATE																					
CIVIL	Vince Green	Vince Green	10577	05/11/19																					

Last Modified: Fri, Feb 25, 2020 12:34pm XREFS: 1.

The works shown on this drawing are a factual representation of the works constructed.

Signature **NR** Date **26/12/2020**  
 Name **Gakul Gurung (RPEQ 18777)**  
 Title **Engineer (Civil)**

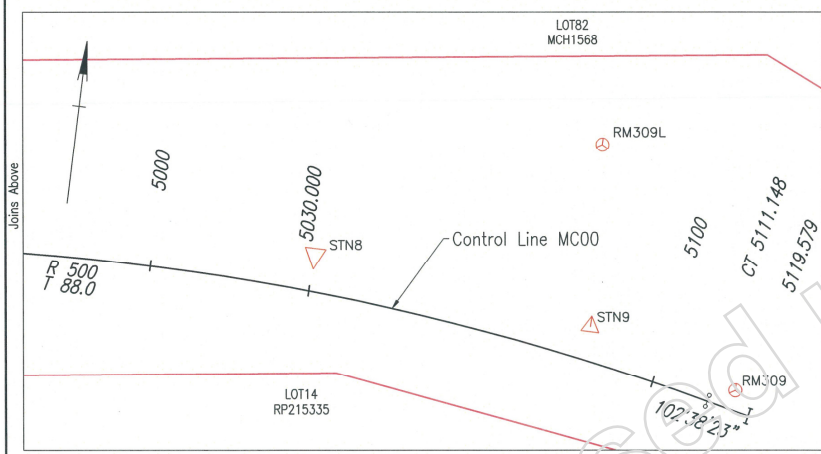
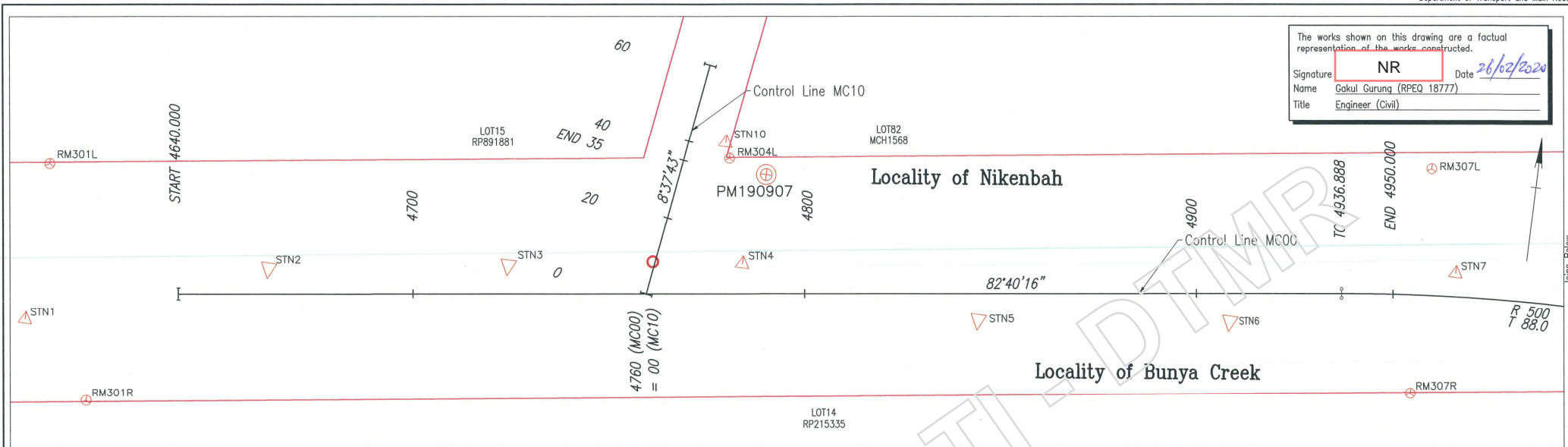

PT	CHAINAGE	EASTING	NORTHING	BEARING
START	4640.000	481102.998	7197267.459	82°40'15.69"
TC	4936.888	481397.461	7197305.331	82°40'15.69"
END	4950.000	481410.484	7197306.820	
R500		481484.764	7197316.560	
CT	5111.148	481570.654	7197297.299	102°38'23.05"
IP 3	5119.579	481578.880	7197295.454	102°38'23.05"

PT	CHAINAGE	EASTING	NORTHING	BEARING
START	0.000	481221.569	7197282.709	8°37'43.21"
END	35.000	481226.820	7197317.317	8°37'43.21"
IP 2	60.005	481230.571	7197342.034	8°37'43.21"

Name	Easting	Northing	Height	Combined Scale Factor	Comment
PM190907	481248.074	7197316.379	7.146	0.99959591	PM190907 - STAR PICKET

Name	Easting	Northing	Combined Scale Factor
STN1	481065.118	7197256.100	0.99959594
STN2	481124.984	7197276.677	0.99959593
STN3	481185.631	7197285.199	0.99959593
STN4	481244.890	7197293.291	0.99959589
STN5	481306.400	7197286.636	0.99959586
STN6	481370.138	7197294.425	0.99959582
STN7	481425.680	7197314.027	0.99959564
STN8	481491.689	7197315.321	0.99959539
STN9	481546.477	7197308.659	0.99959545
STN10	481236.840	7197323.043	0.99959594

Name	Easting	Northing	Combined Scale Factor
RM301R	481083.114	7197237.643	0.99959595
RM301L	481066.445	7197295.949	0.99959600
RM304L	481238.262	7197319.269	0.99959594
RM307L	481416.322	7197339.434	0.99959581
RM307R	481417.982	7197282.356	0.99959563
RM309L	481544.423	7197343.662	0.99959575
RM309R	481575.807	7197300.007	0.99959545

Last Modified: Fri, 25, 2020 - 12:24pm XREFS: - XS500.dwg

G F E D C B A As Constructed Issued For Construction	Associated Job Nos Survey Data Datum GDA 94 Horiz. Grid MGA 94, Z56 Height Origin AHD DERIVED Survey Books 228109	Scales 0 5 10 15 20m	FRASER COAST REGIONAL COUNCIL BOORAL ROAD (1632) CTL CHGE 4640 - 4950		CONTROL LINE SETOUT		Job No. 228/1632/1075873 Contract No. CN-13066 Drawing No. 824423 B Series Number 02 of 12 MRR_Detail (02/14)
			Reference Points Preceding RP Dist. to start of job (km) From start to end of job From end to Following RP 1A 4.64 .31 4.969 2 Through Chainage from INT 163/1632/164, 4.64 - 4.95km		ENGINEERING CERTIFICATION (RPEQ) Drawn D. Riemer Designed D. Riemer ENG. AREA NAME SIGNATURE NO. DATE CIVIL Vince Green Vince Green 10577 05/11/19		



**TRAFFIC DATA**

AADT (2018)	= 5737 VPD
Lane AADT (2018)	= 2800 VPD
% Heavy Vehicles	= 5.8%
Growth	= 5.3%

The works shown on this drawing are a factual representation of the works constructed.

Signature: **NR** Date: **26/02/2020**  
 Name: **Gakul Gurung (RPEQ 18777)**  
 Title: **Engineer (Civil)**

**# Road Surfacing**

- Primer Seal (C170, 2% cutter) - 0.9 L/m<sup>2</sup> [Widening Only] - 10 mm @ 150 m<sup>2</sup>/m<sup>3</sup>
- Seal (S35E) - 1.9 L/m<sup>2</sup> [Full Width] - 14 mm @ 100 m<sup>2</sup>/m<sup>3</sup>
- Scatter Coat [Intersection] - 7 mm @ 450 m<sup>2</sup>/m<sup>3</sup>

Seal design to be confirmed by Administrator prior to sealing

Information shown on Type Cross Sections is nominal only. Refer Setting Out Drawings & Annotated Cross Sections for variations.

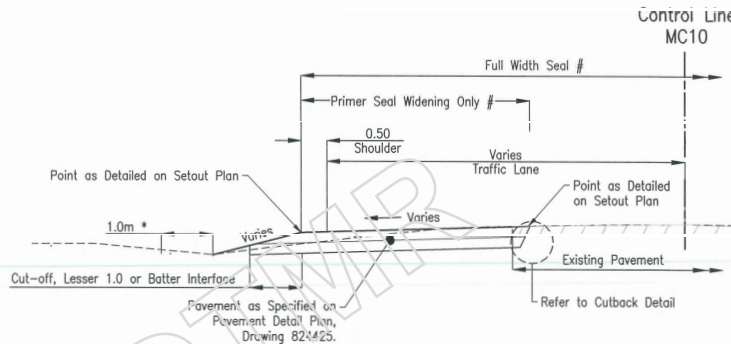

**TYPE C - WIDENING - KERB RETURN**  
(MC10) LHS & RHS

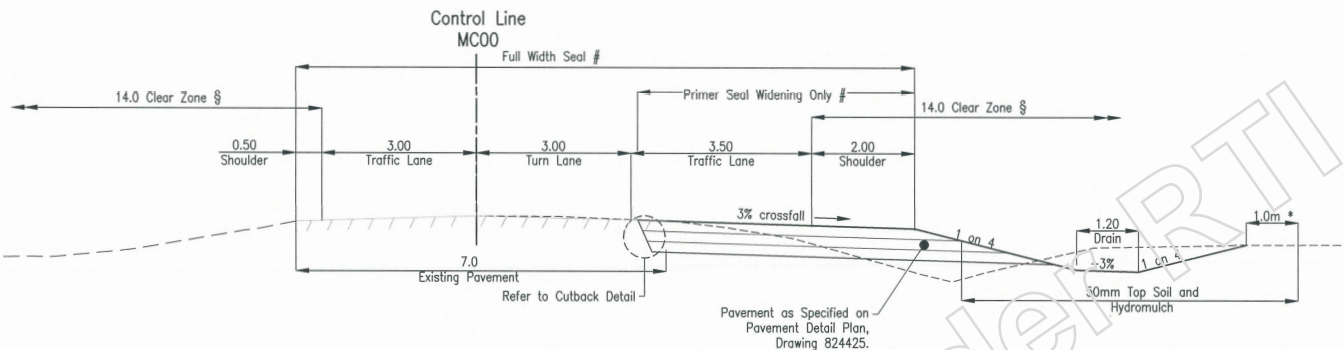

**TYPE B - WIDENING - CHR(s)**  
CHGE: 4738 - 4950 (MC00)

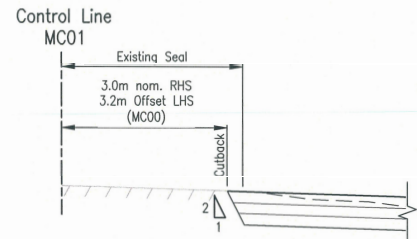

**CUTBACK DETAIL**

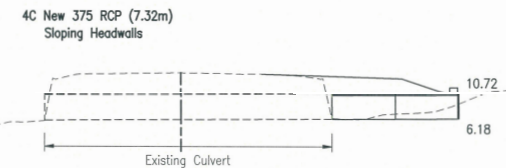

**4B Ex. 900 RCP (11.12m) 4883**  
 Extend 4.88 RHS (2/2.44) (Class 3, Butt Joint) (1.84 outside of walls)  
 Skew Angle 4.5° Skew Number 94.5 (16.00 overall length)  
 Cast Insitu Endwall with Apron and Cutoff Wall RHS  
 Reinforced Wingwall (W1 3.2, W2 2.8) (R) Conc. 2.3m<sup>3</sup>  
 Reinforced Conc. Apron Conc. 0.5m<sup>3</sup>, C/O Wall Conc. 0.2m<sup>3</sup>  
 Backfill Material 0.8m<sup>3</sup>  
 Bedding/haunch Material 2.6m<sup>3</sup> (H2)  
 Standard Drawings - 1304, 1359  
 External Dia. 1029mm, Pipe Thick. 57mm, Headwall Ht. 230mm

**4A Ex. 4/450 RCP (14.80m) 4634**  
To Remain

**DRAINAGE DETAILS**

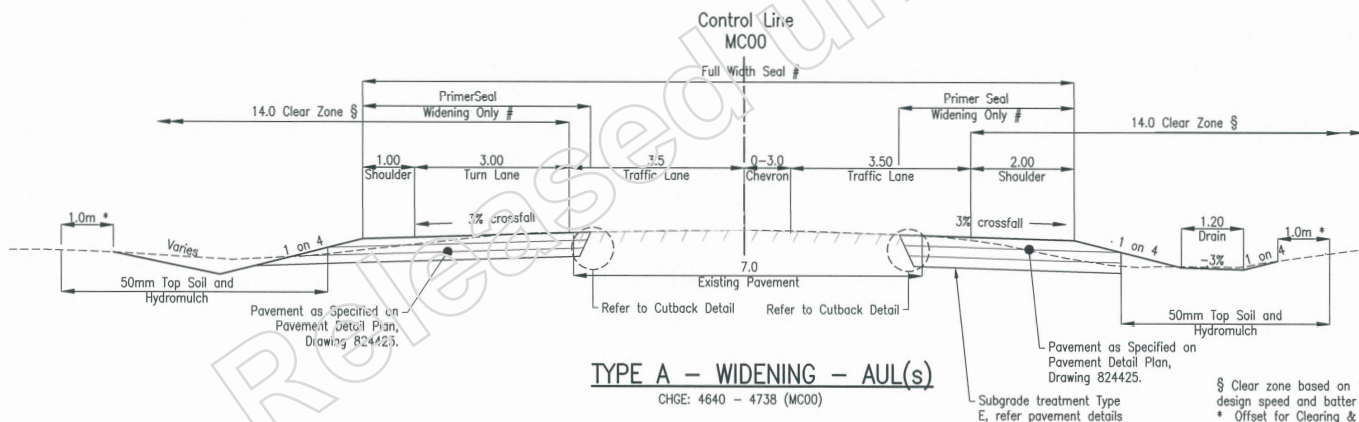

**TYPE A - WIDENING - AUL(s)**  
CHGE: 4640 - 4738 (MC00)

§ Clear zone based on 110km/h design speed and batter slope 1:4.  
 \* Offset for Clearing & Grubbing.

Last Modified: J. Feb. 25, 2020 - 12:24pm XREFS :-

G F E D C B As Constructed A Issued For Construction	Associated Job Nos	Survey Data	Scales	FRASER COAST REGIONAL COUNCIL				ROAD TYPICAL SECTIONS AND DETAILS				Job No. 228/1632/1075873 Contract No. CN-13066 Drawing No. 824424 B Series Number 03 of 12 MRR_Detail (02/14)			
	Auxiliary Drg Nos	Datum		BOORAL ROAD (1632)				ENGINEERING CERTIFICATION (RPEQ)							
	824422 - 824433	GDA 94		CTL CHGE 4640 - 4950				NAME SIGNATURE							
		MGA 94, Z56		Reference Points				M/R DATE							
	Horiz. Grid		NTS	Preceding RP	Dist. to start of job (km)	From start to end of job	From end to Following RP	Following RP	D. Riemer		CIVIL	Vince Green	Vince Green	10577	05/11/19
	Height Origin			1A	4.64	.31	4.969	2	D. Riemer						
	Survey Books		Dimensions shown in metres except where shown otherwise	Through Chainage from IN1 163/1632/164, 4.64 - 4.95km											

The works shown on this drawing are a factual representation of the works constructed.

Signal: **NR** Date: **26/07/2020**

Name: \_\_\_\_\_ ID: 8777

Title: **Engineer (Civil)**

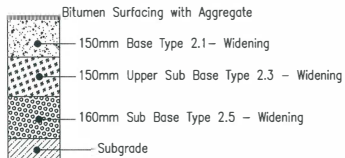

Refer Drawing No 824424 for Typical Road Sections and Details.

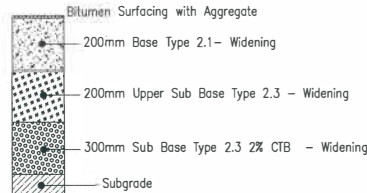

**PAVEMENT 2**  
CHGE: 4640 - 4950 (MC00) RHS

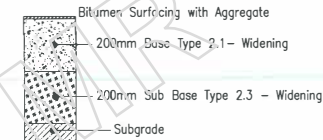

**PAVEMENT 3**  
Woods Road Eastern Kerb Return and Tapers

**PAVEMENT 1**

CHGE: 4640 - 4738 (MC00) LHS  
Woods Road Western Kerb Return and Tapers

**PAVEMENT DESIGN**

Design Life = 10 years  
 ESA/day = 400  
 DESA =  $2.0 \times 10^{-6}$   
 Design Subgrade = CBR 3  
 Design Subgrade = CBR 1.5 @ 800mm

Pavement design has been based on assumptions from Geotechnical Investigation and site observations and historic data.

**LEGEND**

	Pavement 1
	Pavement 2
	Pavement 3
	Scatter Coat

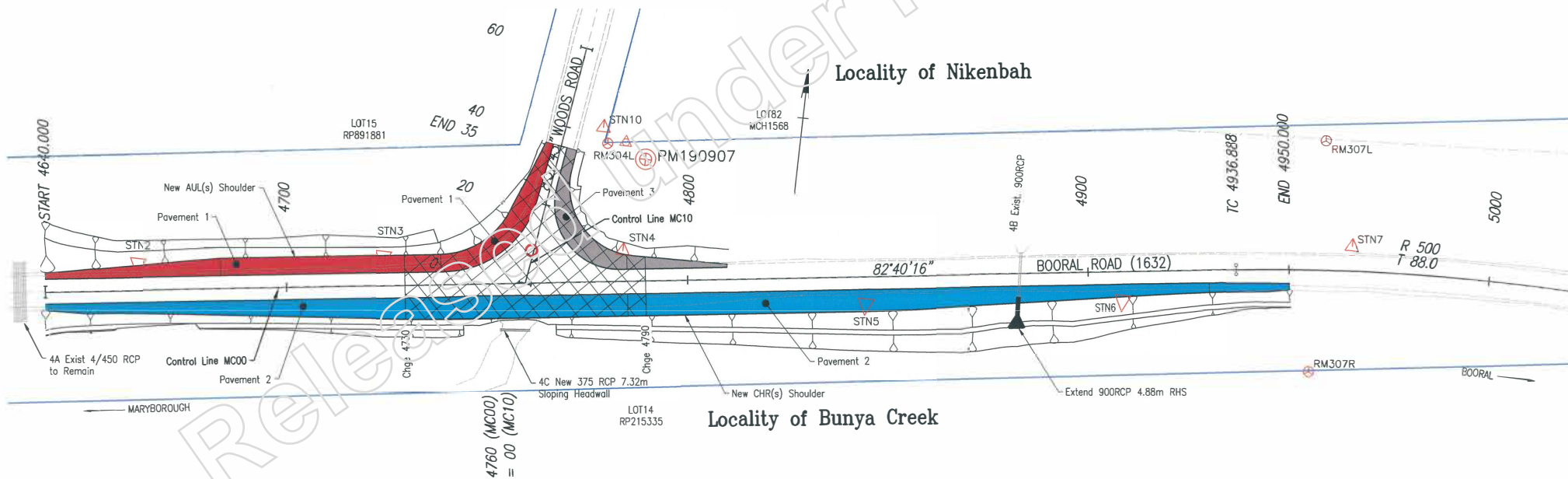

Last Modified: Feb 25, 2020 - 12:24pm XREFS: J:\X3500\Proj 1\X3500.dwg

G F E D C B A Issued For Construction Revisions/Descriptions Certification Date Microfiled	Associated Job Nos Survey Data Datum: GDA 94 Horiz. Grid: MGA 94, Z56 Height Origin: AHD DERIVED Survey Books: 228109	Scales 0 5 10 15 20m Dimensions shown in metres except where shown otherwise	FRASER COAST REGIONAL COUNCIL BOORAL ROAD (1632) CTL CHGE 4640 - 4950					PAVEMENT DETAILS				Job No. 228/1632/1075873 Contract No. CN-13066 Drawing No. 824425 Series Number 04 of 12 MRR Detail 702714
			Reference Points Preceding RP: 1A, Dist. to start of job (km): 4.64, From start to end of job: .31, From end to Following RP: 4.969, Following RP: 2					ENGINEERING CERTIFICATION (RPEQ) ENG. AREA: CIVIL, NAME: Vince Green, SIGNATURE: Vince Green, NO.: 10577, DATE: 05/11/19				
			Drawn: D. Riemer Designed: D. Riemer					Job No. 228/1632/1075873 Contract No. CN-13066 Drawing No. 824425 Series Number 04 of 12 MRR Detail 702714				
			CAD FILES: G:\BUND\TechServ\Projects\228 Fraser Coast\228 1632 1075873 Woods Rd SRS\Design\MCAD\824425_PD_AcCon.dwg					Job No. 228/1632/1075873 Contract No. CN-13066 Drawing No. 824425 Series Number 04 of 12 MRR Detail 702714				



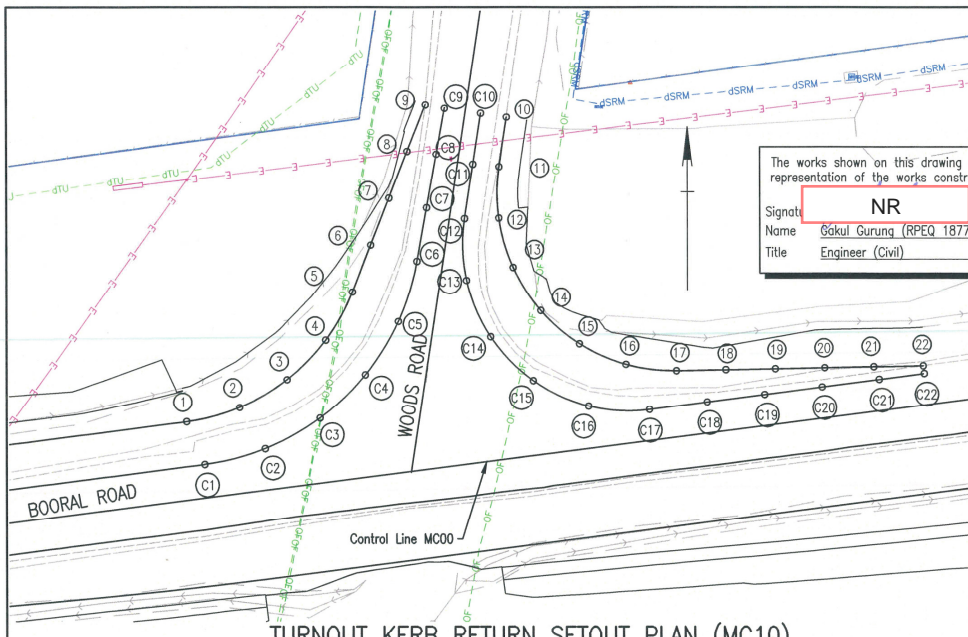

TURNOUT KERB RETURN SETOUT PLAN (MC10)

**LEGEND**

- dTU - Underground Telecommunications (DBYD)
- oF - Underground Optic Fibre
- dOF - Underground Optic Fibre (DBYD)
- dSRM - Underground Sewer (DBYD)
- E - Overhead Electrical
- - - - - Clearing & Grubbing Limits
- +++ Clearing for Clear Zone

Grubbing Setout Table

Point	Eastings	Northings
G01	481100.939	7197285.721
G02	481118.571	7197282.814
G03	481170.328	7197289.957
G04	481188.566	7197291.373
G05	481197.367	7197294.473
G06	481204.446	7197294.452
G07	481213.748	7197303.387
G08	481218.485	7197310.477
G09	481221.072	7197318.574
G10	481233.762	7197316.425
G11	481234.544	7197303.375
G12	481241.670	7197296.882
G13	481250.506	7197295.537
G14	481260.720	7197297.328
G15	481271.032	7197297.582
G16	481104.622	7197255.877
G17	481121.235	7197258.981
G18	481154.957	7197262.841
G19	481186.986	7197264.690
G20	481203.003	7197266.258
G21	481207.962	7197267.405
G22	481230.540	7197269.357
G23	481235.172	7197269.704
G24	481331.718	7197276.542
G25	481359.810	7197282.404
G26	481403.138	7197295.367
G27	481412.058	7197296.519

Kerb Return Shoulder Setout Table

Points	Eastings	Northings	Heights
1	481199.820	7197287.473	7.378
2	481204.954	7197288.846	7.343
3	481209.546	7197291.522	7.268
4	481213.271	7197295.314	7.151
5	481215.866	7197299.953	7.030
6	481217.641	7197304.446	6.942
7	481219.415	7197308.926	6.873
8	481221.189	7197313.411	6.824
9	481222.963	7197317.896	6.795
10	481230.775	7197316.716	6.868
11	481230.049	7197311.333	6.913
12	481230.022	7197307.016	6.979
13	481231.403	7197302.293	7.067
14	481234.077	7197298.171	7.172
15	481237.820	7197294.983	7.272
16	481242.318	7197292.999	7.359
17	481247.197	7197292.385	7.434
18	481251.984	7197292.481	7.495
19	481256.771	7197292.577	7.544
20	481261.558	7197292.673	7.582
21	481266.344	7197292.768	7.609
22	481271.130	7197292.864	7.624

Kerb Return Cutback Setout Table

Points	Eastings	Northings
C1	481201.579	7197283.364
C2	481207.434	7197284.886
C3	481212.721	7197287.822
C4	481217.107	7197291.987
C5	481220.312	7197297.116
C6	481222.133	7197302.885
C7	481223.063	7197308.011
C8	481223.992	7197313.136
C9	481224.796	7197317.564
C10	481228.285	7197317.100
C11	481227.525	7197312.180
C12	481226.718	7197306.963
C13	481226.907	7197301.068
C14	481229.218	7197295.644
C15	481233.337	7197291.424
C16	481238.705	7197288.984
C17	481244.592	7197288.653
C18	481250.165	7197289.377
C19	481255.737	7197290.101
C20	481261.309	7197290.825
C21	481266.881	7197291.549
C22	481271.227	7197292.114

Refer Drawing No 824423 for Control Line Setout and Survey Station Details.

Refer Drawing No 824425 for Pavement Details.

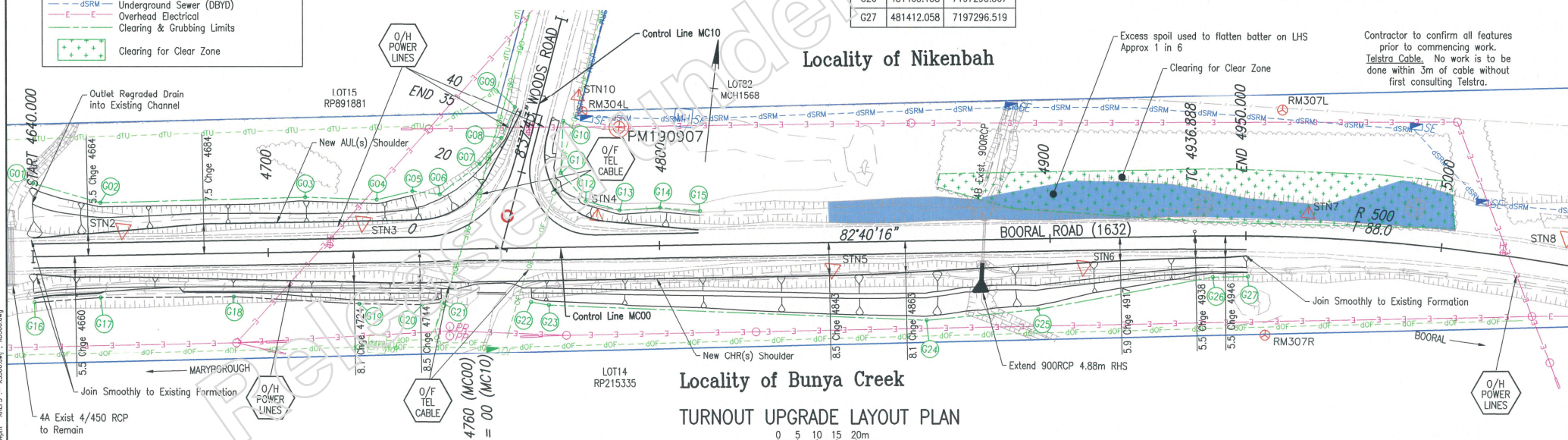

TURNOUT UPGRADE LAYOUT PLAN

FRASER COAST REGIONAL COUNCIL  
BOORAL ROAD (1632)

CTL CHGE 4640 - 4950

Preceding RP	Dist. to start of job (km)	From start to end of job	From end to Following RP	Following RP
1A	4.64	.31	4.969	2

Through Change from INT 163/1632/164, 4.64 - 4.95km

TURNOUT GENERAL ARRANGEMENT AND SETOUT

ENG. AREA	NAME	SIGNATURE	NO.	DATE
CIVIL	Vince Green	Vince Green	10577	05/11/19

**Queensland Government**

Job No. 228/1632/1075873  
Contract No. CN-13066  
Drawing No. 824426 B  
Series Number 05 of 12  
MRR\_Detail (02/14)

Last Modified: Feb 25, 2020 - 12:31pm XREFS: - XS500.dwg: - X5050.dwg



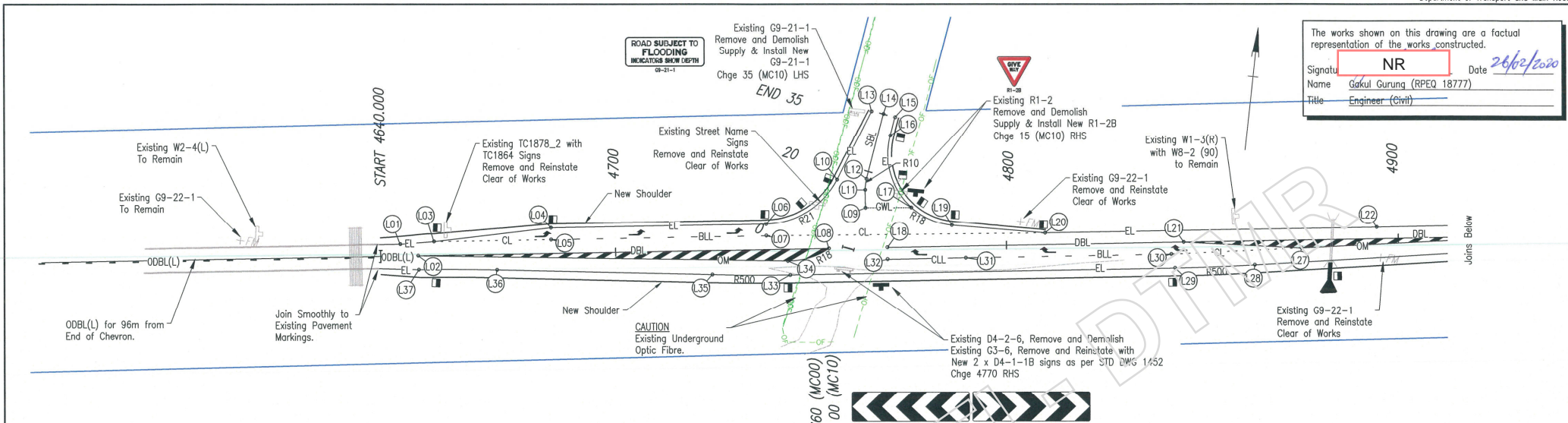

The works shown on this drawing are a factual representation of the works constructed.

Signature: **NR** Date: **26/02/2020**  
 Name: **Gakul Gurung (RPEQ 18777)**  
 Title: **Engineer (Civil)**

**NOTES**

- A. Line marking and RRPMS shall be in accordance with the Manual of Uniform Traffic Control Devices. Line marking to be verified onsite by the Administrator.
- B. It is the contractors' responsibility to determine whether an existing sign will be impacted by the proposed works. Where necessary, signs are to be removed and reinstated.
- SOLAR POWERED FLAG LIGHT NOTES:**
- The luminaire is to be solar powered and maintained by the Department of Transport and Main Roads.
  - All service locations to be confirmed with the local authorities. Coordinate all new work with existing underground services in situ prior to trenching and installation of conduits.
  - Flag light pole location to be determined on-site with the project RPEQ after road widening.
  - Poles and pits are not to be located in drainage paths. Battery pits are to be installed flat to ensure battery is level. Where battery pits cannot be installed flat, concrete step treads are to be installed, locations to be confirmed on site.
  - Solar installations to comply with supplementary specification SS01 "Solar Lighting Installations". Solar lighting installation to include the following units:
    - 1 x Phoenix Mini 30W LED Luminaire, CIT 5000K
    - 1 x 7.5m Slip Base mount pole with 3.0m outreach
    - 1 x Foundation cage w/hold down bolts and reinforcing cage
    - 1 x Battery Fuse
    - 1 x 150W 12V Solar panel using 25 AMP cable
    - 1 x 20AMP 12V Morning Star Sunlight SL-20-12V Solar Lighting Controlled W/Metal Housing
    - 4 x 100Ah 12V Deep Cycle Century C12-1-SDG Gel Batteries
    - 1 x Underground battery pit

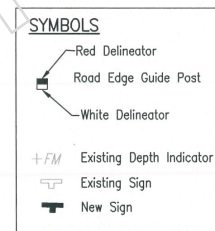

**Pavement Marking Setout Table**

Point	Easting	Northing	L19	L20	L21	L22	L23	L24	L25	L26	L27	L28	L29	L30	L31	L32	L33	L34	L35	L36	L37																																			
L01	481107.574	7197271.078	L20	481271.146	7197292.085	L21	481306.525	7197293.634	L22	481355.057	7197302.869	L23	481398.705	7197308.514	L24	481399.078	7197305.537	L25	481398.884	7197301.985	L26	481377.751	7197298.849	L27	481336.517	7197295.477	L28	481325.239	7197289.907	L29	481305.090	7197286.897	L30	481303.749	7197290.254	L31	481251.678	7197283.557	L32	481224.283	7197300.593	L33	481207.520	7197274.348	L34	481206.529	7197277.766	L35	481187.635	7197272.194	L36	481132.847	7197267.365	L37	481112.961	7197265.211

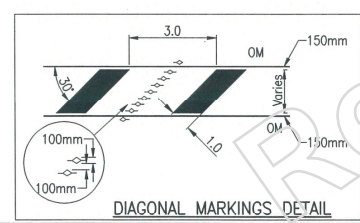
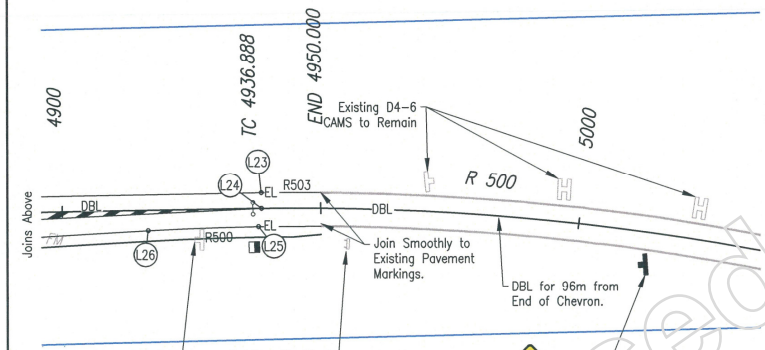

**LONGITUDINAL LINES**

Line Type	Preferred Width (mm)	Abbrev
Edge line	150	EL
Lane Line (Continuous)	100	CLL
Lane Line (Broken)	100	BLL
Double Barrier Line	80/80	DBL
Barrier Line (One Direction)	80/80	ODBL(L/R)

**LONGITUDINAL LINES**

Line Type	Preferred Width (mm)	Abbrev
Barrier Line (Single)	100	SBL
Continuity Line	200	CL
Giveaway Line	300	GWL
Outline Marking	150	OM

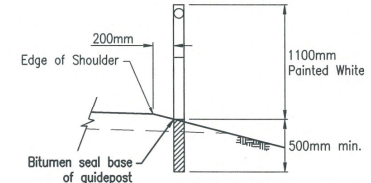

This detail shows the location to be adopted for R.E.G.P.s in relation to the edge of shoulder only. For additional information, Refer Std Dwg 1356 and MUTCD.

**LOCATION OF ROAD EDGE GUIDE POSTS**  
 Dimensions are shown in millimetres  
 NTS

C F D E C B A As Constructed Issued For Construction	Associated Job Nos Survey Data Datum: GDA 94 Horiz. Grid: MGA 94, Z56 Height Origin: AHD DERIVED Survey Books: 228109	Scales 0 5 10 15 20m	<b>FRASER COAST REGIONAL COUNCIL</b> <b>BOORAL ROAD (1632)</b> <b>CTL CHGE 4640 - 4950</b>				<b>SIGNS AND PAVEMENT MARKING LAYOUT</b>				Job No. <b>228/1632/1075873</b> Contract No. <b>CN-13066</b> Drawing No. <b>824427</b> Series Number <b>06 of 12</b> MRR Detail (02/14)
			Reference Points Preceding RP: 1A, 4.64 Dist. to start of job (km): 4.64 From start to end of job: .31 From end to Following RP: 4.969 Following RP: 2 Through Chainage from INT 163/1632/164, 4.64 - 4.95km				ENGINEERING CERTIFICATION (RPEQ) ENC. AREA: CIVIL, Vince Green NAME: Vince Green SIGNATURE: Vince Green NO.: 10577 DATE: 05/11/19				
			Revisions/Descriptions Certification Date Microfiled				Drawn: D. Riemer Designed: D. Riemer				
			NR 25/2/2020 824422 - 824433				Queensland Government				



Refer to Type Section & Pavement detail drawings 824424-824425 for As Constructed Information

The works shown on this drawing are a factual representation of the works to be constructed.  
 Signat **NR** Date **26/02/2020**  
 Name **Gukul Gurung (RPEQ 18777)**  
 Title **Engineer (Civil)**

CONTROL LINE MC00  
 X = 481112.916  
 Y = 7197268.734  
 Z = 7.767

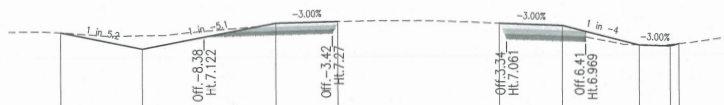

Datum 4.00

DESIGN HEIGHT	7.267	6.655	7.665	7.737	7.670	7.597	6.848	6.812	6.895
SUBGRADE HEIGHT	7.267	6.655	7.205	7.737	7.670	6.996	6.848	6.812	6.895
EXISTING SURFACE	-13.937/7.267	-10.766/7.167	-5.601/7.589	-3.200/7.737	3.060/7.670	5.501/7.356	8.495/6.854	9.795/6.863	10.028/6.895
OFFSETS									

CHAINAGE 4650.000

CONTROL LINE MC00  
 X = 481122.835  
 Y = 7197270.010  
 Z = 7.714

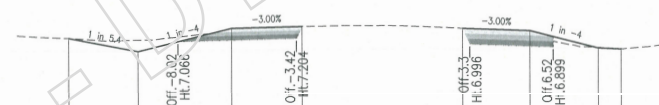

Datum 4.00

DESIGN HEIGHT	7.176	6.680	7.588	7.670	7.604	7.527	6.863	6.836	6.836
SUBGRADE HEIGHT	7.176	6.680	7.128	7.670	7.604	6.927	6.863	6.836	6.836
EXISTING SURFACE	-12.246/7.176	-9.561/7.121	-5.928/7.473	-3.200/7.670	-1.016/7.604	4.609/7.289	11.264/6.886	11.151/6.836	11.151/6.836
OFFSETS									

CHAINAGE 4660.000

CONTROL LINE MC00  
 X = 481102.998  
 Y = 7197267.459  
 Z = 7.821



Datum 4.00

DESIGN HEIGHT	7.018	6.630	7.727	7.778	7.714	7.669	6.833	6.797	6.838
SUBGRADE HEIGHT	7.018	6.630	7.727	7.778	7.714	7.669	6.833	6.797	6.838
EXISTING SURFACE	-17.418/7.018	-13.508/7.167	-4.903/7.691	-3.200/7.778	3.065/7.714	4.565/7.628	9.339/6.839	10.539/6.883	10.703/6.893
OFFSETS									

CHAINAGE 4640.000

CONTROL LINE MC00  
 X = 481114.900  
 Y = 7197268.989  
 Z = 7.756



Datum 4.00

DESIGN HEIGHT	7.239	6.660	7.648	7.724	7.658	7.585	6.851	6.815	6.889
SUBGRADE HEIGHT	7.239	6.660	7.187	7.724	7.658	6.984	6.851	6.815	6.889
EXISTING SURFACE	-13.470/7.239	-10.463/7.150	-5.741/7.559	-3.200/7.724	3.049/7.658	5.506/7.339	8.440/6.863	9.640/6.860	9.938/6.889
OFFSETS									

CHAINAGE 4652.000

Last Modified: 1. Feb. 25, 2020 - 12:25pm XREFS

G F E D C B A	As Constructed	NR	25/3/2020	Associated Job Nos	Survey Data	Scales	FRASER COAST REGIONAL COUNCIL					ANNOTATED ROAD CROSS SECTIONS MC00					
							BOORAL ROAD (1632)					SHEET 1 OF 6					
Revisions/Descriptions				Certification	Date	Microfiled	Reference Points					ENGINEERING CERTIFICATION (RPEQ)					Job No.
A Issued For Construction							Preceding RP					NAME					Contract No.
B As Constructed							Dist. to start of job (km)					SIGNATURE					228/1632/1075873
C							From start to end of job					VINCE GREEN					Contract No.
D							From end to Following RP					VINCE GREEN					824428
E							Following RP					VINCE GREEN					Series Number
F							1A 4.64 .31 4.969 2					10577 05/11/19					07 of 12
G							Through Chainage from INT 163/1632/164, 4.64 - 4.95km										MRR_Detail (02/14)

Refer to Type Section & Pavement detail drawings 824424-824425 for As Constructed information

The works shown on this drawing are a factual representation of what is to be constructed.  
 Signature: **NR** Date: **24/02/2020**  
 Name: **Gajul Gurung (RPEQ 18777)**  
 Title: **Engineer (Civil)**

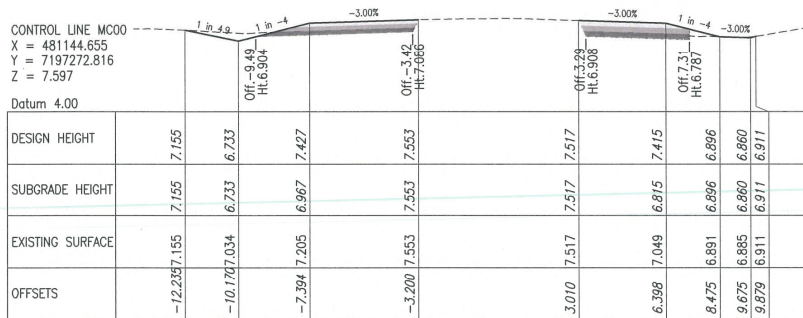

CHAINAGE 4682.000

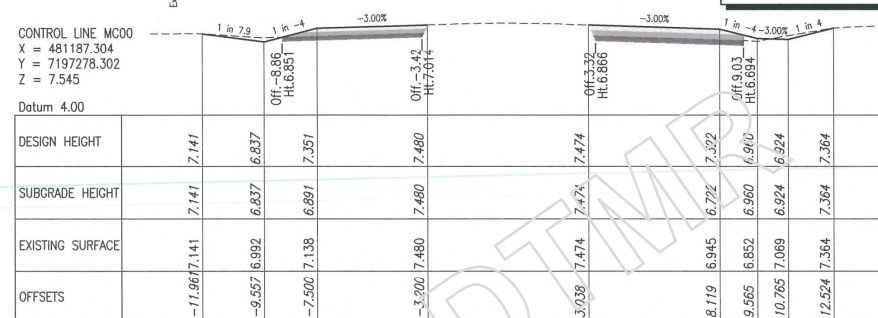

CHAINAGE 4725.000

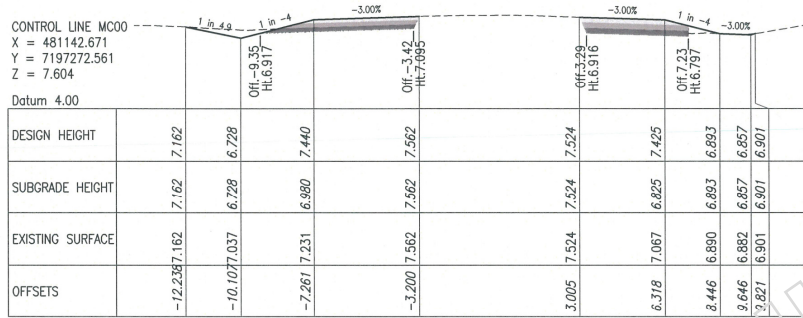

CHAINAGE 4680.000

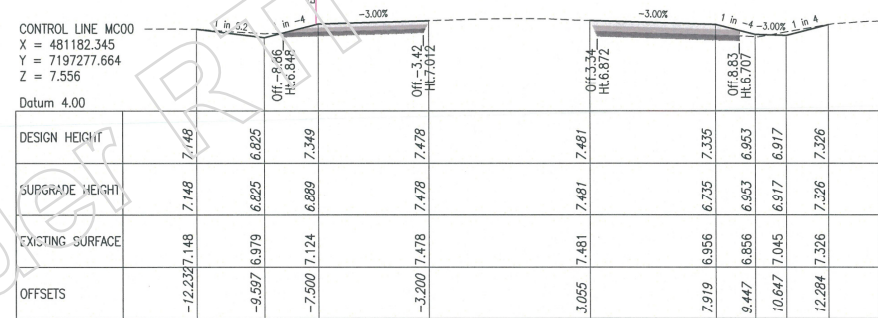

CHAINAGE 4720.000

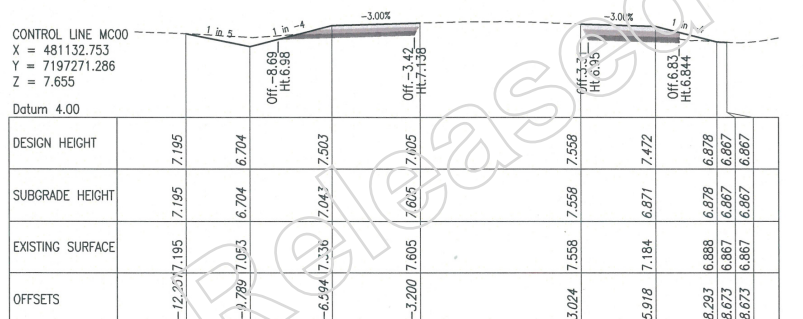

CHAINAGE 4670.000

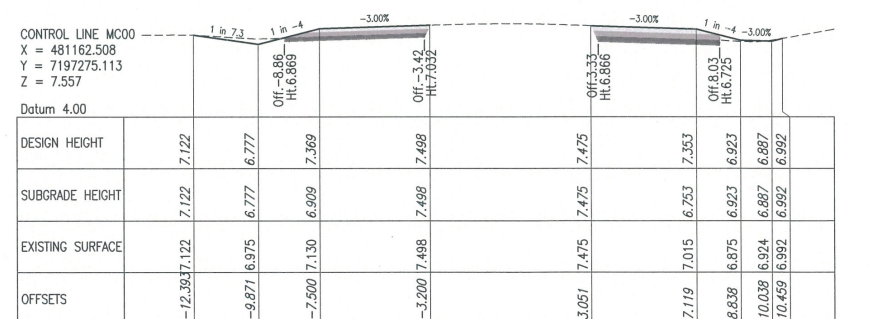

CHAINAGE 4700.000

Last Modified: 1 Feb 25, 2020 - 12:35pm XREFS: --

G F E D C B A As Constructed Issued For Construction Revisions/Descriptions Certification Date Microfiled	Associated Job Nos Survey Data Datum GDA 94 Horiz. Grid MGA 94, 256 Height Origin AHD DERIVED Survey Books 228109	Scales 0 1 2 3 4m Dimensions shown in metres except where shown otherwise	FRASER COAST REGIONAL COUNCIL BOORAL ROAD (1632)		ANNOTATED ROAD CROSS SECTIONS MC00 SHEET 2 OF 6		Queensland Government Job No. 228/1632/1075873 Contract No. CN-13066 Drawing No. 824429 B Series Number 08 of 12 MRR_Detail (02/14)		
			CTL CHGE 4640 - 4950 Reference Points		Drawn D. Riemer Designed D. Riemer			ENGINEERING CERTIFICATION (RPEQ) ENG. AREA NAME SIGNATURE NO. DATE CIVIL Vince Green Vince Green 10577 05/11/19	
			Preceding RP Dist. to start of job (km) From start to end of job From end to Following RP Following RP		1A 4.64 .31 4.969 2				
			Through Chainage from INT 163/1632/164, 4.64 - 4.95km						



Refer to Type Section & Pavement detail drawings 824424-824425 for As Constructed information

The works shown on this drawing are a factual representation of the works constructed.  
 Signature: **NR** Date: **26/02/2020**  
 Name: **Gakul Gurung (RPEQ 18777)**  
 Title: **Engineer (Civil)**

CONTROL LINE MC00  
 X = 481207.140  
 Y = 7197280.853  
 Z = 7.563

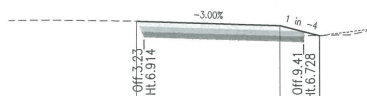

Datum 4.00

DESIGN HEIGHT			7.523				
SUBGRADE HEIGHT			7.523		6.756	7.356	
EXISTING SURFACE			7.523		7.078	6.974	6.974
OFFSETS		2.945			6.500	10.028	10.038
						10.038	6.974

CHAINAGE 4745.000

CONTROL LINE MC00  
 X = 481246.814  
 Y = 7197285.956  
 Z = 7.670

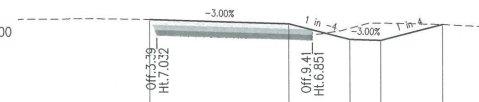

Datum 4.00

DESIGN HEIGHT			7.641				
SUBGRADE HEIGHT			7.641		6.879	7.479	
EXISTING SURFACE			7.641		7.085	6.886	6.850
OFFSETS		3.107			8.500	10.879	12.073
						12.073	7.450

CHAINAGE 4785.000

TURNOUT LHS

CONTROL LINE MC00  
 X = 481202.181  
 Y = 7197280.215  
 Z = 7.546

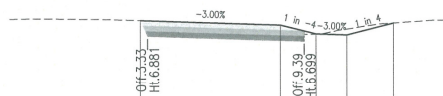

Datum 4.00

DESIGN HEIGHT			7.489				
SUBGRADE HEIGHT			7.489		6.726	7.327	
EXISTING SURFACE			7.489		6.988	6.983	6.947
OFFSETS		3.053			8.479	9.853	11.053
						12.968	7.401

CHAINAGE 4740.000

CONTROL LINE MC00  
 X = 481241.854  
 Y = 7197285.318  
 Z = 7.659

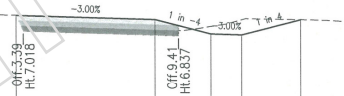

Datum 4.00

DESIGN HEIGHT			7.627				
SUBGRADE HEIGHT			7.627		6.865	7.465	
EXISTING SURFACE			7.627		7.072	6.920	6.884
OFFSETS		3.110			8.500	10.879	11.879
						14.165	7.456

CHAINAGE 4780.000

CONTROL LINE MC00  
 X = 481200.198  
 Y = 7197279.960  
 Z = 7.547

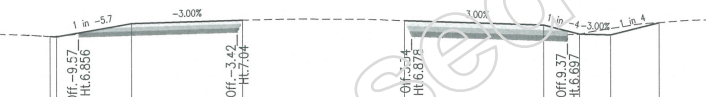

Datum 4.00

DESIGN HEIGHT			7.507				
SUBGRADE HEIGHT			7.507		6.918	7.378	
EXISTING SURFACE			7.507		7.196	6.944	6.944
OFFSETS		-10.065			7.900	8.457	9.837
						11.037	12.930

CHAINAGE 4738.000

CONTROL LINE MC00  
 X = 481222.018  
 Y = 7197282.767  
 Z = 7.605

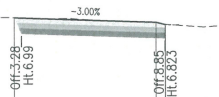

Datum 4.00

DESIGN HEIGHT			7.599				
SUBGRADE HEIGHT			7.599		7.345	7.345	
EXISTING SURFACE			7.599		7.344	7.345	7.345
OFFSETS		3.000			8.500	8.865	8.865

CHAINAGE 4760.000

User Modified: J. Feb. 25, 2020 - 12:25pm XREFS ---

G F E D C B A As Constructed Issued For Construction	Associated Job Nos Survey Data Datum GDA 94 Horiz. Grid MCA 94, 256 Height Origin AHD DERIVED Survey Books 228109	Scales 0 1 2 3 4m	FRASER COAST REGIONAL COUNCIL BOORAL ROAD (1632)					ANNOTATED ROAD CROSS SECTIONS MC00 SHEET 3 OF 6					Job No. 228/1632/1075873 Contract No. CN-13066 Drawing No. 824430 Series Number 09 of 12 MRR_Detail (02/14)	
			CTL CHGE 4640 - 4950 Reference Points					ENGINEERING CERTIFICATION (RPEQ)						
			Preceding RP 1A	Dist. to start of job (km) 4.64	From start to end of job .31	From end to Following RP 4.969	Following RP 2	Drawn D. Riemer	ENG. AREA CIVIL	NAME Vince Green	SIGNATURE	NO. 10577		DATE 05/11/19
			Dimensions shown in metres except where shown otherwise Through Chainage from INT 163/1632/164, 4.84 - 4.95km					D. Riemer						

Refer to Type Section & Pavement detail drawings 824424-824425 for As Constructed information

The works shown on this drawing are a factual representation of the works constructed.  
 Signature: **NR** Date: **25/2/2020**  
 Name: **Gokul Gurung (RPEQ 18777)**  
 Title: **Engineer (Civil)**

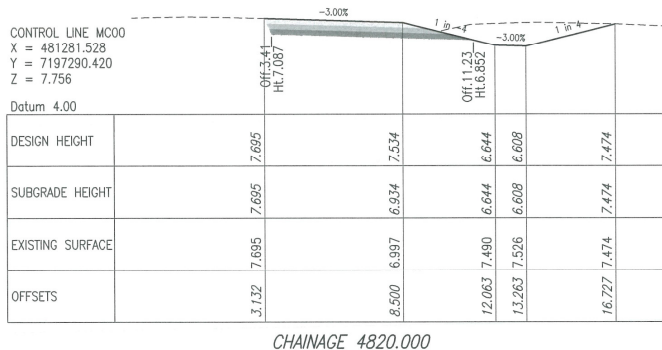

CHAINAGE 4820.000

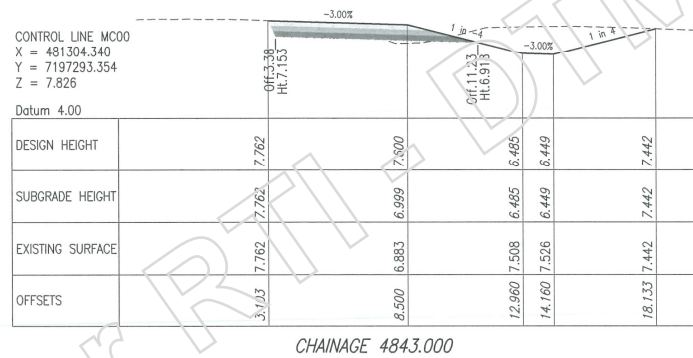

CHAINAGE 4843.000

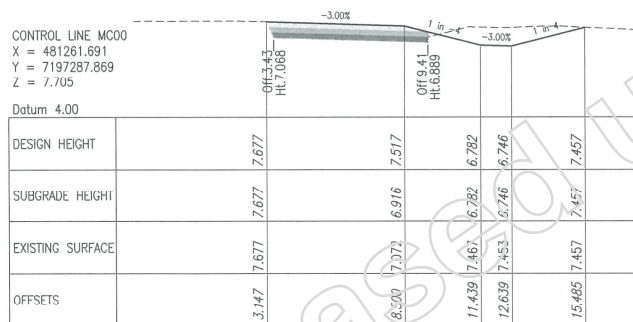

CHAINAGE 4800.000

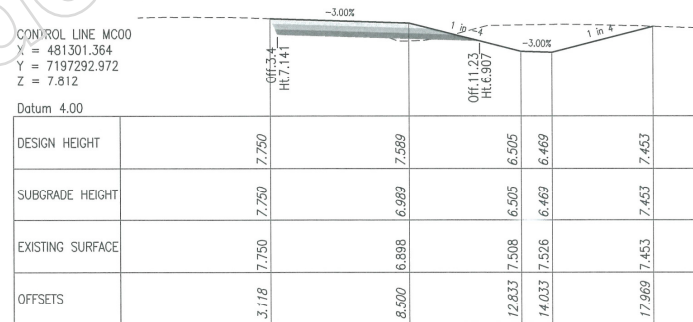

CHAINAGE 4840.000

Last Modified: J. Feb. 25, 2020 - 12:35pm MREPS - I

G F E D C B As Constructed A Issued For Construction	NR 25/2/2020	824422 - 824433	AHD DERIVED	228109	Scales 0 1 2 3 4m Dimensions shown in metres except where shown otherwise	FRASER COAST REGIONAL COUNCIL BOORAL ROAD (1632) CTL CHGE 4640 - 4950					ANNOTATED ROAD CROSS SECTIONS MCO0 SHEET 4 OF 6				Job No. 228/1632/1075873 Contract No. CN-13066 Drawing No. 824431 B Series Number 10 of 12 MRR_Detail (02/14)
						Associated Job Nos Datum GDA 94 Survey Data Horiz. Grid MGA 94, 256 Height Origin AHD DERIVED Survey Books 228109					Reference Points Preceding RP 1A Dist. to start of job (km) 4.64 From start to end of job -31 From end to Following RP 4.969 Following RP 2				



Refer to Type Section & Pavement detail drawings 824424-824425 for As Constructed information

The works shown on this drawing are a factual representation of the works constructed.  
 Signature: **NR** Date: **26/6/2020**  
 Name: Gokul Gurung (RPEQ 18777)  
 Title: Engineer (Civil)

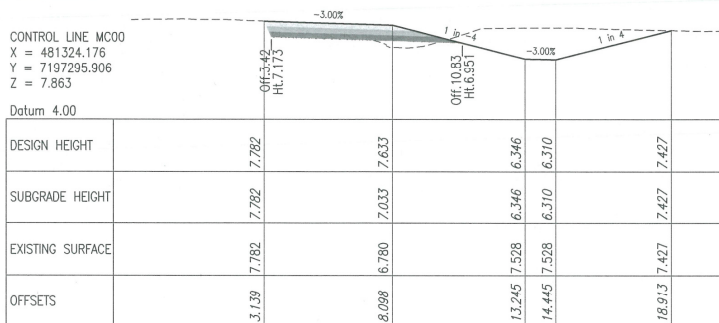

CHAINAGE 4863.000

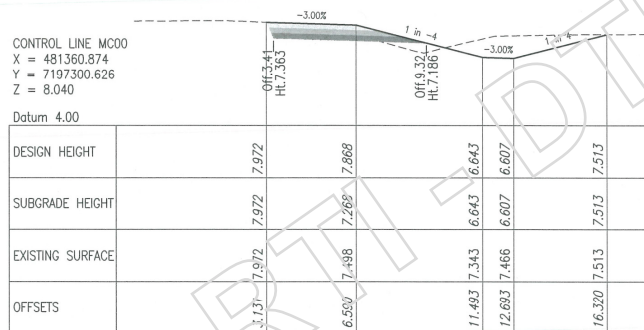

CHAINAGE 4900.000

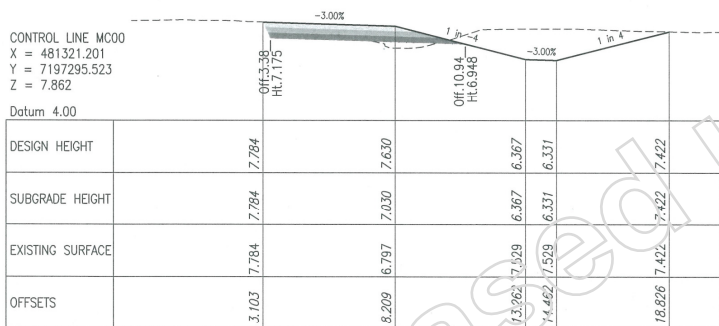

CHAINAGE 4860.000

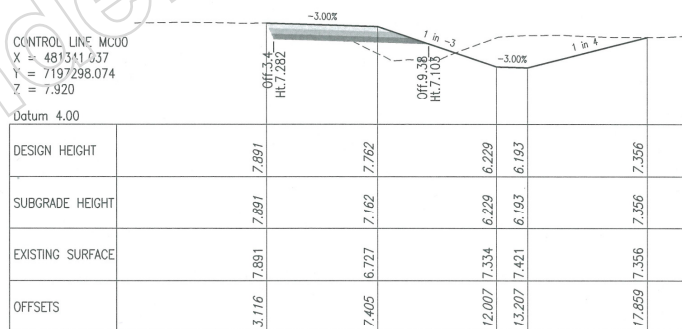

CHAINAGE 4880.000

Last Modified: Fri, 26 Jun 2020 - 12:35pm WEPFS

G	Associated Job Nos	Survey Data		Scales	FRASER COAST REGIONAL COUNCIL					ANNOTATED ROAD CROSS SECTIONS MC00					
		Datum GDA 94			BOORAL ROAD (1632)					SHEET 5 OF 6					
F	Auxiliary Drg Nos	Horiz. Grid			CTL CHGE 4640 - 4950					ENGINEERING CERTIFICATION (RPEQ)					Job No.
E		MGA 94, Z56			Reference Points					NAME					228/1632/1075873
D	824422 - 824433	Height Origin		Preceding RP		Dist. to start of job (km)	From start to end of job	From end to Following RP	Following RP	SIGNATURE		NO.	DATE	Contract No.	
C		AHD DERIVED		1A	4.64	.31	4.969	2	Vince Green		10577	05/11/19	228/1632/1075873		
B	As Constructed	Survey Books		Dimensions shown in metres except where shown otherwise		Through Chainage from INT 163/1632/164, 4.64 - 4.95km					VINCE GREEN		11 of 12		
A	Issued For Construction	2281109							VINCE GREEN				824432		
Revisions/Descriptions		Certification		Date		Microfilled								Series Number	
NR		25/2/2020												MRR Detail (02/14)	

Refer to Type Section & Pavement detail drawings 824424-824425 for As Constructed information

The works shown on this drawing are a factual representation of the works constructed.  
 Signature **NR** Date **26/02/2020**  
 Name **Gakul Gurung (RPEQ 18777)**  
 Title **Engineer (Civil)**

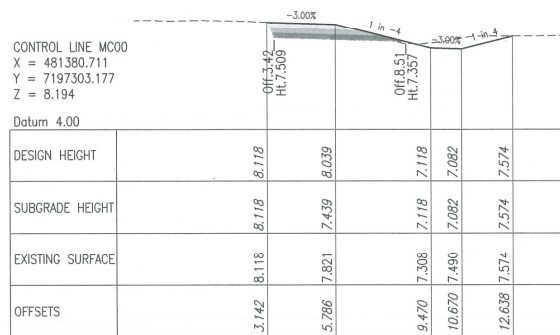

CHAINAGE 4920.000

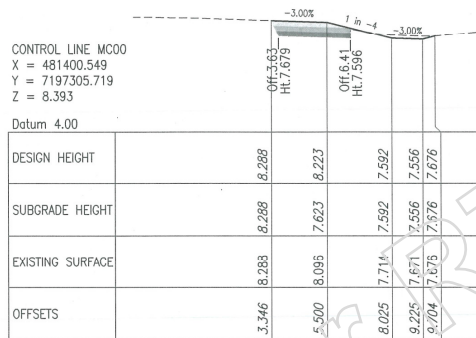

CHAINAGE 4940.000

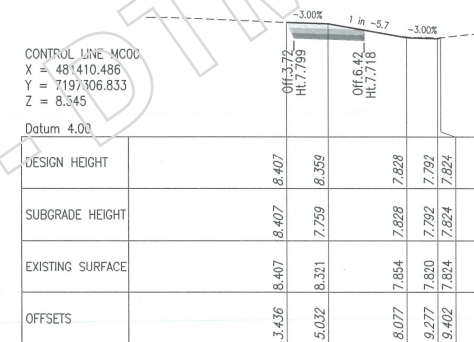

CHAINAGE 4950.000

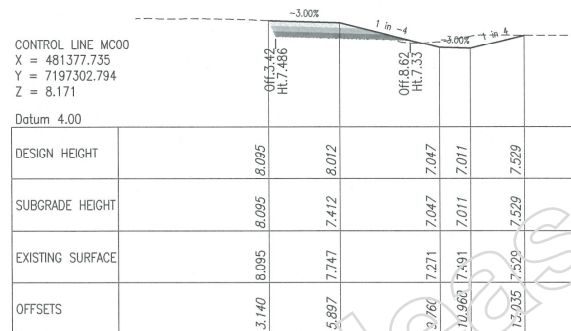

CHAINAGE 4917.000

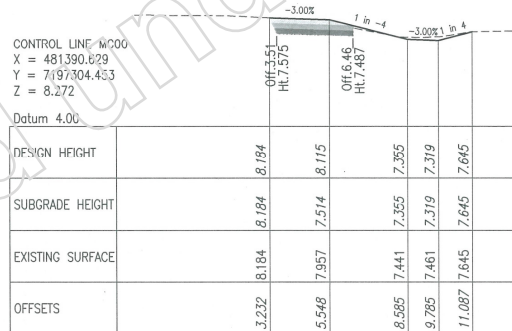

CHAINAGE 4930.000

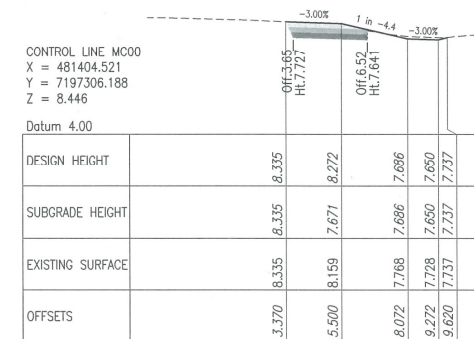

CHAINAGE 4944.000

Last Modified: Fri, 25, 2020 - 12:55pm RPEFS

G				
F				
E				
D				
C				
B	As Constructed	NR	25/2/2020	
A	Issued For Construction			
	Revisions/Descriptions	Certification	Date	Microfiled

Associated Job Nos	Survey Data
	Datum GDA 94
Auxiliary Drg Nos	Horiz. Grid MGA 94, Z56
	Height Origin AHD DERIVED
	Survey Books 228109

Scales

Dimensions shown in metres except where shown otherwise

FRASER COAST REGIONAL COUNCIL				
BOORAL ROAD (1632)				
CTL CHGE 4640 - 4950				
Reference Points				
Preceding RP	Dist. to start of job (km)	From start to end of job	From end to Following RP	Following RP
1A	4.64	31	4.969	2
Through Chainage from IN1 163/1632/164, 4.64 - 4.95km				

ANNOTATED ROAD CROSS SECTIONS MCO0				
SHEET 6 OF 6				
Drawn	ENGINEERING CERTIFICATION (RPEQ)			
D. Riemer	ENG. AREA	NAME	SIGNATURE	NO. DATE
Designed	CIVIL	Vince Green	Vince Green	10577 05/11/19
D. Riemer				

Queenland Government	
Job No.	228/1632/1075873
Contract No.	CN-13066
Drawing No.	824433 B
Series Number	12 of 12
MRR_Detail (02/14)	



# 228/1632/1075873 – Booral Rd & Woods Rd Intersection Upgrade

## Safety in Design Report

October 2019

Released under RTI - DTMR

# Creative Commons information

© State of Queensland (Department of Transport and Main Roads) 2015



<http://creativecommons.org/licenses/by/4.0/>

This work is licensed under a Creative Commons Attribution 4.0 Licence. You are free to copy, communicate and adapt the work, as long as you attribute the authors.

The Queensland Government supports and encourages the dissemination and exchange of information. However, copyright protects this publication. The State of Queensland has no objection to this material being reproduced, made available online or electronically but only if its recognised as the owner of the copyright and this material remains unaltered.



The Queensland Government is committed to providing accessible services to Queenslanders of all cultural and linguistic backgrounds. If you have difficulty understanding this publication and need a translator, please call the Translating and Interpreting Service (TIS National) on 13 14 50 and ask them to telephone the Queensland Department of Transport and Main Roads on 13 74 68.

**Disclaimer:** While every care has been taken in preparing this publication, the State of Queensland accepts no responsibility for decisions or actions taken as a result of any data, information, statement or advice, expressed or implied, contained within. To the best of our knowledge, the content was correct at the time of publishing.

Released under RMA/DMR



## Document control options

<b>Prepared by</b>	Darryl Riemer
<b>Title</b>	Senior Designer (Civil)
<b>District &amp; Region</b>	Wide Bay / Burnett District, North Coast Region
<b>Branch &amp; Division</b>	Program Delivery and Operations
<b>Project/program</b>	SRS Booral Rd (1632) & Woods Rd Intersection Upgrade
<b>Project number</b>	228/1632/1075873
<b>Project location</b>	4.640km – 4.950km on Booral Rd (1632)
<b>Status</b>	Final Submission
<b>DMS ref. no.</b>	450/01777

Released under RTI - DTMR

# Contents

<b>1</b>	<b>Introduction</b>	<b>4</b>
1.1	Purpose of this document	4
<b>2</b>	<b>Project Details</b>	<b>4</b>
2.1	Project name and description	4
<b>3</b>	<b>Risk Assessment Methodology</b>	<b>4</b>
3.1	Scope of SiD process	4
3.1.1	Scope	4
3.1.2	Structure	4
3.1.3	Objectives	4
3.1.4	Risk Treatment	4
<b>4</b>	<b>SiDR Consultation Outcomes</b>	<b>5</b>
<b>5</b>	<b>Safety in Design Risk Categories</b>	<b>5</b>
<b>6</b>	<b>Recommendations</b>	<b>5</b>
<b>7</b>	<b>Attachments</b>	<b>5</b>

Released under RTI - DTMR



# 1 Introduction

## 1.1 Purpose of this document

This document demonstrates that the project team has considered impacts of the proposed design in accordance with the Workplace Health and Safety - Work Health and Safety Act (2011) and Work Health and Safety Regulation (2011).

This is achieved by identifying and reviewing possible WHS hazards and risks during construction, operation, maintenance, and demolition of this project, as outlined in the Road Planning and Design Manual Volume 3, Part 8 Process and Documentation.

# 2 Project Details

## 2.1 Project name and description

Upgrade existing intersection at Woods Rd to CHR(s) with AUL(s), including vegetation clearing and other upgrades as required. Pavement widening Ch.4.640km to 4.950km on 1632, 228/1632/1075873. Detail Design of widening with new granular pavement for Safer Roads Sooner project.

# 3 Risk Assessment Methodology

## 3.1 Scope of SiD process

### 3.1.1 Scope

Identify, through consultation with key stakeholders, the possible WHS hazards and design risks that may occur during construction, operation, maintenance, and demolition of this project and advise on atypical or unique hazardous areas, including recommendation of mitigating measures, to reduce the WHS risks.

### 3.1.2 Structure

The detail contained in this report is drawn from the outcomes of Safety in Design consultations with key stakeholders for the design and construction of this project.

The key stakeholder disciplines for this project are: Designer, RPEQ, Construction Engineer, and Maintenance Engineer.

The outcomes of the SiD consultations are noted in Section 4 of this report.

### 3.1.3 Objectives

The objective of the Safety in Design consultations is to identify unusual or atypical features that could pose a risk to anyone carrying-out construction, operation, maintenance, and demolition of any areas on this project.

### 3.1.4 Risk Treatment

The risk assessment methodology adopted for this report involves identifying hazards, assessing the risks, controlling the risks and reviewing the control measures, based on the TMR Managing Safety Hazards and Risks Procedure.

## 4 SiDR Consultation Outcomes

SID consultation dates: 18/10/2019

Attendees: Vince Green (Project Manager & RPEQ)  
Mitch Curd (Maintenance Engineer)

Following a review of the detail design drawings for the project it was agreed that the project was a typical widening job designed using the latest road planning and design standards that could be constructed using typical construction practices.

There are no unique areas that would pose an unexpected hazard during construction, operation, maintenance, and demolition of this project.

## 5 Safety in Design Risk Categories

The following areas were considered for design risks:

- Roads and Drainage
- Geotechnical / Geology
- Hydraulics / Hydrology
- Public Utility Plant
- Environmental
- Electrical / Lighting
- Constructability
- Maintenance

## 6 Recommendations

There are no unique areas identified for this project that would require additional mitigating measures to standard WHS practices.

This report is to be provided as part of the handover documentation to the Contract Administrator for communication to the Contractor and reference in the Post Construction Report for Job No. 228/1632/1075873.

## 7 Attachments

None



# Project Scope Identification for an Infrastructure Type 3 project



**Source of funds:**  
(Program, line item in RIP)

Safer Roads Sooner

**Region/District:**

Wide Bay Burnett

**Local Government:**

Fraser Coast Regional Council

**Road Name (Section):**

1632 Booral Road

**Project Location:**

Start (Ch/TDist/Co-ord)	Finish (Ch/TDist/Co-ord)	Site No	Distance
TDist 4.65km	5.05km	3124	230m

**Project Number:**

TBA

**Existing conditions:**

Booral Road serves as an alternate entry into Hervey Bay and is connects to the airport and Fraser Island departures. The road serves a growing residential area catchment and incorporates various local road intersections which lead into Hervey Bay. The traffic volume of Booral Road has experienced higher than normal growth of around 4% over the past ten years, with additional growth planned as further areas to the south of Hervey Bay are developed. Booral Road has a speed limit of 100km/h at the intersection of Booral Rd and Woods Rd. The intersection of Woods Road is a main connection to Hervey Bay as it links directly to Urraween Road.

The intersection is give way priority controlled and has no turn lane facilities. Woods Road consists of a single lane approach and has a posted speed limit of 100km/h.

**Need for Project:**

This intersection is currently ranked as a District's medium priority in QRAM and has had an increasing number of crashes and near misses in recent years. Given the increase in population in this area this trend is anticipated to continue.

**Date of any damage:**

N/A

**Crash history:**

(7 June 2013- 6 June 2018)

There have been two recorded injury crashes in the most recent five years validated crash history at this location:.

- 104H, 1700, dry, - S/B Right turn from Woods Rd into Booral failed to GW
- 303MI, 1500, dry – W/B Right turn on Booral Rd was rear-ended

**AADT (% of heavy vehicles) (2017):**

1632 Tdist 0.0-6.484km 5,855 (11.73% HV).

Woods Rd – 1,656vpd total (from 12 hour count on 9/5/18)

**Deficiencies:**

- Lack of any right turn lane provision into Woods Rd (not even BAR standard)
- Lack of any left lane into Woods Road

• <b>Political and community issues:</b>	Has been in media.
• <b>Any associated works/projects:</b>	There are no planned projects in the vicinity of this proposal.
• <b>Other:</b> (provide photos where applicable):	Refer to photos below.
<b>Program Benefits/outcomes of proposed works:</b>	<ul style="list-style-type: none"> <li>• Improve turning traffic safely by providing protected turn lanes</li> <li>• Improving Booral Road traffic flow by eliminating need to slow for turning vehicles</li> </ul>

<b>Scope of proposed project:</b>	
• <b>In Scope:</b>	<ul style="list-style-type: none"> <li>• Provide CHR right turn lane</li> <li>• Provide AUL (S) left turn lane</li> <li>• Provide widening to accommodate turn lanes</li> </ul>
• <b>Out of Scope:</b>	<p>The following works are not within the current scope.</p> <ul style="list-style-type: none"> <li>• Repairs of existing pavement</li> <li>• Kerb or drainage alteration</li> </ul>
<b>Options considered:</b>	<ul style="list-style-type: none"> <li>• A CHR(S) option was considered but traffic volumes were very close to warrant a CHR so this was adopted to cater for future traffic increases.</li> </ul>
<b>Constraints:</b>	<ul style="list-style-type: none"> <li>• Verified cost estimate of \$325,000</li> </ul>
<b>Delivery method:</b>	MIC-SI (RoadTek)
<b>Safety assessment</b>	<p>Does the proposed work make any aspect of the road less safe? (e.g. <i>traffic moved closer to hazards, or approach speed to a tight curve increased</i>)</p> <p>No, <input checked="" type="checkbox"/> - <i>proceed with the design</i></p> <p>Yes, <input type="checkbox"/> - <i>do further mitigation work to achieve the appropriate level of safety.</i></p>
<b>Future operational performance:</b>	Improved access to the road, reduced crashes and increased main road efficiency due to less disruption of through traffic.
<b>Significant risks identified:</b>	No issues foreseen.
<b>Native Title/Environmental/Cultural Heritage concerns:</b>	Native title and cultural heritage are not a concern as works are in disturbed road corridor.
<b>Project Estimate:</b> (note contingency allowance)	\$325,000 (Including \$49K contingency)

Source Fund \$'000	Proposed expenditure flows				
	Prior Expenditure \$'000	2017-18 \$'000	2018-19 \$'000	2019-20 \$'000	Total \$'000
325	-	-	-	325	325



**Submitted (Project Manager)**

Name: Vince Green	Position: Senior Traffic Engineer
Signature: <span style="border: 1px solid red; padding: 2px;">Not Relevant</span>	Date: 20 / 7 / 2018

**Recommended (Program Manager/Sponsor- Principal Engineer/Advisor/Coordinator)**

Name: Brendan Clancy	Position: Manager (Delivery and Operations)
Signature: <span style="border: 1px solid red; padding: 2px;">Not Relevant</span>	Date: 26 / 7 / 18

Comments:

**Approved (Customer - M(PD&P), M(D&O) or M(PP&CM))**

Name: Hennie Roux	Position: District Director
Signature: <span style="border: 1px solid red; padding: 2px;">Not Relevant</span>	Date: 27 / 07 / 2018

Comments:

**Attachments:**

- A. Locality Map
- B. DVR Site Photos
- C. Cost Estimate
- D. Concept Design

Released under PTI - DMR

# APPENDIX A - LOCALITY MAP





## APPENDIX B – Site Photos

Tdist 4.630 km (WG) – eastbound approach to intersection



Tdist 5.010km (AG) – looking westbound towards intersection.





Tdist 4.850km (AG) – looking westbound towards intersection.



Woods Road – looking south towards Booral Rd





# APPENDIX C – Cost Estimate



Queensland Government

**Project Number : TBA**  
**Project Boundary : State Wide**  
**Asset Name : Booral Road**  
**Location : Woods Road intersection Tdist 4.76km**

NOTE: Estimate must be considered absolutely as the property of Transport and Main Roads until the acceptance of a tender, and must

## Stage : final - construction

### Stage : final - construction

#### Work Package : Construction - concept

Item Number	Description	Unit of Measure	Quantity	Unit Rate (\$)	Amount (\$)
<b>MRS02 Jul 17</b>					
20001.01	PROVISION FOR TRAFFIC	lump sum			\$20,000.00
<b>MRS03 Mar 18</b>					
	<b>DRAINAGE REMOVAL/DEMOLITION</b>				
30002	Removal or demolition of culvert end structures	lump sum			\$500.00
	<b>SUPPLY AND INSTALLATION OF CULVERTS</b>				
30251.01	Supply and installation of concrete pipe culvert components, Class 3, 900mm diameter	m			\$2,562.00
	<b>CONCRETE IN CULVERTS AND END STRUCTURES</b>				
30366.01	Precast concrete end structures to culverts, [1/900 RCP]	each			\$3,000.00
<b>MRS04 Jan 18</b>					
	<b>EARTHWORKS, PREPARATION</b>				
32001.01	Clearing and grubbing	m2			\$7,500.00
32003.01P	Stripping of topsoil (Provisional Quantity as directed)	m3			\$1,335.00
	<b>EARTHWORKS, EXCAVATION</b>				
32101.01	Road excavation, all materials	m3			\$16,800.00
	<b>EARTHWORKS, SUBGRADE</b>				
32306.01P	Subgrade treatment Type A	m2			\$6,280.00
32310.01P	Subgrade treatment Type B, replace with select fill material (Provisional Quantity if ordered) (250mm depth)	m3			\$12,000.00
<b>MRS05 Jul 17</b>					
	<b>UNBOUND PAVEMENTS</b>				
40002.01	Type 2.1 Unbound Pavement [200mm base]	m3			\$51,475.00
40004.01	Type 2.3 Unbound Pavement [150mm sub base]	m3			\$36,045.00
<b>MRS11 Oct 17</b>					
	<b>SPRAYED BITUMINOUS SURFACING (EXCLUDING EMULSION)</b>				
40802.01	Primerseal, grade [AMC7], spray rate [1.1], [excluding] supply of binder, [In widening]	litre			\$2,935.50
40803.01	Seal, class [C170], spray rate [1.2], [excluding] supply of binder, [In widening]	litre			\$2,668.75
40806.01	Spreading prime cover material [10mm], [120m2],	m3			\$2,400.00
40807.01	Spreading cover aggregate [14mm], [90m2],	m3			\$2,500.00
<b>MRS14 Mar 18</b>					

Sch.4 Part 4 s.7(1)(c) Bus/comm affairs

<b>REMOVAL, DEMOLITION AND RE-ERECTION</b>					
50002.01	Removal and salvage of road furniture, as listed in Clause 1.1 of Annexure MRTS14.1	lump sum			\$2,500.00
50003.01	Removal and re-erection of road furniture, as listed in Clause 4 of Annexure MRTS14.1	lump sum			\$2,000.00
<b>GUIDANCE AND INFORMATION SYSTEMS</b>					
50051.01	Road edge guide posts	each			\$1,200.00
50053.01	Supply of regulatory, warning and hazard sign faces. [sign type]	each			\$300.00
50057.01	Installation of regulatory, warning and hazard signs	lump sum			\$400.00
<b>MRS16</b>					
<b>GROUND PREPARATION WORKS - TOPSOIL</b>					
50803.01	Install topsoil [50mm] (Provisional Quantity as directed)	m2			\$8,750.00
<b>VEGETATION WORKS - SEEDING</b>					
50853.01P	Drill seeding [mix name] (Provisional Quantity as directed)	m2			\$1,750.00
<b>MRS22</b>					
<b>SUPPLY OF COVER AGGREGATE</b>					
41001.01	Supply of cover aggregate [precoated], [10] mm nominal size	m2			\$8,895.00
41002.01	Supply of cover aggregate [precoated], [14] mm nominal size	m2			\$1,779.00
<b>MRS28 Mar 18</b>					
20101.01	CONTRACTOR'S SITE FACILITIES AND CAMP	lump sum	Sch.4 Part 4 s.7(1)(c) Bus/comm affairs		\$10,000.00
<b>MRS45 Oct 17</b>					
<b>LINE MARKING</b>					
52101.01	Spotting only for longitudinal lines	m			\$2,467.50
52104.01	Barrier line, single, 100 mm wide	m			\$125.00
52110.01	Edge line, 150 mm wide, colour [colour], material [material]	m			\$1,600.00
52111.01	Continuity line, 200 mm wide, colour [colour], material [material]	m			\$750.00
52113.01	Outline, 150 mm wide, colour white material waterbourne	m			\$1,000.00
52116.01	Transverse lines (stop lines, holding lines, markings at Stop and Give Way signs, pedestrian crosswalk lines, arrows, shapes, symbols and numerals), colour [colour], material [material]	m2			\$810.00
52117.01	Transverse lines (diagonal and chevron markings, parking areas and kerb markings), colour [white], material [water borne type 3]	m2			\$28,350.00
<b>RAISED PAVEMENT MARKERS</b>					
52201.01	Retroreflective raised pavement markers	each			\$1,750.00
<b>MRS51 Jul 17</b>					
<b>ENVIRONMENTAL MANAGEMENT</b>					
20202.01	Develop Environmental Management Plan (Construction)	lump sum			\$1,000.00
20203.01	Implement Environmental Management Plan (Construction)	lump sum			\$1,500.00
<b>Work Package Total :</b>					<b>\$244,927.75</b>

**Work Package : preconstruction - PRECON**

Item Number	Description	Unit of Measure	Quantity	Unit Rate (\$)	Amount (\$)
<b>MRP06 Jul 17</b>					
<b>PROJECT STAGE MANAGEMENT (ALL STAGES)</b>					
15010.01	Project management - general (time, cost, quality, HR management)	lump sum			\$5,000.00



15070.01	Community engagement	lump sum		\$1,000.00
<b>MRP09 Jul 17</b>				
	<b>Public Utility Plant</b>			
18010.01	Public Utility Plant identification	lump sum		\$1,000.00
<b>MRP008 May 11</b>				
	<b>DESIGN INVESTIGATION REPORTS</b>			
18080.01	Engineering survey	lump sum	Sch.4 Part 4 s.7(1)(c) Bus/comm affairs	\$8,000.00
<b>MRP009 May 11</b>				
	<b>ENGAGE AND MANAGE DESIGN SERVICES</b>			
19100.01	Detailed road design	lump sum		\$15,000.00
<b>MRP011 Jul 17</b>				
	<b>PRINCIPAL'S OBLIGATIONS</b>			
19150.01	Portable long service leave, levies and fees.	lump sum		\$1,164.00
9001.01P	Contingency (provisional cost) (Provisional Quantity as directed)	lump sum		\$48,985.55
<b>Work Package Total :</b>				<b>\$80,149.55</b>
<b>Stage Total :</b>				<b>\$325,077.30</b>

Released under RTI / DTMP





View to Woods Road from about 300m east of the intersection.

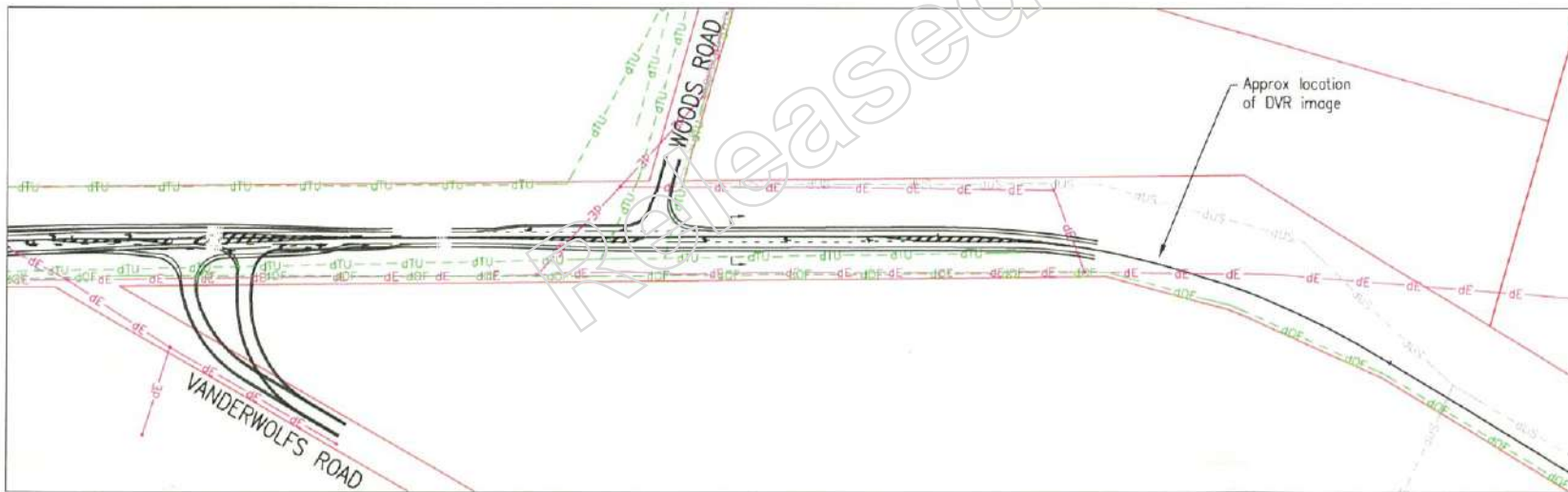
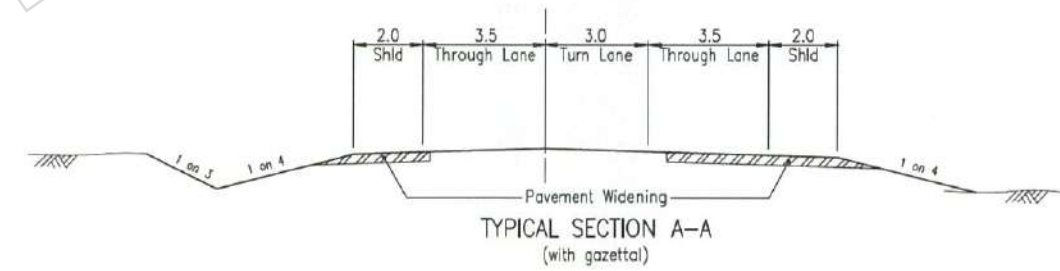

**NOTES:**

DESIGN SPEED: 110km/h  
 AADT: 5,105 vpd  
 HEAVY VEHICLES: 11%  
 THROUGH LANE WIDTH: 3.5m  
 SHOULDER WIDTH: 2.0m

TREATMENT: CHR  
 DECELERATION: 135m  
 LATERAL SHIFT (A): 95m  
 STORAGE: 20m  
 TAPER: 30m  
 RIGHT TURN LANE WIDTH: 3.0m

TREATMENT: AUL(S)  
 DECELERATION: 85m  
 TAPER: 30m  
 LEFT TURN LANE WIDTH: 3.0m  
 SHOULDER WIDTH: 1.0m

**NOTES:**

- Service locations are indicative only and derived from aerial photo and DBYD information.
- All layouts are conceptual with design based on an aerial photo only.
- Pavement design for widening to be determined in next project phase.

G				Associated Job Nos		Survey Data		Scales		FRASER COAST REGIONAL COUNCIL				INTERSECTION IMPROVEMENTS					
F				Datum				0 5 10 15 20m		1632				WOODS ROAD					
E				Auxiliary Drg Nos		Horiz. Grid				CTL CHGE				CHR AUL(S)				Job No.	
D						Height Origin				1.2 – 10.5 km				ENGINEERING CERTIFICATION (RPEQ)				Contract No.	
C						Survey Books		Dimensions shown in metres except where shown otherwise		Reference Points				NAME				Drawing No.	
B										Preceding RP				SIGNATURE				Series Number	
A				Issued For Construction						From start to end of job				NO.				of	
				Revisions/Descriptions		Certification		Date		From end to Following RP				DATE				MRR_Detail (02/14)	
										Through Chainage from									
CAD FILES				G:\BUND\TechServ\Planning\HBU\2017\1632\Autocad\1632 let Layouts.dwg															



JOINS PLAN No. 163544

JOINS PLAN No. 194148

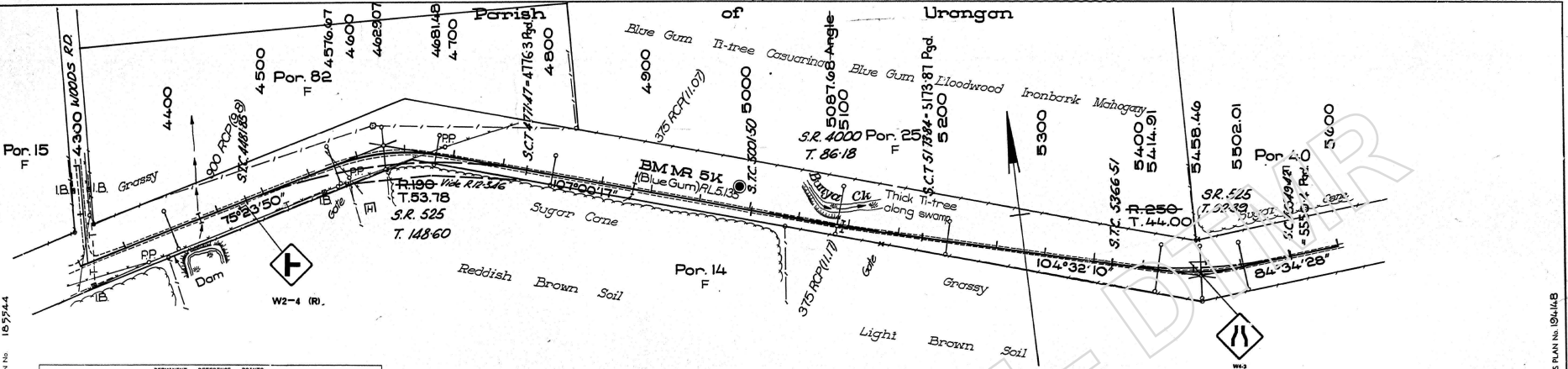

PRECEDING PRP NAME	PERMITS	REFERENCE POINTS	FOLLOWING PRP NAME
MS 772916 R	4-28	1-30	MS 862966 K

**Cameron McNamara**  
Cameron McNamara Pty Ltd  
(Incorporated in Queensland)

NR	Job no. 86-2387	Drawing no. 70455
----	-----------------	-------------------

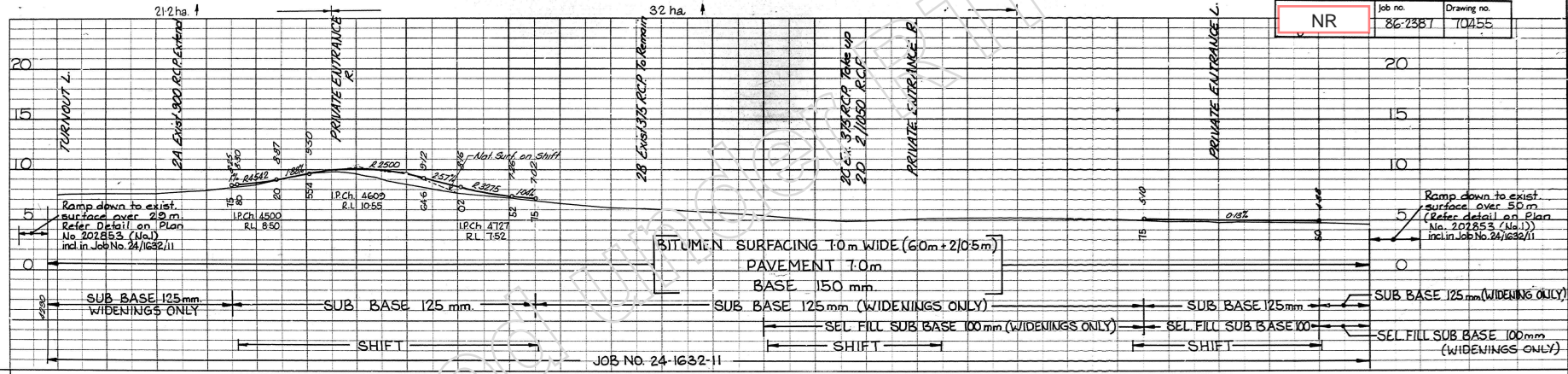

PVT MKGS TYPE	B		A						B		A		B		WIDEN FORMATION TO SUBGRADE
	W	R	3	83	466	334	250	100	23	20	48	59	80	WIDEN FORMATION TO SUBGRADE	
CUT	74.3	7.59	7.64	7.87	5.37	5.51	5.12	5.25	5.16	5.04	5.04	5.01	5.16		
EMBANK															
FILL															
GRADE LEVELS	4.300	5.07	4.400	5.07	4.500	5.37	5.51	5.12	5.25	5.16	5.04	5.04	5.01	5.16	
CHAINAGE	4.300	5.07	4.400	5.07	4.500	5.37	5.51	5.12	5.25	5.16	5.04	5.04	5.01	5.16	

THROUGH CHAINAGE FROM MARYBOROUGH - URANGON ROAD: 4.28 km - 5.78 km.

PGD CHGE 4 300 - 5 600

PLANNED D.K.B. 19/85

Checked: [Signature]

District Engineer: [Signature]

Asst Commissioner: [Signature]

Job No. 24-1632-11

Plan No. 194147

Scale: 1:1000

Design Speed: km/h



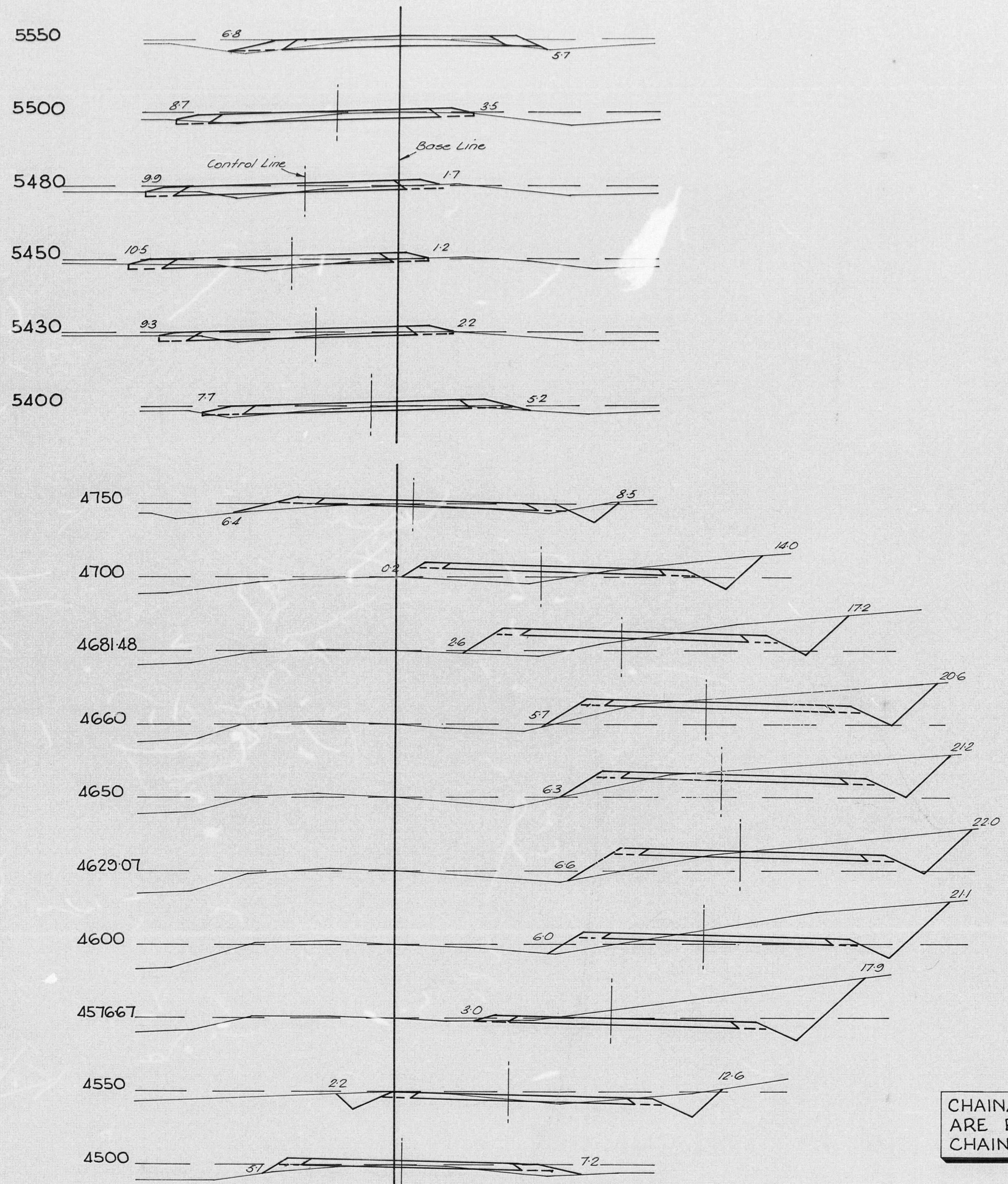

CROSS SECTIONS

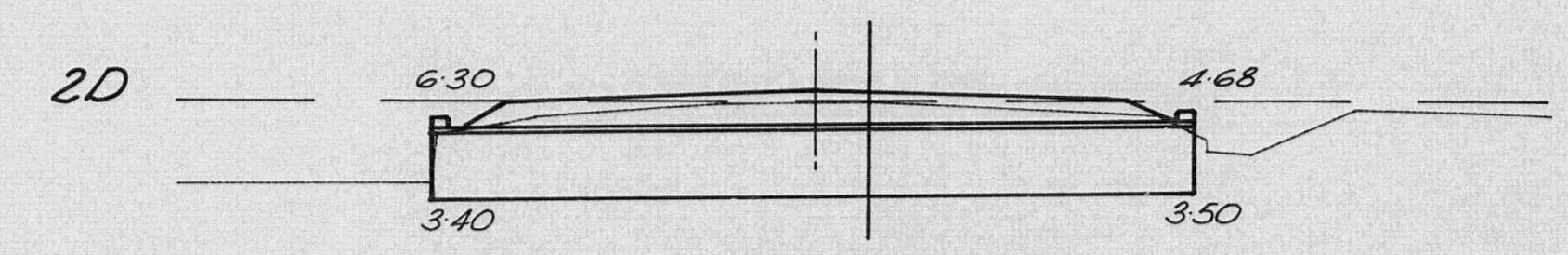

2/1050 R.C.P.(10.98m) 5093.5 (X)  
 DWG. 1124 & 1126  
 BACKFILL 47m<sup>3</sup> : EXCAV 140 15m<sup>3</sup>  
 WINGWALLS TYPE 1 (W<sub>1</sub>·W<sub>2</sub>-1700) CONC. 5.2m<sup>3</sup>  
 APRONS TYPE 1 - STONE PITCHING 10m<sup>2</sup>

2C. EXIST. 375 R.C.P. at 5093.5 : TAKE UP & STACK

2B. EXIST. 375 R.C.P. (9.9m) at 4882.4 : TO REMAIN

2A. EXIST. 900 R.C.P. (9.76m) at 4430 : EXTEND 1.22m R.  
 DWG. 1124 & 1126 : PROVIDE WINGWALLS & APRONS TO EXIST. ENDWALL ON L.H.S.  
 BACKFILL 5m<sup>3</sup> : EXCAV. 140 4m<sup>3</sup>  
 WINGWALLS TYPE 1 (W<sub>1</sub>·W<sub>2</sub>-1400) CONC. 2.8m<sup>3</sup>  
 APRONS TYPE 1 - STONE PITCHING 4m<sup>2</sup>

**DRAINAGE**

CHAINAGES SHOWN ARE BASE LINE CHAINAGES

**Cameron McNamara**  
 Cameron M'Namara Pty Ltd  
 (Incorporated in Queensland)

NR	Job no. 86-2387	Drawing no. 70456
----	-----------------	-------------------

Revisions	Issue Date	Microfited	Associated Job Nos	Dimensions in metres except where shown otherwise. Culvert sizes in millimetres.	THROUGH CHAINAGE FROM MARYBOROUGH - URANGAN RD.	MAIN ROADS DEPARTMENT	HERVEY BAY CITY	CROSS SECTIONS & DRAINAGE	JOB No. 24-1632-11
			Auxiliary Plan Nos 194147, 202853,4	SCALES 0 1 2 3 4 5 m	4.20 km 5.60 km		BOORAL ROAD		No. 3 OF 3 PLANS
				FULL SIZE A1	SURVEY BOOKS 1632-21,22		4290 - 5600		PLAN No. 202854
					PERMANENT REFERENCE POINTS			Boundaries	
					Preceding PRP Name	Dist. to Start of Job km	Dist. to End of Job km	Dist. from End to Following PRP km	Following PRP Name
					Not Relevant			Checked	
					Checked NEW			Checked NEW	
					30 Oct 86			28.11.86	
					District Engineer, Dist. 12			Asst Commissioner S.E.Q	
					17/12/86				



JOHN PLAN 287208

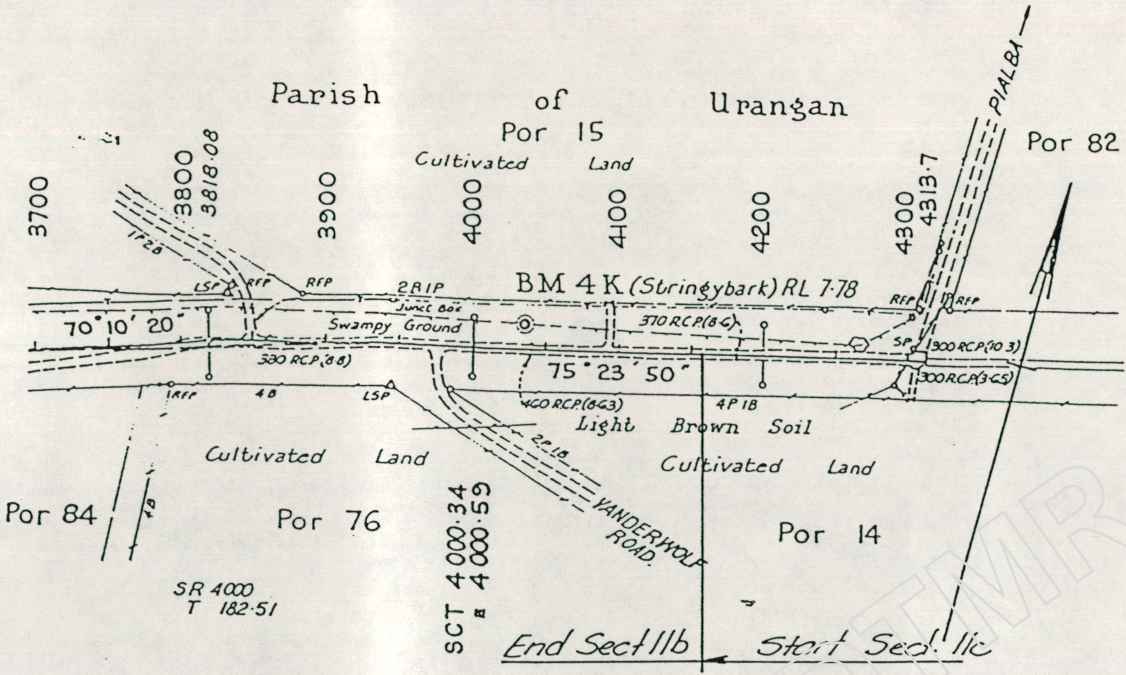

I certify that this is a true and accurate copy of the original drawing that has been lost

NR

8/12/17

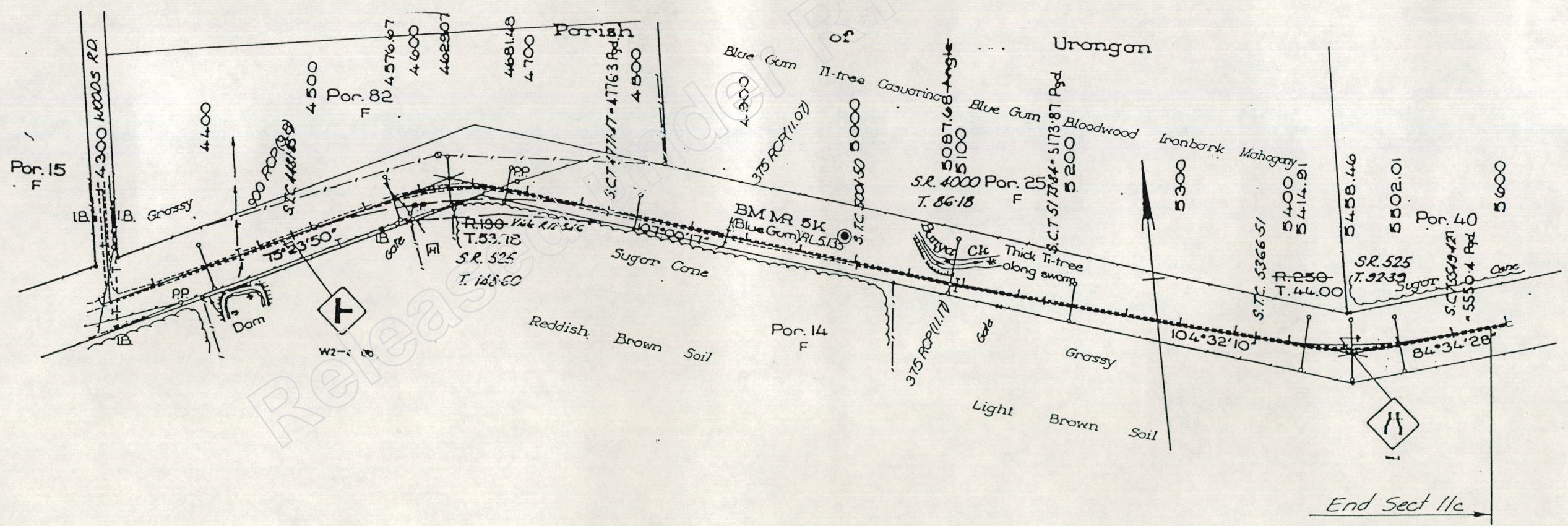

KEVIN CAMERON McNAMARA  
 Kinhill NR 8/97  
 A.C.N. 007 660 317

Revisions		Certified	Date	Microfiled	Associated job nos	Dimensions in metres except where shown otherwise Culvert sizes in millimetres	Survey books	HERVEY BAY CITY BOORAL ROAD				ALIGNMENT PLAN Sub Job No. 24/1632/B Sections 11a 11b & 11c - Sheet 2				DRAWING NUMBER .UC7300-127	
					Auxiliary plan nos 265546 - 265567 287168 - 287182	Scales 50.0 0 50.0 100.0 150.0 200.0 SCALE OF METRES	Through chainage from HERVEY BAY RD. 0.00km - 1.07km 3.05km - 4.16km 4.16km - 5.58km	0.00km-1.07km:3.05km-4.16km:4.16km-5.58km				Survey Blvs Drawn Design Examined Certified for Kinhill Ckd Ctd Ckd Ckd Ckd Ckd PKB PKB PKB // 2288 RPEO 15/8/97				REVISION CODE A	
A Original Issue				M.F.A	(Office use only)			Reference Points Preceding RPC Dist. to start of job (km) 0.00 Dist. from start to end of job (km) 5.58 Dist. from end to following RPC (km) 3.87 Following RPC 1632/2				JOB No. 24/163/723 No. 27 of 29 plans Plan No. 287209					



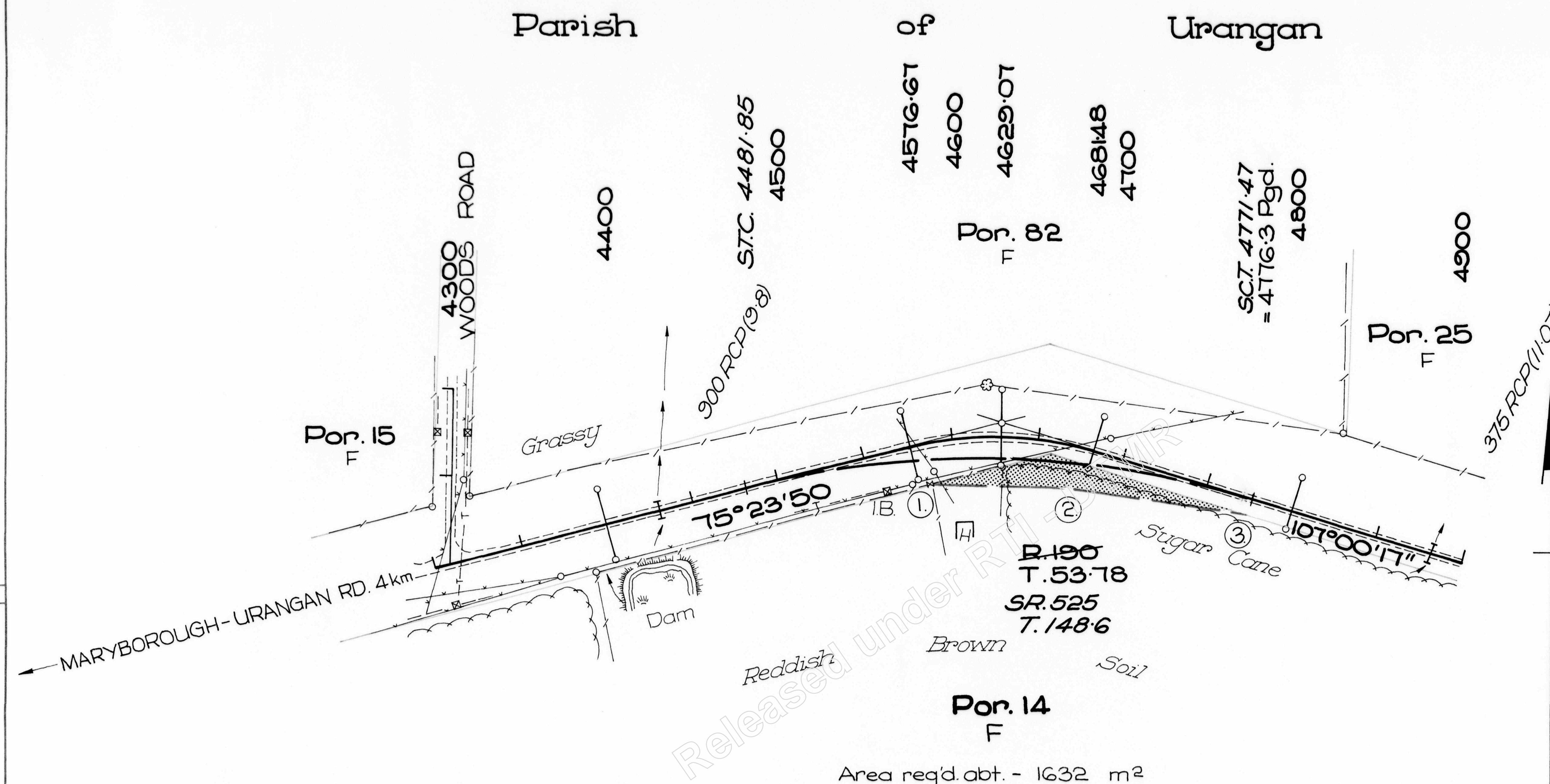

MRD Drawing No:  
434072  
MF 06.08A

Dist. (m) FROM PEGGED BASE LINE TO NEW BOUNDARY	
1.	On bdy. abt. 24m opp. 4583 approx.
2.	24m opp. 4672
3.	On bdy. abt. 10m opp. 4716.3

OFFSET PEGS	
CHAINAGE	DISTANCE (m)
4400	20 L
	20 R
4576.67	20 L
	20 R
4629.07	27 L
	16.5 R
4681.48	20 L
	10 R
4800	20 L
	10 R

Length dimensions are given in metres. Areas are given in hectares (ha) or square metres (m<sup>2</sup>). 1 ha = 10 000 m<sup>2</sup>.

Revisions Issue date Microfiled Dimension in metres except where shown otherwise FULL SIZE A2 1:2000 0 20 40 60 80 m	Property description Plan showing area required from:- Por. 14	Drawn: AKD 6/86 Requirements: NR Checked: NR	MAIN ROADS DEPT. HERVEY BAY CITY BOORAL ROAD	AUTH. No. 24/1632/126
	Parish of Urangan County of March	FLD. BK: 1632-21 W. PLANS: 194147 L.S. PLANS: M3T.49, M.374T, Mch. 1568, M.3748, M.37.214.	Aux. R. Plans:	Job No.: 24/1632/11 No. 1 OF 1 PLANS
	District Engineer, DIST. 12	RECOMMENDED: NR	APPROVED: NR 27/6/86	PLAN No. <b>R12-346</b>
	Original issue 5-7-86	DISTRICT ENGINEER, DIST. 12	DIVISIONAL ENGINEER SEQ	A



Released under RTI - DTMR

PARAMETERS:

Contract Office  
 Claim Date Start 1-Jan-17  
 Claim Date End 31-Jan-22  
 Contract DC\_16\_17.12, DC\_17\_18, DC\_18\_19, DC\_19\_20, DC\_20\_21, DC\_21\_22  
 Schedules  
 Road Sections 1632  
 Tdist\_Start 4.8  
 Tdist End 5.4  
 WO Ref Num  
 Activities  
 Elements  
 Display Old Activ N

DATA:

Road Section	Status	Funding Element	TDist Start	TDist End	Fund	Schedule	Activity Type	Activity Description	Part	Sub Activity Type	Payment Method	Quantity	Claimed	Claim Start	Claim End	WO Ref Num
1632 C		15	0	18.393	2	3	105	Pothole Patching	0	-	U		\$ 1,027.33	22-Feb-17	24-Mar-17	2019590
1632 C		15	0	18.393	2	3	105	Pothole Patching	0	-	U		\$ 179.73	25-Mar-17	20-Apr-17	2020513
1632 C		15	0	18.393	2	3	105	Pothole Patching	0	-	U		\$ 565.90	21-Apr-17	24-May-17	2023624
1632 C		15	0	18.393	2	3	105	Pothole Patching	0	-	U		\$ 700.96	25-May-17	23-Jun-17	2024803
1632 C		15	0	18.393	2	3	105	Pothole Patching	0	-	U		\$ 1,258.27	24-Jun-17	30-Jun-17	2026944
1632 C		15	0	18.393	2	3	401	Tractor Slashing, Rural	0	-	U		\$ 4,680.00	21-Apr-17	24-May-17	2023624
1632 C		15	0	18.393	2	3	407	Herbicide Spraying	0	-	U		\$ 4,255.00	25-May-17	23-Jun-17	2024803
1632 C		15	0	18.393	2	3	420	Roadside Litter Collection - Rural	0	P	F		\$ 76.01	24-Jan-17	21-Feb-17	2018502
1632 C		15	0	18.393	2	3	420	Roadside Litter Collection - Rural	0	P	F		\$ 339.36	22-Feb-17	24-Mar-17	2019590
1632 C		15	0	18.393	2	3	420	Roadside Litter Collection - Rural	0	P	F		\$ 1,241.51	25-Mar-17	20-Apr-17	2020513
1632 C		15	0	18.393	2	3	420	Roadside Litter Collection - Rural	0	P	F		\$ 1,293.12	21-Apr-17	24-May-17	2023624
1632 C		15	0	18.393	2	3	420	Roadside Litter Collection - Rural	0	P	F		\$ 930.00	24-Jun-17	30-Jun-17	2026944
1632 C		15	0	18.393	2	3	512	Repair or Replace Guide Markers	0	P	F		\$ 137.64	22-Feb-17	24-Mar-17	2019590
1632 C		15	0	18.393	2	3	512	Repair or Replace Guide Markers	0	P	F		\$ 580.57	25-Mar-17	20-Apr-17	2020513
1632 C		15	0	18.393	2	3	519	Other Road Guide Post and Marker Wo<	0	P	F		\$ 76.01	24-Jan-17	21-Feb-17	2018502
1632 C		15	0	18.393	2	3	519	Other Road Guide Post and Marker Wo<	0	P	F		\$ 598.12	22-Feb-17	24-Mar-17	2019590
1632 C		15	0	18.393	2	3	519	Other Road Guide Post and Marker Wo<	0	P	F		\$ 342.83	25-Mar-17	20-Apr-17	2020513
1632 C		15	0	18.393	2	3	519	Other Road Guide Post and Marker Wo<	0	P	F		\$ 373.08	21-Apr-17	24-May-17	2023624
1632 C		15	0	18.393	2	3	519	Other Road Guide Post and Marker Wo<	0	P	F		\$ 93.71	24-Jun-17	30-Jun-17	2026944
1632 C		15	0	18.393	2	3	903	Inspections for Forward List of Work	0	P	F		\$ 92.25	24-Jan-17	21-Feb-17	2018502
1632 C		15	0	18.393	2	3	903	Inspections for Forward List of Work	0	P	F		\$ 92.25	22-Feb-17	24-Mar-17	2019590
1632 C		15	0	18.393	2	3	903	Inspections for Forward List of Work	0	P	F		\$ 564.57	25-Mar-17	20-Apr-17	2020513
1632 C		15	0	18.393	2	3	903	Inspections for Forward List of Work	0	P	F		\$ 630.38	21-Apr-17	24-May-17	2023624
1632 C		15	0	18.393	2	3	903	Inspections for Forward List of Work	0	P	F		\$ 313.65	25-May-17	23-Jun-17	2024803
1632 C		34	0	18.393	2	3	452	Emergency Call Out Activities	0	P	F		\$ 3,719.66	25-Mar-17	20-Apr-17	2020513
1632 C		34	3.8	6.1	2	3	452	Emergency Call Out Activities	0	P	F		\$ 1,888.15	22-Feb-17	24-Mar-17	2019590
1632 C		15	0	18.393	2	3	105	Pothole Patching	0	-	U		\$ 1,666.26	22-Feb-18	22-Mar-18	1159690
1632 C		15	0	18.393	2	3	105	Pothole Patching	0	-	U		\$ 1,546.20	23-Mar-18	20-Apr-18	1168064
1632 C		15	0	18.393	2	3	105	Pothole Patching	0	-	U		\$ 2,421.94	21-Apr-18	24-May-18	1175277
1632 C		15	0	18.393	2	3	105	Pothole Patching	0	-	U		\$ 563.70	25-May-18	17-Jun-18	1184555
1632 C		15	0	18.393	2	3	105	Pothole Patching	0	-	U		\$ 827.98	18-Jun-18	30-Jun-18	1191155
1632 C		15	0	18.393	2	3	105	Pothole Patching	0	-	U		\$ 1,733.61	1-Jul-17	24-Jul-17	2031636
1632 C		15	0	18.393	2	3	105	Pothole Patching	0	-	U		\$ 5,554.46	25-Jul-17	24-Aug-17	2032521
1632 C		15	0	18.393	2	3	105	Pothole Patching	0	-	U		\$ 1,237.95	25-Aug-17	22-Sep-17	2032579
1632 C		15	0	18.393	2	3	105	Pothole Patching	0	-	U		\$ 2,797.13	23-Sep-17	24-Oct-17	2041177
1632 C		15	0	18.393	2	3	105	Pothole Patching	0	-	U		\$ 1,649.73	24-Nov-17	15-Dec-17	2048261
1632 C		15	0	18.393	2	3	105	Pothole Patching	0	-	U		\$ 931.64	16-Dec-17	23-Jan-18	2051423
1632 C		15	0	18.393	2	3	105	Pothole Patching	0	-	U		\$ 1,096.11	24-Jan-18	21-Feb-18	2056835
1632 C		15	0	18.393	2	3	401	Tractor Slashing, Rural	0	-	U		\$ 4,770.00	25-May-18	17-Jun-18	1170129
1632 C		15	0	18.393	2	3	401	Tractor Slashing, Rural	0	-	U		\$ 4,770.00	24-Jan-18	21-Feb-18	2051420
1632 C		15	0	18.393	2	3	407	Herbicide Spraying	0	-	U		\$ 5,100.00	21-Apr-18	24-May-18	1173657
1632 C		15	0	18.393	2	3	407	Herbicide Spraying	0	-	U		\$ 1,360.00	16-Dec-17	23-Jan-18	2048399
1632 C		15	0	18.393	2	3	420	Roadside Litter Collection - Rural	0	P	F		\$ 613.29	22-Feb-18	22-Mar-18	1159689
1632 C		15	0	18.393	2	3	420	Roadside Litter Collection - Rural	0	P	F		\$ 491.29	23-Mar-18	20-Apr-18	1168063
1632 C		15	0	18.393	2	3	420	Roadside Litter Collection - Rural	0	P	F		\$ 232.51	21-Apr-18	24-May-18	1175276
1632 C		15	0	18.393	2	3	420	Roadside Litter Collection - Rural	0	P	F		\$ 936.20	18-Jun-18	30-Jun-18	1191154
1632 C		15	0	18.393	2	3	420	Roadside Litter Collection - Rural	0	P	F		\$ 818.52	1-Jul-17	24-Jul-17	2031637
1632 C		15	0	18.393	2	3	420	Roadside Litter Collection - Rural	0	P	F		\$ 843.52	25-Jul-17	24-Aug-17	2032520
1632 C		15	0	18.393	2	3	420	Roadside Litter Collection - Rural	0	P	F		\$ 424.19	25-Aug-17	22-Sep-17	2032580
1632 C		15	0	18.393	2	3	420	Roadside Litter Collection - Rural	0	P	F		\$ 471.07	24-Nov-17	15-Dec-17	2048261
1632 C		15	0	18.393	2	3	420	Roadside Litter Collection - Rural	0	P	F		\$ 1,610.05	16-Dec-17	23-Jan-18	2051423
1632 C		15	0	18.393	2	3	420	Roadside Litter Collection - Rural	0	P	F		\$ 823.93	24-Jan-18	21-Feb-18	2056835
1632 C		15	0	18.393	2	3	512	Repair or Replace Guide Markers	0	P	F		\$ 151.54	23-Mar-18	20-Apr-18	1168066
1632 C		15	0	18.393	2	3	512	Repair or Replace Guide Markers	0	P	F		\$ 438.02	21-Apr-18	24-May-18	1175279
1632 C		15	0	18.393	2	3	512	Repair or Replace Guide Markers	0	P	F		\$ 85.58	25-May-18	17-Jun-18	1184557
1632 C		15	0	18.393	2	3	512	Repair or Replace Guide Markers	0	P	F		\$ 800.44	1-Jul-17	24-Jul-17	2031638

Bus/comm affairs

1632 C	15	0	18.393	2	3	512	Repair or Replace Guide Markers	0	P	F		\$ 1,066.84	25-Jul-17	24-Aug-17	2032519
1632 C	15	0	18.393	2	3	512	Repair or Replace Guide Markers	0	P	F		\$ 234.14	25-Aug-17	22-Sep-17	2032577
1632 C	15	0	18.393	2	3	512	Repair or Replace Guide Markers	0	P	F		\$ 926.09	24-Jan-18	21-Feb-18	2056835
1632 C	15	0	18.393	2	3	519	Other Road Guide Post and Marker Wo<	0	P	F		\$ 86.80	22-Feb-18	22-Mar-18	1159691
1632 C	15	0	18.393	2	3	519	Other Road Guide Post and Marker Wo<	0	P	F		\$ 85.58	21-Apr-18	24-May-18	1175278
1632 C	15	0	18.393	2	3	519	Other Road Guide Post and Marker Wo<	0	P	F		\$ 85.58	25-May-18	17-Jun-18	1184556
1632 C	15	0	18.393	2	3	519	Other Road Guide Post and Marker Wo<	0	P	F		\$ 172.02	18-Jun-18	30-Jun-18	1191156
1632 C	15	0	18.393	2	3	519	Other Road Guide Post and Marker Wo<	0	P	F		\$ 1,023.15	1-Jul-17	24-Jul-17	2031635
1632 C	15	0	18.393	2	3	519	Other Road Guide Post and Marker Wo<	0	P	F		\$ 1,320.20	25-Jul-17	24-Aug-17	2032522
1632 C	15	0	18.393	2	3	519	Other Road Guide Post and Marker Wo<	0	P	F		\$ 409.26	25-Aug-17	22-Sep-17	2032578
1632 C	15	0	18.393	2	3	519	Other Road Guide Post and Marker Wo<	0	P	F		\$ 166.87	25-Oct-17	23-Nov-17	2044205
1632 C	15	0	18.393	2	3	519	Other Road Guide Post and Marker Wo<	0	P	F		\$ 83.44	16-Dec-17	23-Jan-18	2051423
1632 C	15	0	18.393	2	3	519	Other Road Guide Post and Marker Wo<	0	P	F		\$ 910.67	24-Jan-18	21-Feb-18	2056835
1632 C	15	0	18.393	2	3	903	Inspections for Forward List of Work	0	P	F		\$ 81.25	22-Feb-18	22-Mar-18	1159688
1632 C	15	0	18.393	2	3	903	Inspections for Forward List of Work	0	P	F		\$ 820.82	23-Mar-18	20-Apr-18	1168062
1632 C	15	0	18.393	2	3	903	Inspections for Forward List of Work	0	P	F		\$ 761.83	21-Apr-18	24-May-18	1175275
1632 C	15	0	18.393	2	3	903	Inspections for Forward List of Work	0	P	F		\$ 344.04	25-May-18	17-Jun-18	1184553
1632 C	15	0	18.393	2	3	903	Inspections for Forward List of Work	0	P	F		\$ 892.83	18-Jun-18	30-Jun-18	1191153
1632 C	15	0	18.393	2	3	903	Inspections for Forward List of Work	0	P	F		\$ 45.32	1-Jul-17	24-Jul-17	2031639
1632 C	15	0	18.393	2	3	903	Inspections for Forward List of Work	0	P	F		\$ 90.65	25-Jul-17	24-Aug-17	2032518
1632 C	15	0	18.393	2	3	903	Inspections for Forward List of Work	0	P	F		\$ 90.65	25-Aug-17	22-Sep-17	2032581
1632 C	15	0	18.393	2	3	903	Inspections for Forward List of Work	0	P	F		\$ 883.02	23-Sep-17	24-Oct-17	2041177
1632 C	15	0	18.393	2	3	903	Inspections for Forward List of Work	0	P	F		\$ 453.23	25-Oct-17	23-Nov-17	2044205
1632 C	15	0	18.393	2	3	903	Inspections for Forward List of Work	0	P	F		\$ 135.97	24-Nov-17	15-Dec-17	2048261
1632 C	15	0	18.393	2	3	903	Inspections for Forward List of Work	0	P	F		\$ 345.99	16-Dec-17	23-Jan-18	2051423
1632 C	15	1.63	6	2	3	405	Clearing	0	P	F		\$ 4,352.59	22-Feb-18	22-Mar-18	1165906
1632 C	15	1.63	6	2	3	405	Clearing	0	P	F		\$ 488.00	23-Mar-18	20-Apr-18	1170145
1632 C	15	4.745	4.98	2	3	146	Pavement Repairs, Asphalt (Mech. <500m	2	-	U		\$ 36,960.00	25-Oct-17	23-Nov-17	2042455
1632 C	15	0	18.393	2	3	105	Pothole Patching	0	-	U		\$ 1,681.79	1-Jul-18	24-Jul-18	1193804
1632 C	15	0	18.393	2	3	105	Pothole Patching	0	-	U		\$ 1,010.13	25-Jul-18	24-Aug-18	1199264
1632 C	15	0	18.393	2	3	105	Pothole Patching	0	-	U		\$ 1,059.75	25-Aug-18	21-Sep-18	1208662
1632 C	15	0	18.393	2	3	105	Pothole Patching	0	-	U		\$ 1,071.72	22-Sep-18	24-Oct-18	1218487
1632 C	15	0	18.393	2	3	105	Pothole Patching	0	-	U		\$ 483.92	25-Oct-18	23-Nov-18	1229537
1632 C	15	0	18.393	2	3	105	Pothole Patching	0	-	U		\$ 864.68	24-Nov-18	14-Dec-18	1238596
1632 C	15	0	18.393	2	3	105	Pothole Patching	0	-	U		\$ 1,397.31	15-Dec-18	23-Jan-19	1246763
1632 C	15	0	18.393	2	3	105	Pothole Patching	0	-	U		\$ 149.42	24-Jan-19	21-Feb-19	1251961
1632 C	15	0	18.393	2	3	105	Pothole Patching	0	-	U		\$ 578.50	22-Feb-19	22-Mar-19	1258894
1632 C	15	0	18.393	2	3	105	Pothole Patching	0	-	U		\$ 209.63	23-Mar-19	18-Apr-19	1268172
1632 C	15	0	18.393	2	3	105	Pothole Patching	0	-	U		\$ 634.96	19-Apr-19	22-May-19	1275842
1632 C	15	0	18.393	2	3	105	Pothole Patching	0	-	U		\$ 385.09	23-May-19	21-Jun-19	1283664
1632 C	15	0	18.393	2	3	105	Pothole Patching	0	-	U		\$ 842.49	22-Jun-19	30-Jun-19	1292056
1632 C	15	0	18.393	2	3	401	Tractor Slashing, Rural	0	-	U		\$ 4,770.00	25-Oct-18	23-Nov-18	1229753
1632 C	15	0	18.393	2	3	401	Tractor Slashing, Rural	0	-	U		\$ 4,770.00	23-May-19	21-Jun-19	1274529
1632 C	15	0	18.393	2	3	407	Herbicide Spraying	0	-	U		\$ 2,380.00	15-Dec-18	23-Jan-19	1229747
1632 C	15	0	18.393	2	3	407	Herbicide Spraying	0	-	U		\$ 1,190.00	24-Jan-19	21-Feb-19	1258022
1632 C	15	0	18.393	2	3	407	Herbicide Spraying	0	-	U		\$ 3,230.00	23-May-19	21-Jun-19	1274531
1632 C	15	0	18.393	2	3	420	Roadside Litter Collection - Rural	0	P	F		\$ 762.19	1-Jul-18	24-Jul-18	1193803
1632 C	15	0	18.393	2	3	420	Roadside Litter Collection - Rural	0	P	F		\$ 1,185.63	25-Jul-18	24-Aug-18	1199263
1632 C	15	0	18.393	2	3	420	Roadside Litter Collection - Rural	0	P	F		\$ 266.51	25-Aug-18	21-Sep-18	1208661
1632 C	15	0	18.393	2	3	420	Roadside Litter Collection - Rural	0	P	F		\$ 241.61	22-Sep-18	24-Oct-18	1218486
1632 C	15	0	18.393	2	3	420	Roadside Litter Collection - Rural	0	P	F		\$ 169.38	25-Oct-18	23-Nov-18	1229536
1632 C	15	0	18.393	2	3	420	Roadside Litter Collection - Rural	0	P	F		\$ 488.84	24-Nov-18	14-Dec-18	1238595
1632 C	15	0	18.393	2	3	420	Roadside Litter Collection - Rural	0	P	F		\$ 634.04	22-Feb-19	22-Mar-19	1258893
1632 C	15	0	18.393	2	3	420	Roadside Litter Collection - Rural	0	P	F		\$ 172.43	23-Mar-19	18-Apr-19	1268171
1632 C	15	0	18.393	2	3	420	Roadside Litter Collection - Rural	0	P	F		\$ 746.27	22-Jun-19	30-Jun-19	1292055
1632 C	15	0	18.393	2	3	512	Repair or Replace Guide Markers	0	P	F		\$ 113.98	1-Jul-18	24-Jul-18	1193805
1632 C	15	0	18.393	2	3	512	Repair or Replace Guide Markers	0	P	F		\$ 521.34	25-Jul-18	24-Aug-18	1199265
1632 C	15	0	18.393	2	3	512	Repair or Replace Guide Markers	0	P	F		\$ 257.26	25-Aug-18	21-Sep-18	1208663
1632 C	15	0	18.393	2	3	512	Repair or Replace Guide Markers	0	P	F		\$ 274.97	22-Sep-18	24-Oct-18	1218488
1632 C	15	0	18.393	2	3	512	Repair or Replace Guide Markers	0	P	F		\$ 100.73	24-Nov-18	14-Dec-18	1238597
1632 C	15	0	18.393	2	3	512	Repair or Replace Guide Markers	0	P	F		\$ 213.19	15-Dec-18	23-Jan-19	1246764
1632 C	15	0	18.393	2	3	512	Repair or Replace Guide Markers	0	P	F		\$ 375.22	24-Jan-19	21-Feb-19	1251962
1632 C	15	0	18.393	2	3	512	Repair or Replace Guide Markers	0	P	F		\$ 125.32	22-Feb-19	22-Mar-19	1258895
1632 C	15	0	18.393	2	3	512	Repair or Replace Guide Markers	0	P	F		\$ 121.91	19-Apr-19	22-May-19	1275843
1632 C	15	0	18.393	2	3	519	Other Road Guide Post and Marker Wo<	0	P	F		\$ 266.51	1-Jul-18	24-Jul-18	1193802
1632 C	15	0	18.393	2	3	519	Other Road Guide Post and Marker Wo<	0	P	F		\$ 749.74	25-Jul-18	24-Aug-18	1199262
1632 C	15	0	18.393	2	3	519	Other Road Guide Post and Marker Wo<	0	P	F		\$ 326.30	25-Aug-18	21-Sep-18	1208660
1632 C	15	0	18.393	2	3	519	Other Road Guide Post and Marker Wo<	0	P	F		\$ 362.42	22-Sep-18	24-Oct-18	1218485
1632 C	15	0	18.393	2	3	519	Other Road Guide Post and Marker Wo<	0	P	F		\$ 84.69	25-Oct-18	23-Nov-18	1229535
1632 C	15	0	18.393	2	3	519	Other Road Guide Post and Marker Wo<	0	P	F		\$ 531.80	24-Nov-18	14-Dec-18	1238594
1632 C	15	0	18.393	2	3	519	Other Road Guide Post and Marker Wo<	0	P	F		\$ 431.06	15-Dec-18	23-Jan-19	1246761
1632 C	15	0	18.393	2	3	519	Other Road Guide Post and Marker Wo<	0	P	F		\$ 432.58	24-Jan-19	21-Feb-19	1251959
1632 C	15	0	18.393	2	3	519	Other Road Guide Post and Marker Wo<	0	P	F		\$ 582.62	22-Feb-19	22-Mar-19	1258892
1632 C	15	0	18.393	2	3	519	Other Road Guide Post and Marker Wo<	0	P	F		\$ 86.21	23-Mar-19	18-Apr-19	1268170

Bus/comm affairs



1632 C	15	0	18.393	2	3	519	Other Road Guide Post and Marker Wo<	0	P	F	\$ 243.82	19-Apr-19	22-May-19	1275840
1632 C	15	0	18.393	2	3	519	Other Road Guide Post and Marker Wo<	0	P	F	\$ 172.43	23-May-19	21-Jun-19	1283662
1632 C	15	0	18.393	2	3	903	Inspections for Forward List of Work	0	P	F	\$ 390.65	1-Jul-18	24-Jul-18	1193801
1632 C	15	0	18.393	2	3	903	Inspections for Forward List of Work	0	P	F	\$ 689.34	25-Jul-18	24-Aug-18	1199261
1632 C	15	0	18.393	2	3	903	Inspections for Forward List of Work	0	P	F	\$ 683.89	25-Aug-18	21-Sep-18	1208659
1632 C	15	0	18.393	2	3	903	Inspections for Forward List of Work	0	P	F	\$ 240.97	22-Sep-18	24-Oct-18	1218484
1632 C	15	0	18.393	2	3	903	Inspections for Forward List of Work	0	P	F	\$ 328.39	25-Oct-18	23-Nov-18	1229534
1632 C	15	0	18.393	2	3	903	Inspections for Forward List of Work	0	P	F	\$ 879.04	24-Nov-18	14-Dec-18	1238593
1632 C	15	0	18.393	2	3	903	Inspections for Forward List of Work	0	P	F	\$ 3,757.70	15-Dec-18	23-Jan-19	1246760
1632 C	15	0	18.393	2	3	903	Inspections for Forward List of Work	0	P	F	\$ 469.38	24-Jan-19	21-Feb-19	1251958
1632 C	15	0	18.393	2	3	903	Inspections for Forward List of Work	0	P	F	\$ 494.53	22-Feb-19	22-Mar-19	1258891
1632 C	15	0	18.393	2	3	903	Inspections for Forward List of Work	0	P	F	\$ 572.94	23-Mar-19	18-Apr-19	1268169
1632 C	15	0	18.393	2	3	903	Inspections for Forward List of Work	0	P	F	\$ 343.04	19-Apr-19	22-May-19	1275839
1632 C	15	0	18.393	2	3	903	Inspections for Forward List of Work	0	P	F	\$ 378.73	23-May-19	21-Jun-19	1283661
1632 C	15	5.36	5.44	2	3	153	Insitu Stabilisation-Minor (<500m2)	0	-	U	\$ 7,290.00	19-Apr-19	22-May-19	1019784
1632 C	34	0	18.393	2	4	450	Call Out	0	P	F	\$ 275.88	25-Jul-18	24-Aug-18	1207903
1632 C	15	0	18.393	2	3	105	Pothole Patching	0	-	U	\$ 1,681.79	1-Jul-18	24-Jul-18	1193804
1632 C	15	0	18.393	2	3	105	Pothole Patching	0	-	U	\$ 1,010.13	25-Jul-18	24-Aug-18	1199264
1632 C	15	0	18.393	2	3	105	Pothole Patching	0	-	U	\$ 1,059.75	25-Aug-18	21-Sep-18	1208662
1632 C	15	0	18.393	2	3	105	Pothole Patching	0	-	U	\$ 1,071.72	22-Sep-18	24-Oct-18	1218487
1632 C	15	0	18.393	2	3	105	Pothole Patching	0	-	U	\$ 483.92	25-Oct-18	23-Nov-18	1229537
1632 C	15	0	18.393	2	3	105	Pothole Patching	0	-	U	\$ 864.68	24-Nov-18	14-Dec-18	1238596
1632 C	15	0	18.393	2	3	105	Pothole Patching	0	-	U	\$ 1,397.31	15-Dec-18	23-Jan-19	1246763
1632 C	15	0	18.393	2	3	105	Pothole Patching	0	-	U	\$ 149.42	24-Jan-19	21-Feb-19	1251961
1632 C	15	0	18.393	2	3	105	Pothole Patching	0	-	U	\$ 578.50	22-Feb-19	22-Mar-19	1258894
1632 C	15	0	18.393	2	3	105	Pothole Patching	0	-	U	\$ 209.63	23-Mar-19	18-Apr-19	1268172
1632 C	15	0	18.393	2	3	105	Pothole Patching	0	-	U	\$ 634.96	19-Apr-19	22-May-19	1275842
1632 C	15	0	18.393	2	3	105	Pothole Patching	0	-	U	\$ 385.09	23-May-19	21-Jun-19	1283664
1632 C	15	0	18.393	2	3	105	Pothole Patching	0	-	U	\$ 842.49	22-Jun-19	30-Jun-19	1292056
1632 C	15	0	18.393	2	3	401	Tractor Slashing, Rural	0	-	U	\$ 4,770.00	25-Oct-18	23-Nov-18	1229753
1632 C	15	0	18.393	2	3	401	Tractor Slashing, Rural	0	-	U	\$ 4,770.00	23-May-19	21-Jun-19	1274529
1632 C	15	0	18.393	2	3	407	Herbicide Spraying	0	-	U	\$ 2,380.00	15-Dec-18	23-Jan-19	1229747
1632 C	15	0	18.393	2	3	407	Herbicide Spraying	0	-	U	\$ 1,190.00	24-Jan-19	21-Feb-19	1258022
1632 C	15	0	18.393	2	3	407	Herbicide Spraying	0	-	U	\$ 3,230.00	23-May-19	21-Jun-19	1274531
1632 C	15	0	18.393	2	3	420	Roadside Litter Collection - Rural	0	P	F	\$ 762.19	1-Jul-18	24-Jul-18	1193803
1632 C	15	0	18.393	2	3	420	Roadside Litter Collection - Rural	0	P	F	\$ 1,185.63	25-Jul-18	24-Aug-18	1199263
1632 C	15	0	18.393	2	3	420	Roadside Litter Collection - Rural	0	P	F	\$ 266.51	25-Aug-18	21-Sep-18	1208661
1632 C	15	0	18.393	2	3	420	Roadside Litter Collection - Rural	0	P	F	\$ 241.61	22-Sep-18	24-Oct-18	1218486
1632 C	15	0	18.393	2	3	420	Roadside Litter Collection - Rural	0	P	F	\$ 169.38	25-Oct-18	23-Nov-18	1229536
1632 C	15	0	18.393	2	3	420	Roadside Litter Collection - Rural	0	P	F	\$ 488.84	24-Nov-18	14-Dec-18	1238595
1632 C	15	0	18.393	2	3	420	Roadside Litter Collection - Rural	0	P	F	\$ 634.04	22-Feb-19	22-Mar-19	1258893
1632 C	15	0	18.393	2	3	420	Roadside Litter Collection - Rural	0	P	F	\$ 172.43	23-Mar-19	18-Apr-19	1268171
1632 C	15	0	18.393	2	3	420	Roadside Litter Collection - Rural	0	P	F	\$ 746.27	22-Jun-19	30-Jun-19	1292055
1632 C	15	0	18.393	2	3	512	Repair or Replace Guide Markers	0	P	F	\$ 113.98	1-Jul-18	24-Jul-18	1193805
1632 C	15	0	18.393	2	3	512	Repair or Replace Guide Markers	0	P	F	\$ 521.34	25-Jul-18	24-Aug-18	1199265
1632 C	15	0	18.393	2	3	512	Repair or Replace Guide Markers	0	P	F	\$ 257.26	25-Aug-18	21-Sep-18	1208663
1632 C	15	0	18.393	2	3	512	Repair or Replace Guide Markers	0	P	F	\$ 274.97	22-Sep-18	24-Oct-18	1218488
1632 C	15	0	18.393	2	3	512	Repair or Replace Guide Markers	0	P	F	\$ 100.73	24-Nov-18	14-Dec-18	1238597
1632 C	15	0	18.393	2	3	512	Repair or Replace Guide Markers	0	P	F	\$ 213.19	15-Dec-18	23-Jan-19	1246764
1632 C	15	0	18.393	2	3	512	Repair or Replace Guide Markers	0	P	F	\$ 375.22	24-Jan-19	21-Feb-19	1251962
1632 C	15	0	18.393	2	3	512	Repair or Replace Guide Markers	0	P	F	\$ 125.32	22-Feb-19	22-Mar-19	1258895
1632 C	15	0	18.393	2	3	512	Repair or Replace Guide Markers	0	P	F	\$ 121.91	19-Apr-19	22-May-19	1275843
1632 C	15	0	18.393	2	3	519	Other Road Guide Post and Marker Wo<	0	P	F	\$ 266.51	1-Jul-18	24-Jul-18	1193802
1632 C	15	0	18.393	2	3	519	Other Road Guide Post and Marker Wo<	0	P	F	\$ 749.74	25-Jul-18	24-Aug-18	1199262
1632 C	15	0	18.393	2	3	519	Other Road Guide Post and Marker Wo<	0	P	F	\$ 326.30	25-Aug-18	21-Sep-18	1208660
1632 C	15	0	18.393	2	3	519	Other Road Guide Post and Marker Wo<	0	P	F	\$ 362.42	22-Sep-18	24-Oct-18	1218485
1632 C	15	0	18.393	2	3	519	Other Road Guide Post and Marker Wo<	0	P	F	\$ 84.69	25-Oct-18	23-Nov-18	1229535
1632 C	15	0	18.393	2	3	519	Other Road Guide Post and Marker Wo<	0	P	F	\$ 531.80	24-Nov-18	14-Dec-18	1238594
1632 C	15	0	18.393	2	3	519	Other Road Guide Post and Marker Wo<	0	P	F	\$ 431.06	15-Dec-18	23-Jan-19	1246761
1632 C	15	0	18.393	2	3	519	Other Road Guide Post and Marker Wo<	0	P	F	\$ 432.58	24-Jan-19	21-Feb-19	1251959
1632 C	15	0	18.393	2	3	519	Other Road Guide Post and Marker Wo<	0	P	F	\$ 582.62	22-Feb-19	22-Mar-19	1258892
1632 C	15	0	18.393	2	3	519	Other Road Guide Post and Marker Wo<	0	P	F	\$ 86.21	23-Mar-19	18-Apr-19	1268170
1632 C	15	0	18.393	2	3	519	Other Road Guide Post and Marker Wo<	0	P	F	\$ 243.82	19-Apr-19	22-May-19	1275840
1632 C	15	0	18.393	2	3	519	Other Road Guide Post and Marker Wo<	0	P	F	\$ 172.43	23-May-19	21-Jun-19	1283662
1632 C	15	0	18.393	2	3	903	Inspections for Forward List of Work	0	P	F	\$ 390.65	1-Jul-18	24-Jul-18	1193801
1632 C	15	0	18.393	2	3	903	Inspections for Forward List of Work	0	P	F	\$ 689.34	25-Jul-18	24-Aug-18	1199261
1632 C	15	0	18.393	2	3	903	Inspections for Forward List of Work	0	P	F	\$ 683.89	25-Aug-18	21-Sep-18	1208659
1632 C	15	0	18.393	2	3	903	Inspections for Forward List of Work	0	P	F	\$ 240.97	22-Sep-18	24-Oct-18	1218484
1632 C	15	0	18.393	2	3	903	Inspections for Forward List of Work	0	P	F	\$ 328.39	25-Oct-18	23-Nov-18	1229534
1632 C	15	0	18.393	2	3	903	Inspections for Forward List of Work	0	P	F	\$ 879.04	24-Nov-18	14-Dec-18	1238593
1632 C	15	0	18.393	2	3	903	Inspections for Forward List of Work	0	P	F	\$ 3,757.70	15-Dec-18	23-Jan-19	1246760
1632 C	15	0	18.393	2	3	903	Inspections for Forward List of Work	0	P	F	\$ 469.38	24-Jan-19	21-Feb-19	1251958
1632 C	15	0	18.393	2	3	903	Inspections for Forward List of Work	0	P	F	\$ 494.53	22-Feb-19	22-Mar-19	1258891
1632 C	15	0	18.393	2	3	903	Inspections for Forward List of Work	0	P	F	\$ 572.94	23-Mar-19	18-Apr-19	1268169

Bus/comm affairs

1632 C	15	0	18.393	2	3	903	Inspections for Forward List of Work	0	P	F	\$ 343.04	19-Apr-19	22-May-19	1275839
1632 C	15	0	18.393	2	3	903	Inspections for Forward List of Work	0	P	F	\$ 378.73	23-May-19	21-Jun-19	1283661
1632 C	15	5.36	5.44	2	3	153	Insitu Stabilisation-Minor (<500m2)	0	-	U	\$ 7,290.00	19-Apr-19	22-May-19	1019784
1632 C	34	0	18.393	2	4	450	Call Out	0	P	F	\$ 275.88	25-Jul-18	24-Aug-18	1207903
1632 C	15	0	18.393	2	3	105	Pothole Patching	0	-	U	\$ 2,340.22	1-Jul-20	24-Jul-20	1407197
1632 C	15	0	18.393	2	3	105	Pothole Patching	0	-	U	\$ 2,096.89	25-Jul-20	24-Aug-20	1429002
1632 C	15	0	18.393	2	3	105	Pothole Patching	0	-	U	\$ 2,109.64	25-Aug-20	23-Sep-20	1434480
1632 C	15	0	18.393	2	3	105	Pothole Patching	0	-	U	\$ 232.72	24-Sep-20	23-Oct-20	1444135
1632 C	15	0	18.393	2	3	105	Pothole Patching	0	-	U	\$ 413.42	24-Oct-20	23-Nov-20	1457650
1632 C	15	0	18.393	2	3	105	Pothole Patching	0	-	U	\$ 1,768.25	24-Nov-20	11-Dec-20	1468687
1632 C	15	0	18.393	2	3	105	Pothole Patching	0	-	U	\$ 1,636.34	12-Dec-20	21-Jan-21	1468743
1632 C	15	0	18.393	2	3	105	Pothole Patching	0	-	U	\$ 396.28	20-Feb-21	24-Mar-21	1490040
1632 C	15	0	18.393	2	3	105	Pothole Patching	0	-	U	\$ 1,717.58	25-Mar-21	22-Apr-21	1504941
1632 C	15	0	18.393	2	3	105	Pothole Patching	0	-	U	\$ 919.53	23-Apr-21	21-May-21	1511202
1632 C	15	0	18.393	2	3	105	Pothole Patching	0	-	U	\$ 841.26	22-May-21	23-Jun-21	1519534
1632 C	15	0	18.393	2	3	105	Pothole Patching	0	-	U	\$ 164.89	24-Jun-21	30-Jun-21	1529104
1632 C	15	0	18.393	2	3	401	Tractor Slashing, Rural	0	-	U	\$ 4,860.00	1-Jul-20	24-Jul-20	1408851
1632 C	15	0	18.393	2	3	401	Tractor Slashing, Rural	0	-	U	\$ 4,860.00	22-Jan-21	19-Feb-21	1484728
1632 C	15	0	18.393	2	3	401	Tractor Slashing, Rural	0	-	U	\$ 4,860.00	23-Apr-21	21-May-21	1504770
1632 C	15	0	18.393	2	3	407	Herbicide Spraying	0	-	U	\$ 2,400.00	25-Aug-20	23-Sep-20	1435848
1632 C	15	0	18.393	2	3	407	Herbicide Spraying	0	-	U	\$ 4,500.00	12-Dec-20	21-Jan-21	1478302
1632 C	15	0	18.393	2	3	407	Herbicide Spraying	0	-	U	\$ 3,900.00	25-Mar-21	22-Apr-21	1504775
1632 C	15	0	18.393	2	3	420	Roadside Litter Collection - Rural	0	P	F	\$ 275.80	1-Jul-20	24-Jul-20	1407196
1632 C	15	0	18.393	2	3	420	Roadside Litter Collection - Rural	0	P	F	\$ 130.17	25-Jul-20	24-Aug-20	1429001
1632 C	15	0	18.393	2	3	420	Roadside Litter Collection - Rural	0	P	F	\$ 620.74	25-Aug-20	23-Sep-20	1434479
1632 C	15	0	18.393	2	3	420	Roadside Litter Collection - Rural	0	P	F	\$ 183.86	24-Sep-20	23-Oct-20	1444134
1632 C	15	0	18.393	2	3	420	Roadside Litter Collection - Rural	0	P	F	\$ 587.09	24-Nov-20	11-Dec-20	1468686
1632 C	15	0	18.393	2	3	420	Roadside Litter Collection - Rural	0	P	F	\$ 386.05	12-Dec-20	21-Jan-21	1468742
1632 C	15	0	18.393	2	3	420	Roadside Litter Collection - Rural	0	P	F	\$ 888.22	22-Jan-21	19-Feb-21	1482551
1632 C	15	0	18.393	2	3	420	Roadside Litter Collection - Rural	0	P	F	\$ 1,027.31	20-Feb-21	24-Mar-21	1490039
1632 C	15	0	18.393	2	3	420	Roadside Litter Collection - Rural	0	P	F	\$ 478.56	25-Mar-21	22-Apr-21	1504940
1632 C	15	0	18.393	2	3	420	Roadside Litter Collection - Rural	0	P	F	\$ 91.05	24-Jun-21	30-Jun-21	1529105
1632 C	15	0	18.393	2	3	512	Repair or Replace Guide Markers	0	P	F	\$ 117.50	1-Jul-20	24-Jul-20	1407195
1632 C	15	0	18.393	2	3	512	Repair or Replace Guide Markers	0	P	F	\$ 496.85	25-Jul-20	24-Aug-20	1429000
1632 C	15	0	18.393	2	3	512	Repair or Replace Guide Markers	0	P	F	\$ 328.44	25-Aug-20	23-Sep-20	1434478
1632 C	15	0	18.393	2	3	512	Repair or Replace Guide Markers	0	P	F	\$ 367.82	24-Oct-20	23-Nov-20	1457648
1632 C	15	0	18.393	2	3	512	Repair or Replace Guide Markers	0	P	F	\$ 156.34	24-Nov-20	11-Dec-20	1468685
1632 C	15	0	18.393	2	3	512	Repair or Replace Guide Markers	0	P	F	\$ 1,638.49	12-Dec-20	21-Jan-21	1468741
1632 C	15	0	18.393	2	3	512	Repair or Replace Guide Markers	0	P	F	\$ 475.12	22-Jan-21	19-Feb-21	1482550
1632 C	15	0	18.393	2	3	512	Repair or Replace Guide Markers	0	P	F	\$ 308.02	20-Feb-21	24-Mar-21	1490038
1632 C	15	0	18.393	2	3	512	Repair or Replace Guide Markers	0	P	F	\$ 277.73	25-Mar-21	22-Apr-21	1504939
1632 C	15	0	18.393	2	3	512	Repair or Replace Guide Markers	0	P	F	\$ 277.73	23-Apr-21	21-May-21	1511201
1632 C	15	0	18.393	2	3	519	Other Road Guide Post and Marker Wo<	0	P	F	\$ 211.53	1-Jul-20	24-Jul-20	1407194
1632 C	15	0	18.393	2	3	519	Other Road Guide Post and Marker Wo<	0	P	F	\$ 444.20	25-Jul-20	24-Aug-20	1428999
1632 C	15	0	18.393	2	3	519	Other Road Guide Post and Marker Wo<	0	P	F	\$ 551.60	25-Aug-20	23-Sep-20	1434477
1632 C	15	0	18.393	2	3	519	Other Road Guide Post and Marker Wo<	0	P	F	\$ 91.94	24-Sep-20	23-Oct-20	1444132
1632 C	15	0	18.393	2	3	519	Other Road Guide Post and Marker Wo<	0	P	F	\$ 331.78	24-Oct-20	23-Nov-20	1457647
1632 C	15	0	18.393	2	3	519	Other Road Guide Post and Marker Wo<	0	P	F	\$ 185.01	24-Nov-20	11-Dec-20	1468684
1632 C	15	0	18.393	2	3	519	Other Road Guide Post and Marker Wo<	0	P	F	\$ 745.18	12-Dec-20	21-Jan-21	1468740
1632 C	15	0	18.393	2	3	519	Other Road Guide Post and Marker Wo<	0	P	F	\$ 358.87	22-Jan-21	19-Feb-21	1482549
1632 C	15	0	18.393	2	3	519	Other Road Guide Post and Marker Wo<	0	P	F	\$ 663.47	20-Feb-21	24-Mar-21	1490037
1632 C	15	0	18.393	2	3	519	Other Road Guide Post and Marker Wo<	0	P	F	\$ 185.01	25-Mar-21	22-Apr-21	1504938
1632 C	15	0	18.393	2	3	519	Other Road Guide Post and Marker Wo<	0	P	F	\$ 315.75	23-Apr-21	21-May-21	1511199
1632 C	15	0	18.393	2	3	519	Other Road Guide Post and Marker Wo<	0	P	F	\$ 408.25	22-May-21	23-Jun-21	1519531
1632 C	15	0	18.393	2	3	519	Other Road Guide Post and Marker Wo<	0	P	F	\$ 91.05	24-Jun-21	30-Jun-21	1529101
1632 C	15	0	18.393	2	3	903	Inspections for Forward List of Work	0	P	F	\$ 1,068.21	1-Jul-20	24-Jul-20	1407193
1632 C	15	0	18.393	2	3	903	Inspections for Forward List of Work	0	P	F	\$ 1,315.81	25-Jul-20	24-Aug-20	1428998
1632 C	15	0	18.393	2	3	903	Inspections for Forward List of Work	0	P	F	\$ 615.33	25-Aug-20	23-Sep-20	1434476
1632 C	15	0	18.393	2	3	903	Inspections for Forward List of Work	0	P	F	\$ 460.77	24-Sep-20	23-Oct-20	1444131
1632 C	15	0	18.393	2	3	903	Inspections for Forward List of Work	0	P	F	\$ 1,768.16	24-Oct-20	23-Nov-20	1457646
1632 C	15	0	18.393	2	3	903	Inspections for Forward List of Work	0	P	F	\$ 392.95	24-Nov-20	11-Dec-20	1468683
1632 C	15	0	18.393	2	3	903	Inspections for Forward List of Work	0	P	F	\$ 1,130.13	12-Dec-20	21-Jan-21	1468739
1632 C	15	0	18.393	2	3	903	Inspections for Forward List of Work	0	P	F	\$ 708.09	22-Jan-21	19-Feb-21	1482548
1632 C	15	0	18.393	2	3	903	Inspections for Forward List of Work	0	P	F	\$ 2,427.24	20-Feb-21	24-Mar-21	1490036
1632 C	15	0	18.393	2	3	903	Inspections for Forward List of Work	0	P	F	\$ 303.47	25-Mar-21	22-Apr-21	1504937
1632 C	15	0	18.393	2	3	903	Inspections for Forward List of Work	0	P	F	\$ 1,620.67	23-Apr-21	21-May-21	1511200
1632 C	15	0	18.393	2	3	903	Inspections for Forward List of Work	0	P	F	\$ 331.67	22-May-21	23-Jun-21	1519532
1632 C	15	0	18.393	2	3	105	Pothole Patching	0	-	U	\$ 1,528.00	1-Jul-21	23-Jul-21	1526200
1632 C	15	0	18.393	2	3	105	Pothole Patching	0	-	U	\$ 471.02	24-Jul-21	24-Aug-21	1541278
1632 C	15	0	18.393	2	3	105	Pothole Patching	0	-	U	\$ 183.56	24-Sep-21	22-Oct-21	1565236
1632 C	15	0	18.393	2	3	105	Pothole Patching	0	-	U	\$ 855.14	23-Oct-21	23-Nov-21	1576624
1632 C	15	0	18.393	2	3	105	Pothole Patching	0	-	U	\$ 204.64	24-Nov-21	17-Dec-21	1587781
1632 C	15	0	18.393	2	3	105	Pothole Patching	0	-	U	\$ 1,396.62	18-Dec-21	19-Jan-22	1597530
1632 C	15	0	18.393	2	3	401	Tractor Slashing, Rural	0	-	U	\$ 5,794.39	23-Oct-21	23-Nov-21	1577852

Bus/comm affairs



1632 C	15	0	18.393	2	3	407	Herbicide Spraying	0	P	F		\$ 3,440.79	24-Sep-21	22-Oct-21	1566799
1632 C	15	0	18.393	2	3	420	Roadside Litter Collection - Rural	0	P	F		\$ 469.96	1-Jul-21	23-Jul-21	1526201
1632 C	15	0	18.393	2	3	420	Roadside Litter Collection - Rural	0	P	F		\$ 618.43	24-Sep-21	22-Oct-21	1565237
1632 C	15	0	18.393	2	3	420	Roadside Litter Collection - Rural	0	P	F		\$ 993.35	23-Oct-21	23-Nov-21	1576625
1632 C	15	0	18.393	2	3	420	Roadside Litter Collection - Rural	0	P	F		\$ 94.68	24-Nov-21	17-Dec-21	1587782
1632 C	15	0	18.393	2	3	512	Repair or Replace Guide Markers	0	P	F		\$ 327.87	1-Jul-21	23-Jul-21	1526202
1632 C	15	0	18.393	2	3	512	Repair or Replace Guide Markers	0	P	F		\$ 162.87	24-Jul-21	24-Aug-21	1541280
1632 C	15	0	18.393	2	3	512	Repair or Replace Guide Markers	0	P	F		\$ 403.51	24-Sep-21	22-Oct-21	1565238
1632 C	15	0	18.393	2	3	512	Repair or Replace Guide Markers	0	P	F		\$ 190.82	24-Nov-21	17-Dec-21	1587783
1632 C	15	0	18.393	2	3	512	Repair or Replace Guide Markers	0	P	F		\$ 472.70	18-Dec-21	19-Jan-22	1597532
1632 C	15	0	18.393	2	3	519	Other Road Guide Post and Marker Wo<	0	P	F		\$ 182.11	1-Jul-21	23-Jul-21	1526199
1632 C	15	0	18.393	2	3	519	Other Road Guide Post and Marker Wo<	0	P	F		\$ 382.54	25-Aug-21	23-Sep-21	1554793
1632 C	15	0	18.393	2	3	519	Other Road Guide Post and Marker Wo<	0	P	F		\$ 474.32	24-Sep-21	22-Oct-21	1565235
1632 C	15	0	18.393	2	3	519	Other Road Guide Post and Marker Wo<	0	P	F	Bus/comm affairs	\$ 926.19	23-Oct-21	23-Nov-21	1576623
1632 C	15	0	18.393	2	3	519	Other Road Guide Post and Marker Wo<	0	P	F		\$ 189.37	24-Nov-21	17-Dec-21	1587780
1632 C	15	0	18.393	2	3	519	Other Road Guide Post and Marker Wo<	0	P	F		\$ 188.22	18-Dec-21	19-Jan-22	1597529
1632 C	15	0	18.393	2	3	903	Inspections for Forward List of Work	0	P	F		\$ 557.06	1-Jul-21	23-Jul-21	1526203
1632 C	15	0	18.393	2	3	903	Inspections for Forward List of Work	0	P	F		\$ 333.20	24-Jul-21	24-Aug-21	1541281
1632 C	15	0	18.393	2	3	903	Inspections for Forward List of Work	0	P	F		\$ 476.50	25-Aug-21	23-Sep-21	1554797
1632 C	15	0	18.393	2	3	903	Inspections for Forward List of Work	0	P	F		\$ 339.09	24-Sep-21	22-Oct-21	1565239
1632 C	15	0	18.393	2	3	903	Inspections for Forward List of Work	0	P	F		\$ 925.65	23-Oct-21	23-Nov-21	1576627
1632 C	15	0	18.393	2	3	903	Inspections for Forward List of Work	0	P	F		\$ 308.55	24-Nov-21	17-Dec-21	1587784
1632 C	15	0	18.393	2	3	903	Inspections for Forward List of Work	0	P	F		\$ 777.86	18-Dec-21	19-Jan-22	1597533
1632 C	56	5.073	5.123	2	4	450	Call Out	0	P	F		\$ 2,289.77	18-Dec-21	19-Jan-22	1602827

Released under RTI - DTMR