

ELEVATION

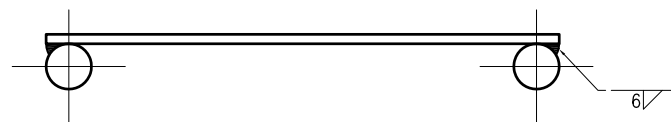

PLAN

**RAGBOLT SUB ASSEMBLY (2 OFF)**

Assemblies to be supplied complete with 8 x hex. galv. nuts and washers

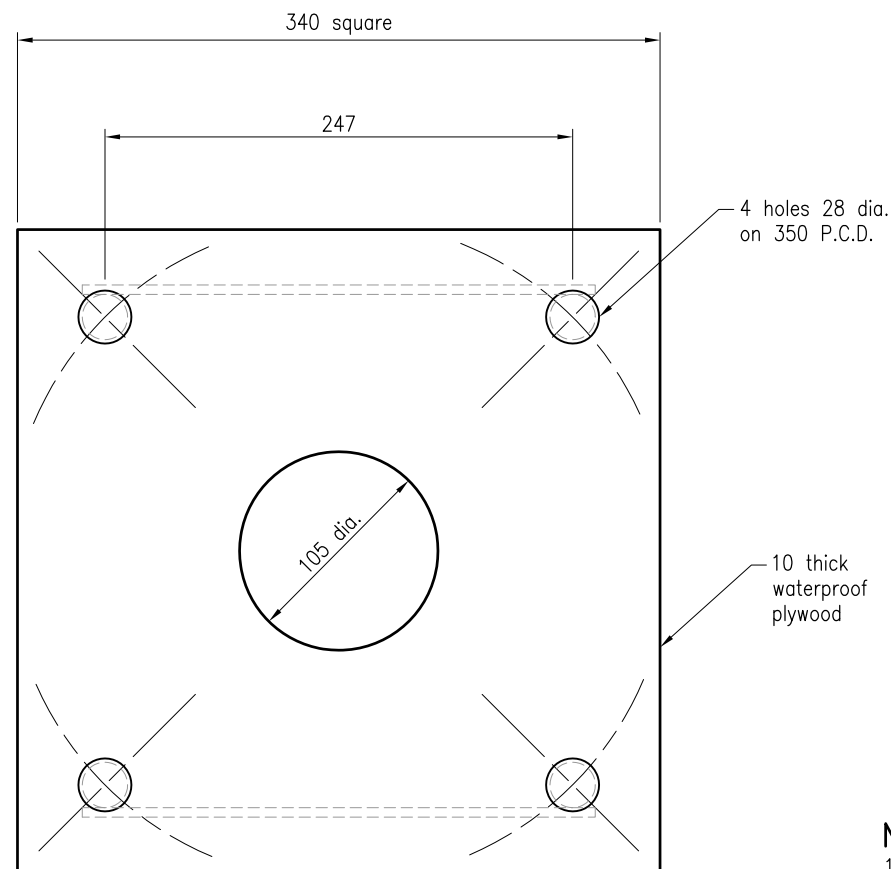

RAGBOLT TEMPLATE (1 OFF)

**NOTES:**

1. Round bar to AS/NZS 3679.1.
2. Flat plate to AS/NZS 3678.
3. Welding Symbols to AS 1101.3.
4. All welding in accordance with AS/NZS 1554.1.
5. All steelwork to be cleaned and welding slag removed prior to hot dip galvanising to AS 1214.
6. All nuts to be grade 5 to AS 1112.2 and hot dip galvanised to AS 1214.
7. All washers grade 4.6 to be hot dip galvanised to AS/NZS 4680.
8. All dimensions are in millimetres unless shown otherwise.

ASSOCIATED DEPARTMENTAL DOCUMENTS:

Standard Drawings Roads Manual  
Main Roads Specifications and Technical Standards Manual

REFERENCED DOCUMENTS:

Departmental Standard Specifications:  
MRTS92 Traffic Signal and Road Lighting Footings

Australian Standards:

- AS 1101.3 Graphic Symbols for General Engineering – Welding and Non-destructive Examination
- AS 1112.2 ISO Metric Hexagon Nuts – Style 2 – Product Grades A and B
- AS 1214 Hot-dip Galvanized Coatings on Threaded Fasteners (ISO Metric Coarse Thread Series)
- AS/NZS 1554.1 Structural Steel Welding – Welding of Steel Structures
- AS/NZS 3678 Structural Steel – Hot-rolled Plates, Floorplates and Slabs
- AS/NZS 3679.1 Structural Steel – Hot-rolled Bars and Sections
- AS/NZS 4680 Hot-dip Galvanized (Zinc) Coatings on Fabricated Ferrous Articles

**! WARNING** INSTALLATION OF CONDUITS AND PITS IS THE RESPONSIBILITY OF THE LICENSED ELECTRICAL CONTRACTOR

Department of Transport and Main Roads		 <small>© The State of Queensland (Department of Transport and Main Roads) 2014 http://creativecommons.org/licenses/by/3.0/au</small>	
TRAFFIC SIGNALS			
RAGBOLT SUB-ASSEMBLY FABRICATION DETAILS	A3	Standard Drawing No	
	Not to Scale	1422	
		Date 1/14	