

# Local Links

10 June 2010

Your news and updates from in and around Metro

## Editor's log

Transport and Main Roads is getting ready to celebrate the opening of the Ted Smout Memorial Bridge on Sunday 11 July 2010.

For details on how you can be involved in the bridge walkover and community day celebrations see page two.

The football season reaches fever pitch this fortnight, with both AFL and NRL games at the Gabba and Suncorp Stadium.

NRL fanatics shouldn't miss the *NRL double header* on Friday 18 June 2010, with two consecutive football games at Suncorp Stadium.

Continue the weekend of football with the *Lions vs Richmond* game on Saturday 19 June 2010.

For all things camping and caravanning, head to the *Caravan, camping and outdoor living show* at the RNA Showgrounds until Tuesday 15 June 2010. See the latest caravans, motorhomes, campervans and camper trailers, as well as information about tourism destinations across Australia.

**Communications Team**

## Major roadworks affecting traffic

### Darra to Springfield Transport Corridor Stage 1

Temporary closures of the Centenary Highway and Teraba Street at Richlands and Waterford Road at Wacol. Please refer to page 4.

### Ipswich Motorway Upgrade: Dinmore to Goodna

Temporary traffic changes and traffic switches will be carried out on the Ipswich Motorway at Goodna and Riverview in June and July. Please refer to page 5.

### Airport Roundabout Upgrade

Road closures and detours on the Airport Roundabout, East West Arterial Road and the Gateway Motorway on and off ramps between 8.00pm and 5.00am nightly until late June 2010. Please refer to page 8.

### Gateway Upgrade Project

Changed traffic conditions and lane closures between Mt Gravatt-Capalaba Road and Miles Platting Road until mid 2011. Please refer to page 9.

## Major events affecting traffic

### Caravan, camping and outdoor living show

Wednesday 9 June to Tuesday 15 June 2010, RNA Showgrounds

### State of Origin - Game 2

Wednesday 16 June 2010, 8.00pm, Suncorp Stadium

### NRL double header - Broncos vs Panthers and Bulldogs vs Titans

Friday 18 June 2010, 7.00pm, Suncorp Stadium

### AFL - Lions vs Richmond

Saturday 19 June 2010, 7.10pm, The Gabba

For enquiries on roadworks and traffic conditions, or to report an incident, call 13 19 40.

## spotlight

### Celebrate the opening of the Ted Smout Memorial Bridge

The Ted Smout Memorial Bridge will be commissioned on Sunday 11 July 2010 with an official opening celebration, bridge walkover and community day activities.

The new bridge has been constructed as part of the \$315 million Houghton Highway Duplication Project and incorporates the latest design techniques to ensure it withstands a 1 in 2000 year storm event.

Principal Engineer (Construction) Paul McCormack, from Metropolitan Region said that the bridge design reflected the lessons learnt when Hurricane Katrina hit the Gulf of Mexico in August 2005.

"The Ted Smout Memorial Bridge is built to remain standing through extremely severe storms, making post-storm recovery quicker," said Paul.

At 2.7 kilometres in length, the Ted Smout Memorial Bridge is the longest road bridge in Australia and was named after Queensland's last surviving World War I digger during the Q150 celebrations in 2009.

The opening of the new bridge has been five years in the making, with initial community consultation marking the beginning of the project in 2005.

The bridge opening celebrations will take place from 9am to 3pm on Sunday 11 July 2010 and will include community day activities in Pelican Park at Clontarf and Decker Park at Brighton.

Take up the challenge to walk the bridge between 8.30am and 2.30pm by registering at [www.tmr.qld.gov.au/tedsmout](http://www.tmr.qld.gov.au/tedsmout). If you would like to watch the official commissioning in the centre of the bridge at 9am, you must register to walk the bridge between 8.30am and 9.30am.



New footpaths and lighting have been installed adjacent to the Ted Smout Memorial Bridge

## Travelsmart Tip:

### Travel safely around railways

Railway stations and level crossings can be very dangerous if not used safely and with care.

Always stay behind the safety line when waiting for a train and only cross railway lines using signalised level crossings, overhead footbridges, tunnels or subways.



The new 2.7 kilometre Ted Smout Memorial Bridge provides a vital transport link between Brighton and Clontarf

# Road work and traffic conditions

## North Brisbane

### Houghton Highway Duplication Project

#### Worksite 1: Brighton

The department is continuing work on the Houghton Highway between the Deagon Deviation and Twenty-fifth Avenue, Brighton.

#### Worksite 2: Clontarf

The department is continuing work on the Houghton Highway Duplication Project at Clontarf Point, Clontarf.

There will be ongoing intermittent lane closures. Further details will be provided prior to any major lane closures.

The new bridge is expected to be opened to traffic in mid 2010 with all project activities scheduled to be completed in mid 2011, weather permitting.

#### Peak-hour traffic effect

Low impact. Intermittent lane closures apply.

#### Further information

Project Manager on 0418 785 370

### Hornibrook Esplanade: changed traffic conditions

Access to the northern car park of the old Hornibrook Bridge is closed to all traffic. Work is scheduled to be completed by mid 2010, weather permitting.

#### Peak-hour traffic effect

Nil. Access change.

#### Further information

Project Manager on 0418 785 370

## South Brisbane

### Acacia Ridge: Acacia Ridge rail crossing overpass

The department is constructing the northern structure of the overpass on Beaudesert Road, Acacia Ridge.

Ongoing drainage and roadworks will be carried out in the vicinity of the intersection. Work is scheduled to be completed by mid 2010, weather permitting.

#### Peak-hour traffic effect

Low impact. Single lane closures and reduced speed limits apply.

#### Further information

Project Team on 1800 650 229

### Eight Mile Plains: extending the Pacific Motorway Bikeway

The department is extending the existing Pacific Motorway Bikeway from Miles Platting Road to the Logan Road exit. Work is scheduled to be completed by the end of June 2010, weather permitting.

#### Peak-hour traffic effect

Low impact. Lane closures and reduced speed limits apply.

#### Further information

Project Manager on 3137 8367



The old Hornibrook Highway bridge between Brighton and Clontarf

## works East Brisbane

### Cleveland-Redland Bay Road service relocation works

The department is relocating services on Cleveland-Redland Bay Road from South Street at Cleveland to Boundary Road, Thornlands. This work is being completed in preparation for upcoming road improvement works.

Work will be carried out between 7am and 6pm, Monday to Friday and 7am and 5pm on Saturdays, and is expected to be completed by July 2010, weather permitting.

#### Peak hour traffic effect

Minor delays expected due to short term lane closures and reduced speed limits through the work zone.

#### Further information

Project team on 1800 733 5263

### Mount Cotton: Mount Cotton Road safety improvement work

The department is undertaking safety improvement work at the intersection of Mount Cotton Road and Hillview Road, Mount Cotton.

Work will be carried out between 6am to 4pm, Monday to Friday. Some night work may also be required between 7pm and 5am, as well as some weekend work between 6am and 4pm. Work is scheduled to be completed by late June 2010, weather permitting.

#### Peak-hour traffic effect

Low impact. Lane closures and reduced speed limits apply.

#### Further information

Project Manager on 3137 8437

## works West Brisbane & Ipswich

### Darra to Springfield Transport Corridor Stage 1

#### Richlands: Partial closure of Teraba Street

The southern end of Teraba Street, between Progress Road and Pine Road west at Richlands will be closed until July 2010 to allow for the Progress Road upgrade. Motorists will be detoured via Boundary Road and Bukulla Street. Please see **Map A** for alternative routes.

#### Peak-hour traffic effect

Alternative routes in place.

#### Further information

Community Engagement Team on 1800 887 464

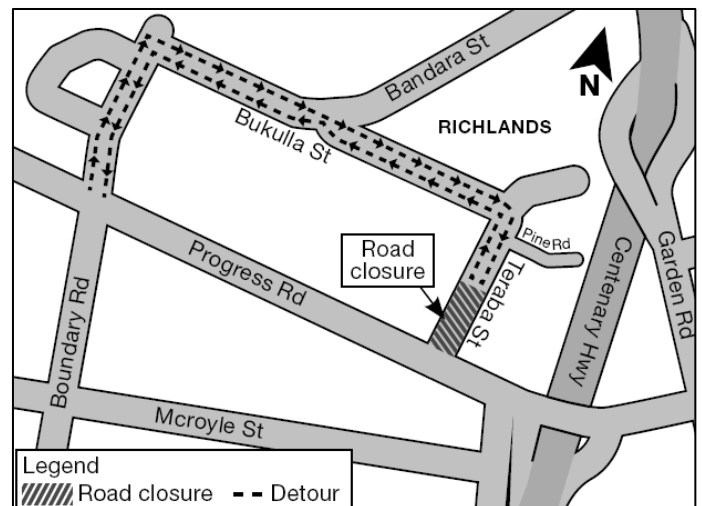

Map A: Partial closure of Tereba Street at Richlands



### Ipswich Motorway Upgrade: Dinmore to Goodna

#### Riverview: Ipswich Motorway traffic changes

Two major temporary traffic changes will be carried out on the Ipswich Motorway at Riverview between early June and early July 2010.

The exit on the Ipswich Motorway to the Warrego Highway has been temporarily changed to a right hand exit. Access to Brisbane Road and the Cunningham Highway remains the same for Ipswich bound traffic.

In early July, Brisbane bound traffic on the Ipswich Motorway will transfer onto the existing westbound lanes between the Warrego Highway Bridge at Dinmore and the Tessman Street Bridge at Riverview.

These traffic changes are expected to be in place until September 2011 to allow for the construction of the new eastbound bridge at the Endeavour Road connection and the new Warrego Highway bridge at Dinmore.

#### Peak-hour traffic effect

Access changes during non-peak periods.

#### Mine Street traffic changes

To allow for upgrades to Mine Street and the new Smiths Road intersection, there are ongoing traffic changes along Mine Street between the Mine Street interchange and Namatjira Drive. These traffic changes will continue until the end of 2010, weather and construction conditions permitting.

#### Peak-hour traffic effect

Ongoing traffic changes until end of 2010.

#### Church Street temporary closure

A small section of Church Street, Goodna will be temporarily closed until mid June 2010, weather and construction conditions permitting. Motorists can access Goodna via the roundabout on Church Street.

#### Peak-hour traffic effect

Temporary road closure - alternative access in place.

#### Redbank: Ipswich Motorway diversion

Traffic detours will be in place for Brisbane bound traffic from 8pm to 5am nightly from Sunday 20 June to Sunday 27 June, and from Monday 28 June to Tuesday 6 July.

Traffic will be detoured down Brisbane Road at Redbank and back onto the Ipswich Motorway at Bridge Street. Traffic on the Ipswich Motorway (Ipswich bound) will be reduced to one lane during these periods.

#### Peak-hour traffic effect

Nil.

#### Further information

Community Engagement Team on 1800 465 682

### Forest Hill-Fernvale Road and Brightview Road Road improvement works

The department is completing road resurfacing at the intersection of Forest-Hill-Fernvale Road and Brightview Road, Glenore Grove.

Work will be carried out between 9am and 3pm, Saturday 12 June and Sunday 13 June 2010, weather permitting.

#### Peak-hour traffic effect

Minor traffic disruptions during non-peak periods. Reduced speed limits apply.

#### Further information

Project Team on 3137 8282

### Gatton-Helidon Road and Flagstone Creek Road, Helidon and Forest Hill-Fernvale Road and Lake Claredon Way, Glenore Grove

The department is completing road resurfacing at the intersection of Gatton Helidon Road and Flagstone Creek Road at Helidon and at the intersection of Forest Hill-Fernvale Road and Lake Claredon Way, Glenore Grove.

Works will be carried out between 9am and 3pm Monday to Friday. Work is scheduled to be completed in mid June 2010.

#### Peak-hour traffic effect

Minor traffic disruptions during non-peak periods. Reduced speed limits apply.

#### Further information

Project Team on 3137 8282

### Moggill Road - Bainbridge Drive to Grandview Road and Kenmore Roundabout to Kilkivan Avenue

The department is carrying out road improvement works along Moggill Road to improve safety for all road users.

Work will be carried out on Moggill Road from Bainbridge Drive to Grandview Road at Pinjarra Hills, and from Kenmore Roundabout to Kilkivan Avenue, Kenmore.

Work will be carried out between 8pm and 5am Sunday to Friday. Work is scheduled to be completed late June 2010, weather permitting.

#### Peak-hour traffic effect

Minor traffic disruptions during non-peak periods. Reduced speed limits apply.

#### Further information

Project Team on 3137 8282

**Moggill Road culvert rehabilitation works**

Culvert rehabilitation works will be carried out beside Moggill Road on the service road to Brisbane Independent Primary School, Pullenvale.

Work will be carried out between 6am and 5pm Monday to Friday. Work is scheduled to be completed in early July 2010, weather permitting.

**Peak-hour traffic effect**

Minor traffic disruptions due to lane closures and reduced speed limits.

**Further information**

Project Manager on 3137 8282

---

**Peak Crossing: Ipswich Boonah Road**

Safety improvement work is being undertaken on Ipswich Boonah Road at Deebling Heights, Purga, Goolman and Peak Crossing.

Work will be carried out between 6am and 4pm, Monday to Friday. Work is scheduled to be completed by mid 2010, weather permitting.

**Peak-hour traffic effect**

Low impact. Lane closures and reduced speed limits apply.

**Further information**

Project Manager on 3137 3069

---

**Raceview: Swanbank Road night works**

The department is completing road improvement works, including road repairs and resurfacing, on Swanbank Road, Raceview.

Work will be carried out on Swanbank Road between South Station Road and Douglas Street, including the Cunningham Highway overpass.

Work will be carried out between 7pm and 5am Monday to Friday. Work is scheduled to be completed in mid June 2010, weather permitting.

**Peak-hour traffic effect**

Minor traffic disruptions during non-peak periods.

**Further information**

Project Manager on 0401 896 703

---

**Rosewood-Laidley Road culvert rehabilitation works**

Culvert rehabilitation works will be carried out on Rosewood-Laidley Road west of Stevens Road, Lanefield.

Work will be carried out 24 hours a day, 7 days a week, and is scheduled to be completed in early July 2010.

**Peak-hour traffic effect**

Traffic disruptions due to lane closures and reduced speed limits.

**Further information**

Project Manager on 3137 8282

**Swanbank: Swanbank Road and Memorial Drive safety improvement works**

Safety improvement works will be carried out at the intersection of Swanbank Road and Memorial Drive at Swanbank.

Work will be carried out from Tuesday 15 June to Wednesday 16 June 2010 and will involve line marking, updating signage and restricting traffic movement on the right side of the intersection to a one way movement from Swanbank Road to Memorial Drive.

**Peak-hour traffic effect**

Minor traffic disruptions due to lane closures and reduced speed limits through the work site.

**Further information**

Project Team on 3137 8282

---

**Warrego Highway safety improvement works**

Safety improvement work will be completed on the Warrego Highway between Kholo Road Overpass and Eleazar Drive.

Work will be carried out between 6am and 4pm, Monday to Friday. Work is scheduled to be completed in late June 2010, weather permitting.

**Peak-hour traffic effect**

Minor traffic disruptions may occur due to lane closures and reduced speed limits.

**Further information**

Project Team on 3137 8282

---

**Warrego Highway and Linnings Road safety improvement works**

Safety improvement work will be completed at the intersection of the Warrego Highway and Linnings Road, Haigslea.

Work will be carried out between 8am and 5pm Monday to Friday. Work is scheduled to be completed in mid July 2010, weather permitting.

**Peak-hour traffic effect**

Minor traffic disruptions may occur due to lane closures and reduced speed limits.

**Further information**

Contractor Project Manager on 0437 636 273

## Project Contact Details

\*\*For project works, information is provided direct from the project teams. Please see the "Further information" section for project contact details.

### Under construction

#### Acacia Ridge rail crossing overpass

Phone: 1800 650 229 (Business hours)  
Urgent after hours enquiries: 0423 029 824  
Email: acaciaridge@tmr.qld.gov.au

#### Corinda to Darra Rail Upgrade

Phone: 1800 680 385

#### Darra to Springfield Transport Corridor

Phone: 1800 887 464  
Email: info@horizon.incite.com.au

#### Houghton Highway Duplication Project

Phone: 1800 626 976  
Email: houghtonhighway@tmr.qld.gov.au

#### Ipswich Motorway Upgrade: Dinmore to Goodna

Phone: 1800 465 682  
Email: dinmore2goodna@tmr.qld.gov.au

#### Ipswich Motorway Upgrade: Wacol to Darra

Phone: 1800 605 410  
Email: wacol2darra@tmr.qld.gov.au

### Planning studies

#### Cunningham Highway/Amberley Interchange Planning Study

Phone: 1800 897 778  
Email: Cunningham Highway-  
AmberleyInterchange@tmr.qld.gov.au

#### Gateway Motorway North Planning Study

Phone: 1800 897 778  
Email: gatewaynorth@tmr.qld.gov.au

#### Gympie Road Planning Study

Phone: 3137 8477  
Email: gympieroad@tmr.qld.gov.au

#### Ipswich Motorway Planning Study: Darra to Rocklea

Phone: 1800 204 990  
Email: darra2rocklea@tmr.qld.gov.au

#### Port of Brisbane Motorway Upgrade Planning Study

Phone: 1800 625 801

#### Stafford Road Planning Study

Phone: 3137 8477  
Email: staffordroad@tmr.qld.gov.au

#### Summers Road Interchange Planning Study

Phone: 1800 081 344  
Email: summersroad@tmr.qld.gov.au

#### Western Brisbane Transport Network Strategy

Phone: 1800 636 896  
Email: wbttni@tmr.qld.gov.au



The new Sir Leo Hielscher Bridge was opened to traffic on Sunday 23 May 2010

## Other Works

### Airport Link

#### Bowen Hills to Woollowin: changed traffic conditions

There will be changed traffic conditions along Lutwyche Road and Truro Street between Albion Road and Kedron Park Road. Work will be carried out between 8pm and 5am, as required until 2012, weather permitting.

#### Bowen Hills: Inner City Bypass

Temporary lane closures will be in place on the Lutwyche Road off-ramp of the Inner City Bypass as required until late 2010.

#### Bowen Hills: Lutwyche Road

Temporary lane closures will be in place on Lutwyche Road between Northey Street and Newmarket Road as required until late 2010.

#### Kedron: Gympie Road

Gympie Road (southbound) will be reduced to two lanes from Somerset Road to Broughton Road until late 2010.

#### Lutwyche and Windsor: Lutwyche Road

Lane closures will be in place on Lutwyche Road and Magyar Street nightly from 8pm to 5am until Tuesday 15 June 2010, weather permitting.

#### Windsor and Kedron South: Lutwyche Road

A southbound diversion will be in place on Lutwyche Road at the intersection of Norman Street until mid 2010.

#### Windsor: Truro Street

Changed traffic conditions at Truro Street are currently in place. The two existing southbound lanes on Lutwyche Road from Chalk Street will be continued 150 metres south on Truro Street between Stoneleigh Street and Annie Street. The T3 transit lane will be relocated to 100 metres south of Albion Road intersection. Work is scheduled to be completed by mid 2012, weather permitting.

#### Further information

Airport Link Team on 1800 721 783  
Email: [contactus@tjh.com.au](mailto:contactus@tjh.com.au)

### Airport Roundabout Upgrade

#### Airport Roundabout and Gateway Motorway: changed traffic conditions

There will be lane closures and detours on sections of the Airport Roundabout and Gateway Motorway for work on the East-West Arterial flyover and new Gateway Motorway Bridge.

Work will be carried out between 10pm and 4am, as required, and is scheduled to be completed by mid 2011, weather permitting.

There will be road closures and detours on the Airport Roundabout, East West Arterial Road and the Gateway Motorway on and off ramps between 8pm and 5am nightly until Monday 21 June 2010.

#### Height restrictions on the Airport Roundabout

There are height restrictions on the eastbound Airport Roundabout circulating lanes until late 2010.

Vehicles exceeding the five metre height restriction should detour via the northbound off-ramp. Alternatively, vehicles can continue north to the Toombul Road roundabout and access the southbound on-ramp to the Gateway Motorway before taking the Airport Drive exit.

#### Further information

Airport Link Team on 1800 721 783  
Email: [contactus@tjh.com.au](mailto:contactus@tjh.com.au)

### Brisbane Airport

#### Ongoing works on Moreton Drive

There will be ongoing works along Moreton Drive at Brisbane Airport continuing throughout June 2010. There will be some intermittent lane closures on Moreton Drive at night and during off-peak times. In late June there will also be intermittent lane closures and traffic management on Airport Drive and Dryandra Road for signage installation work.

#### Further information

Brisbane Airport Major Projects Team on 1300 732 240  
Email: [info@bacmajorprojects.com.au](mailto:info@bacmajorprojects.com.au)



## Gateway Upgrade Project

### North

#### **Eagle Farm to Murarrie: Sir Leo Hielscher Bridges changed traffic conditions**

Four lanes on the new Sir Leo Hielscher Bridge have been opened, with more lanes progressively delivered as works are completed. The original Sir Leo Hielscher Bridge will remain open while it undergoes a six month staged refurbishment with three northbound lanes remaining open during peak periods. Changed traffic conditions will be in place on the original Sir Leo Hielscher Bridge between 8pm and 4.30am, as required until late 2010, weather permitting.

### South

#### **Murarrie to Mackenzie: Gateway Motorway changed traffic conditions**

The final lane configuration between Wynnum Road and Old Cleveland Road has been opened to traffic. There will be temporary lane closures between 8pm and 4.30am, nightly throughout June to allow finishing and maintenance works to be completed.

#### **Mackenzie to Eight Mile Plains: Gateway Motorway lane closures**

Changed traffic conditions and lane closures are required for the Gateway Upgrade Project, between Mt Gravatt-Capalaba Road and Miles Platting Road. Closures will be in place between 8pm and 4:30am as required until mid 2011, weather permitting.

#### **Further information**

Gateway Upgrade Project Team on 1800 700 525  
Email enquiries@gatewayupgradeproject.com.au



Gateway Motorway - Wynnum Road exit

## Brisbane City Council

### Go-Between Bridge

#### **Milton: Hale Street no right-turn and lane closures**

The right-turn from Hale Street onto Coronation Drive is closed until mid 2010, weather permitting.

#### **South Brisbane: Changed traffic conditions**

There are major traffic changes on Merivale Street, Peel Street, Cordelia Street and Montague Road. Merivale Street is now one-way, southbound from Montague Road (towards Vulture Street). Peel Street is now two-way between Cordelia Street and Merivale Street.

There is no right-turn from Peel Street into Merivale Street southbound (toward Vulture Street). Motorists travelling from Grey Street can proceed as far as Cordelia Street.

Motorists travelling from Grey Street along Peel Street can access Montague Road via a new dedicated right-turn into Cordelia Street.

There is temporarily no left-turn from Cordelia Street into Peel Street. Motorists can access Peel Street via Cordelia Street and Boundary Street.

There will continue to be lane closures on Montague Road, Merivale Street, Cordelia Street and Boundary Street until July 2010, weather permitting. Riverside Drive is closed between Bouquet Street and Merivale Rail Bridge, South Brisbane, until June 2010.

#### **Further information**

Hale Street Link Alliance on 1800 425 378  
Visit [www.halestreetlink.com.au](http://www.halestreetlink.com.au)

#### **Kingsford Smith Drive - Harvey Street to Theodore Street upgrade**

#### **Eagle farm construction works**

There will be temporary lane closures along Kingsford Smith Drive between Harvey Street and Theodore Street to allow for excavation works, road resurfacing, installing street lighting and sewer manholes. Construction will mostly occur between 7am and 5pm Monday to Saturday, with some night works and Sunday works.

#### **Further information**

Community Relations team on 1800 727 923