

From: Not relevant
To: [SCR Compensation Claims](#)
Subject: Not relevant
Date: Monday, 1 April 2019 11:35:00 AM
Attachments: [TGSSAT - 000 Aftercare Signage.pdf](#)
[356468.pdf](#)
[Boonah Rathdowney Road - Ch 21.710 - Incident Map - 23.09.18.pdf](#)
[Email - out 20.12.18 more info required.pdf](#)
[Email - out 20.12.18 clai investigation to commence.pdf](#)
[Email - out 31.10.18 VBA claims process.pdf](#)
[Email correspondence 26.02.19-01.04.19.pdf](#)
[Email - out 15.01.19 Investigation to commence v2.pdf](#)
[Email - out 15.02.19 claim rejected.pdf](#)
[Email correspondence 04.02.19-06.04.19 update.pdf](#)

Hi Team,

We have rejected this one as we had aftercare signage in place. Attached is all relevant documentation and email correspondence (His insurance company was chasing us up for reimbursement).

Let me know if you have any questions.

Kind Regards,

▶ Not relevant

Community Relations Advisor

Road Asset Management Contract | South Coast Region

Ventia Boral Amey Joint Venture

VBA Stapylton Depot | Lot 15 | Eastern Service Road | Stapylton | QLD | 4207

PO Box 701 | Beenleigh | QLD | 4207

p: Not relevant **m:** Not relevant **e:** Not relevant @vbajv.com.au

team email: QLDenquiries@vbajv.com.au **team phone:** +617 3297 3150

Safety before Production

 Please consider the environment before printing this e-mail



Disclaimer

IMPORTANT – This email, and any attachments transmitted with it, may be confidential and privileged. If you are not the intended recipient, you are hereby notified that any dissemination, use or disclosure of this email and any attachments transmitted with it may cause commercial damage to both/either the sender and/or the intended recipient and is strictly prohibited. If you have received this email in error, please contact the sender by return email, do not use or disclose the contents and delete the message and any attachments from your system. Before opening or using attachments, check them for viruses and defects. The Company's liability is limited to resupplying any affected attachments. Information regarding privacy can be accessed here: http://ventia.com/ckeditor_assets/attachments/39/ventia-privacy-statement.pdf



Queensland
Worksite Diary / Time Sheet
Operations 118.2 AU

912768
356468

Customer: *VPA* Date: *21 / 9 / 18*
Location: *Boonah / Koolahany Rd* Job ID: *356468*
Traffic Management Checklist: *110/68*

ID	Name	OPS	Use Range	Km's To Site	Shift Start	Start Break	Finish Break	Shift Finish	Total Hours	Km's from Site
	<i>[Redacted]</i>	D	<i>WPA</i>	72	06:00	13:30	14:00	15:30		72
	<i>[Redacted]</i>	P	<i>ZUS PX</i>	72	06:00	13:00	13:30	15:30		72
	<i>[Redacted]</i>	S		55	06:00	12:30	13:00	15:30		55
	<i>[Redacted]</i>	S		12	06:00	18:00	18:30	15:30		11

WORKSITE DIARY

Time Signs Out: *07:15* Time Signs In: _____
Times Checked: _____

Scope of Works:
*cleaning of already done
pools ready for spraying
from Chornag - to*

Fatigue Breaks:

SIGNAGE RECORD (Must Map)

Diagram 2 multiple sites

Diagram symbols:

TAPER LENGTH: _____

MUTCD DIAG: _____
TCP No: _____

Representative: *[Redacted]* Date: *21.9.18*
Representative: *[Redacted]* Signature: *[Redacted]*





MAROON DAM RD



Aftercare Setup

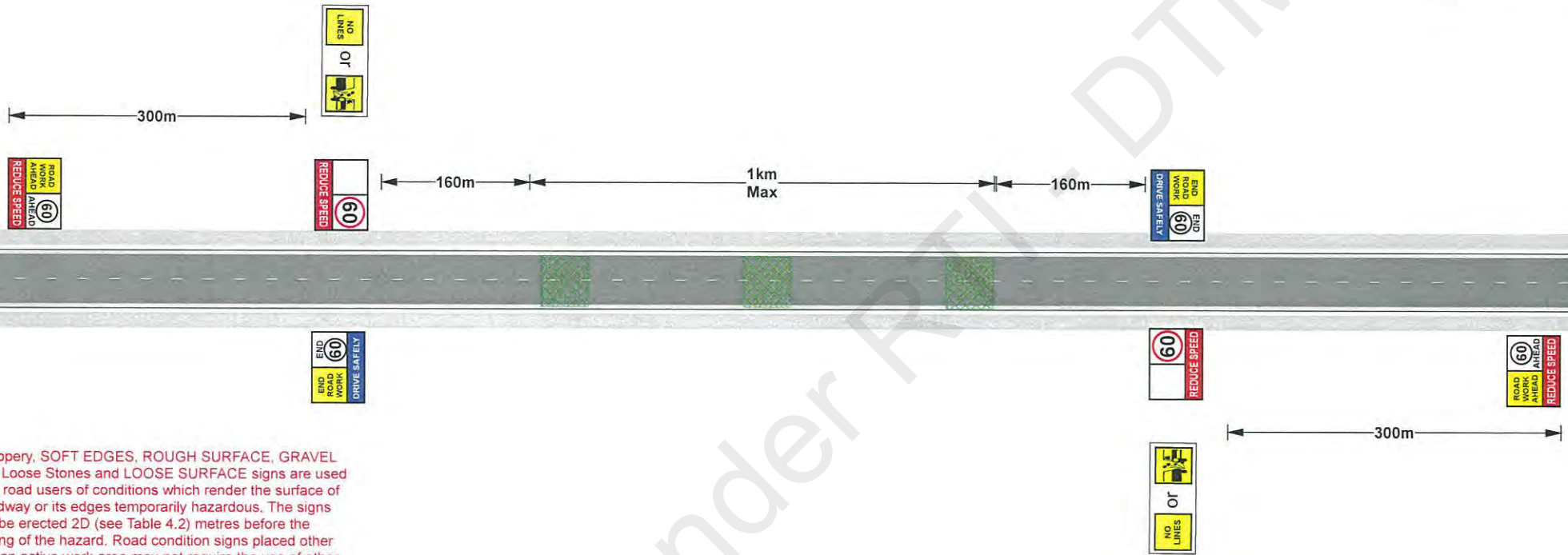

Legend	
	Work Area



The Slippery, SOFT EDGES, ROUGH SURFACE, GRAVEL ROAD, Loose Stones and LOOSE SURFACE signs are used to warn road users of conditions which render the surface of the roadway or its edges temporarily hazardous. The signs should be erected 2D (see Table 4.2) metres before the beginning of the hazard. Road condition signs placed other than at an active work area may not require the use of other advance warning signs in conjunction, provided that the normal traffic lanes are not obstructed. If the hazardous conditions extend over a considerable length the signs may need to be repeated at regular intervals of not more than 500 m. Advisory Speed signs (T3-16) (see Clause 3.7.3) may be required in conjunction with these signs.

The Slippery sign (T3-3) may be used to warn of a slippery condition caused by water, ice or loose material on the road surface. In the latter case, the sign LOOSE SURFACE (T3-14) may be used as an alternative to the Slippery sign. The Loose Stones sign (T3-9) is used for any situation where flying stones may be a hazard. It may also be used to protect the road surface against excessive loss of aggregate and to warn of the possibility of flying stones where fresh bituminous surfacing work has been carried out. Refer to Clause 4.9.3 for speed zones for traffic safety purposes particularly where loose material or stones are present on the road surface or for new sprayed seal works where higher speeds may damage the new seal.

AFTERCARE OPTIONS
Signs must be positioned 2D - 30 m apart and before the works

	The Loose Stones sign (T3-9) is used for any situation where flying stones may be a hazard.
	Loose Surface sign (T3-14) may be used to warn of a slippery condition caused by loose material on the road surface.
	These signs are used in advance of locations where pavement markings normally required for driver guidance have been removed or have not been placed on new surfacing work.

SCOPE OF WORKS

- This TGS will be setup for after care when works have ceased.
- Signage chosen must reflect the road conditions at the time.
- Aftercare signage must be positioned 2D before the works 160m - 200m
- If site exceeds 500m signage must be repeated.

GET DIRECTED
TRAFFIC CONTROL
1800 828 723

PROJECT: Boonah Rathdowney Rd Patch Seal	Design Date: 4/5/18
Address: Boonah Rathdowney Rd Rathdowney	Direction: All
Client: SAT Civil Construction Pty Ltd	Posted Speed: 100 km/h
Onsite Contact: Not relevant	Min Lane Width: 3 m
Mobile No.: Not relevant	Scale: NTS
MUTCD REF/DIA : Frequently Changing Work Area	Road Type: 2 Way Open Road
TMR Registration: 0124	Control: Yes
Disclaimer: Disclaimer: This plan has been prepared as a guide for Traffic Management purposes. Get Directed Traffic Control disclaims all responsibility and all liability for all expenses, losses, damages and costs you might incur as a result of the information being inaccurate or incomplete in anyway, and for any reason.	Volume / VPD: NA
	Page: 1 of 1

TRAFFIC GUIDANCE SCHEME DESIGNER APPROVAL	
TGS No.: TGSSAT - 000	VERSION: 1
Author NAME: Not relevant	SIGNATURE: Not relevant
TMD DESIGNER Not relevant	TMD Number Not relevant
SIGNATURE: N/R	DATE: 31/5/18